

**PLAN** FOOTPATH: W = 1200mm  
CYCLEWAY: W = 2500mm - 3000mm

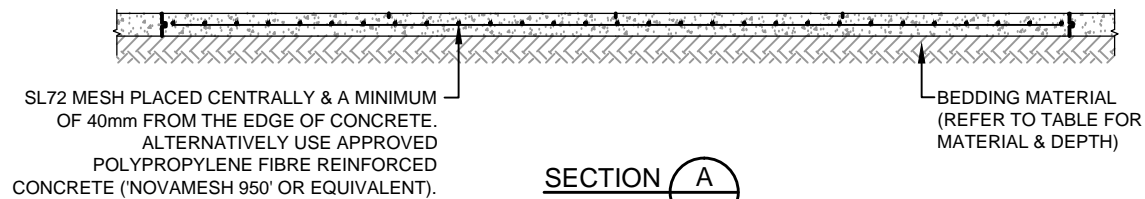

**SECTION A**  
**TYPICAL FOOTPATH / CYCLEWAY**  
SCALE 1:50 (A3)

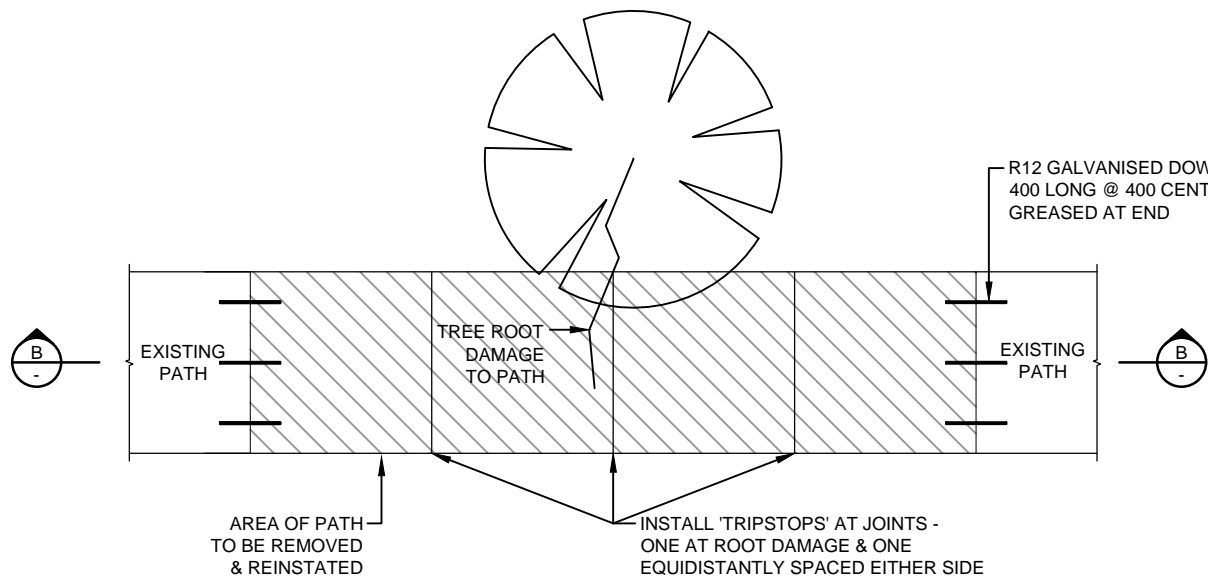

**PLAN**

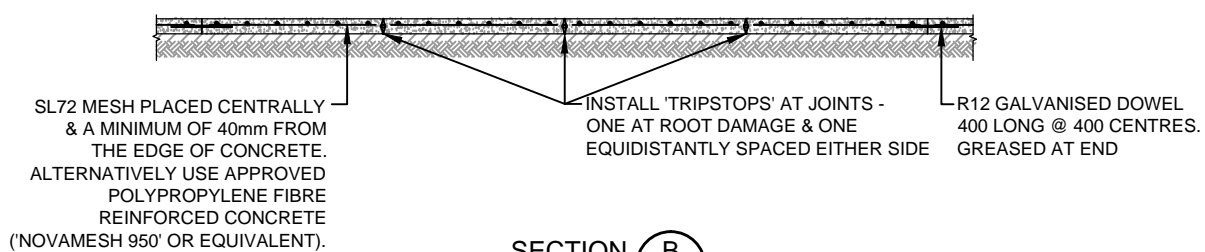

**SECTION B**  
**TYPICAL FOOTPATH / CYCLEWAY REPAIR DETAILS**  
SCALE 1:50 (A3)

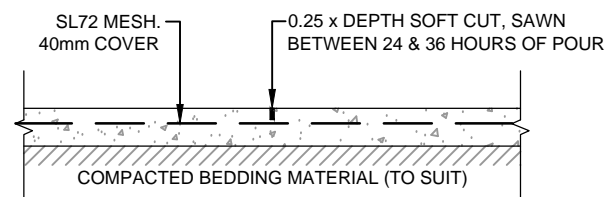

**SAW JOINT (S.J.) - JOINT TYPE ①**

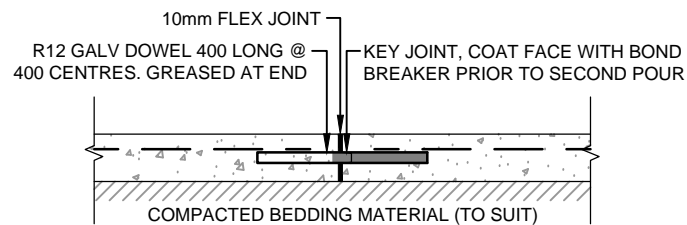

**EXPANSION KEY JOINT (K.J.) - JOINT TYPE ②**

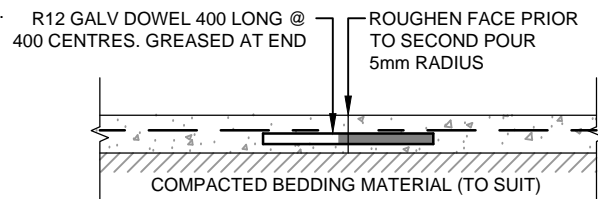

**DOWELLED CONSTRUCTION JOINT (C.J.) (REFER NOTE No.3)**

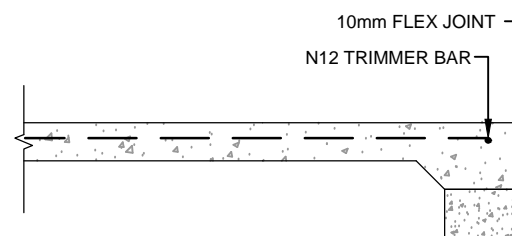

**ISOLATION JOINT (I.J.)**

**TYPICAL JOINTING DETAILS**  
SCALE 1:20 (A3)

**NOTES:**

- JOINT TYPE ① SAW CUT JOINT TO 0.25 x DEPTH, MADE BETWEEN 24 & 36 HOURS OF THE POUR.
- JOINT TYPE ② APPROVED PRE-FORMED EXPANSION KEY JOINT (e.g. CONNOLLY JOINT). ALSO PROVIDE AT ALL GREENPOUR JUNCTIONS/JOINTS.
- USE DOWELLED EXPANSION JOINT OR OTHER APPROVED STRUCTURAL JOINT INSTEAD OF JOINT TYPE ② IN LOCATIONS WHERE DIFFERENTIAL MOVEMENT IS LIKELY (e.g. ADJACENT TO STREET TREES)
- ALL EXPOSED EDGES TO BE ROUNDED TO 20mm RADIUS.
- CONCRETE GRADE TO BE N25 TO AS1379 & AS3600.
- PREFERRED SURFACE OF FOOTPATH/CYCLEWAY SHALL BE BROOM FINISHED. ALTERNATIVE FINISHES MAY BE CONSIDERED ON THEIR MERIT IN ACCORDANCE WITH DEVELOPMENT DESIGN SPECIFICATIONS D1 & D9. ALL FINISHES MUST COMPLY WITH AS/NZ54586 FOR SLIP RESISTANCE.
- WHERE ABUTTING THE KERB THE SURFACE OF FOOTPATH/CYCLEWAY IS TO BE FINISHED FLUSH WITH THE TOP OF THE KERB & WITH FOAM JOINTING SEPARATING THE KERB FROM THE FOOTPATH/CYCLEWAY.
- TOP OF TURF TO FINISH FLUSH WITH FOOTPATH/CYCLEWAY.
- SUB-GRADE MATERIAL SHALL BE COMPACTED TO PROVIDE A MINIMUM RELATIVE COMPACTION AS DETERMINED BY AS1289.5.4.1 OF 95% FOR STANDARD COMPACTION EFFORT.
- THE SUBGRADE SURFACE SHALL BE CHECKED BY THE SUPERINTENDENT FOR UNIFORMITY, LINE & LEVEL, AND ALL IRREGULARITIES SHALL BE MADE GOOD.
- SERVICE TRENCHES - SAW CUT & REMOVE WHOLE PANEL BETWEEN ADJACENT JOINTS. REINSTATE WITH DOWELLED CONSTRUCTION JOINTS BOTH SIDES. WHERE THE WIDTH OF THE REMAINING PATH IS LESS THAN 1200mm THE ENTIRE CONCRETE AREA IS TO BE REMOVED & REPLACED FOLLOWING THE INSTALLATION OF THE SERVICE.
- FOOTPATHS AND CYCLEWAYS TO HAVE A CROSSFALL RANGING BETWEEN 2.50% MAXIMUM & 1.00% (MINIMUM).
- HANDRAILS ARE TO BE PROVIDED WHERE LONGITUDINAL GRADES EXCEED 12%. E
- WHERE THERE ARE WIDENINGS OF EXISTING FOOTPATHS/CYCLEWAYS THEY ARE TO BE TIED TO THE EXISTING CONCRETE USING Ø12 REINFORCING BAR 400 LONG (200 INTO EACH SIDE) AT 400 CENTRES. THE EXISTING TOOLED ROUNDED EDGE IS TO BE SAW CUT & REMOVED RESULTING IN A FLUSH JOINT ACROSS THE TWO CONCRETE SURFACES.
- ANY VARIATION TO THESE STANDARDS REQUIRES WRITTEN APPROVAL FROM TWEED SHIRE COUNCIL.

**FOOTPATH & CYCLEWAY PAVEMENT DETAILS**

DESCRIPTION	WIDTH (W) mm	DEPTH (D) mm	BEDDING (B) mm	REINFORCEMENT
FOOTPATH	1200	100	50 COMPACTED CRUSHER DUST	SL72
CYCLEWAY	2500 - 3000	100	50 COMPACTED CRUSHER DUST	SL72
CYCLEWAY (INCORPORATING VEHICLE ACCESS)	2500 - 3000	150	50 COMPACTED CRUSHER DUST	SL72

E	NOTE 12 AMENDED	G.P.C.	08.2013
D	JOINTING DETAILS & REPAIR DETAILS ADDED & NOTES UPDATED	G.P.C.	07.2013
C	NOTES 1 & 2 & REINFORCEMENT NOTE AMENDED	G.P.C.	06.2010
B	DRAWING ADOPTED FOR ISSUE TO PUBLIC	R.A.E.	05.2004
A	ORIGINAL ISSUE	R.A.E.	04.2004
ISSUE	AMENDMENT DETAILS	INITIALS	DATE



**DESIGN UNIT**

COUNCIL OFFICES  
TUMBULGUM ROAD,  
MURWILLUMBAH,  
NEW SOUTH WALES 2484

PHONE 02 6670 2400  
FAX 02 6672 7513  
WEBSITE www.tweed.nsw.gov.au

DESIGNER	<i>W. Boyd</i>	DATE 05.2004
DESIGN MANAGER	<i>D. King</i>	DATE 05.2004
DRAWN	ENGINEERING & OPERATIONS DESIGN UNIT	
SCALE	AS SHOWN	

PROJECT:	ROAD WORKS STANDARDS	DRAWING NUMBER:	S.D.013
PLAN TITLE:	FOOTPATH & CYCLEWAY DETAILS		AUG 2013