

Linda Cooper

From: Steven Deal <Steven.Deal@lpi.nsw.gov.au>
Sent: Tuesday, 8 March 2016 12:47 PM
To: Vanessa Gwynne
Subject: RE: 179 Clothiers Creek Road

Hi Vanessa,

All addresses are currently addressed to Clothiers Creek Road, Nunderi (both in LPI's addressing database and Valnet). There are no properties in Valnet that are addressed to Boyd St, Nunderi.

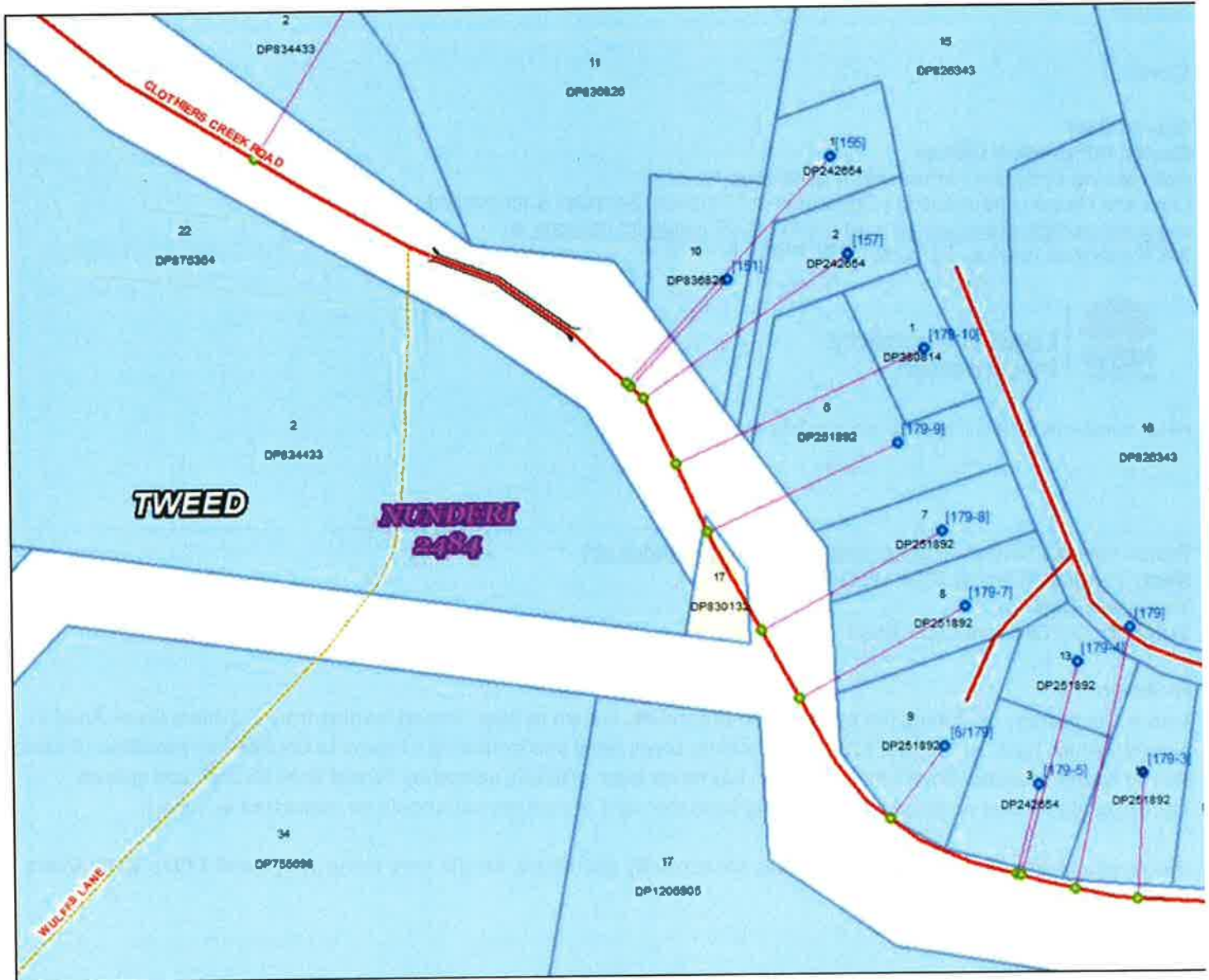

| Property | District | Address |
|----------|-------------|--|
| 1809719 | 171 - TWEED | 179-9 CLOTHIERS CREEK RD, NUNDERI NSW 2484 |
| 1809720 | 171 - TWEED | 179-8 CLOTHIERS CREEK RD, NUNDERI NSW 2484 |
| 1809721 | 171 - TWEED | 179-7 CLOTHIERS CREEK RD, NUNDERI NSW 2484 |
| 1809722 | 171 - TWEED | 5 / 179 CLOTHIERS CREEK RD, NUNDERI NSW 2484 |
| 1809723 | 171 - TWEED | 179-5 CLOTHIERS CREEK RD, NUNDERI NSW 2484 |
| 1809724 | 171 - TWEED | 179-3 CLOTHIERS CREEK RD, NUNDERI NSW 2484 |
| 1809725 | 171 - TWEED | 179-2 CLOTHIERS CREEK RD, NUNDERI NSW 2484 |
| 1809726 | 171 - TWEED | 179-1 CLOTHIERS CREEK RD, NUNDERI NSW 2484 |
| 1809727 | 171 - TWEED | 179-4 CLOTHIERS CREEK RD, NUNDERI NSW 2484 |
| 1809728 | 171 - TWEED | 179-10 CLOTHIERS CREEK RD, NUNDERI NSW 2484 |
| 1809729 | 171 - TWEED | 179 CLOTHIERS CREEK RD, NUNDERI NSW 2484 |

Thanks

Steven

Steven Deal

Spatial Information Officer

Addressing Program | Information Sourcing

Land and Property Information | Department of Finance, Services & Innovation

e: steven.deal@lpi.nsw.gov.au p: (02) 6332 8049 | www.lpi.nsw.gov.au

346 Panorama Avenue, Bathurst NSW 2795



**Land & Property
Information**

Please consider the environment before printing this email

From: Vanessa Gwynne [<mailto:vgwynne@tweed.nsw.gov.au>]

Sent: Tuesday, 8 March 2016 12:41 PM

To: Steven Deal

Subject: 179 Clothiers Creek Road

Hi Steven

I am in the process of naming the private road (informally known as Boyd Street) leading from Clothiers Creek Road at Nunderi which leads to 179 and 179/1-10 Clothiers Creek Road and preparing a report to Council for resolution of same. As you would be aware Boyd Street, Nunderi has never been officially named by Tweed Shire Council and as such Council confirms that no properties accessing from the right of carriageway should be addressed as such.

Would you please confirm that all addresses are correctly addressed, for the time being as 179 and 179/1-10 Clothiers Creek Road, Nunderi.

Many thanks

Vanessa Gwynne | Conveyancer/Property Officer



p (02) 6670 2769 | f (02) 6670 2429 | e vgwynne@tweed.nsw.gov.au | w www.tweed.nsw.gov.au
Civic and Cultural Centre Tumbulgum Road Murwillumbah NSW 2484 | PO Box 816 Murwillumbah NSW 2484

Customer Service: (02) 6670 2400 or 1300 292 872 ABN: 90 178 732 496

Our values: transparency | customer focus | fairness | reliability | progressiveness | value for money | collaboration

Please consider the environment before printing this email. One tonne of paper is equivalent to 13 trees and 30 kL of water

All official correspondence requiring a formal written response should be addressed to the General Manager, PO Box 816, Murwillumbah, 2484; or emailed to tsc@tweed.nsw.gov.au; or faxed to 02 6670 2429.

This email (including any attachments) is confidential and must only be used by the intended recipient(s) for the purpose(s) for which it has been sent. It may also be legally privileged and/or subject to copyright.

If you are not an intended recipient, any disclosure, distribution, copying or use of or reliance on this email (or any attachment) is strictly prohibited. If you have received this email in error, please promptly notify the sender by return email and then delete all copies of this email (and any attachments).

If you forward or otherwise distribute this email (or any attachment) you may be personally liable for a breach of confidentiality, an infringement of copyright, defamation or other legal liability.

Any opinions, views or conclusions expressed in this email (or any attachment) are those of the individual sender and may not necessarily reflect the official position of the Council.

This e-mail may contain an e-Letter attachment. A digital message is deemed to have been delivered, opened, viewed, presented and provisioned to a customer when the digital message is accessible by the customer to whom it was sent. If an original hard copy of the message is required, please reply to this message requesting a hard copy.

www.tweed.nsw.gov.au

This email has been scanned by the MessageLabs Email Security System
