

*Tweed Shire Council wishes to recognise the generations of the local Aboriginal people of the Bundjalung Nation who have lived in and derived their physical and spiritual needs from the forests, rivers, lakes and streams of this beautiful valley over many thousands of years as the traditional owners and custodians of these lands.*



**Council will put safety first in deciding when community facilities open, such as the Tweed Regional Gallery and Margaret Olley Art Centre.**  
(Photo is pre-pandemic.)

## We're working to reopen facilities safely

**Tweed Shire Council welcomes the NSW Government's announcements on the relaxation of restrictions for some community facilities. These include outdoor pools, libraries, museums and galleries.**

This follows the successful recent reopening of skate parks, playgrounds, public barbecues, outdoor exercise equipment and beach carparks in the Tweed.

At the same time, the government has emphasised that the reopening of facilities should ensure that Public Health Order requirements are adhered to, including physical spacing and taking care with vulnerable people. Health and hygiene standards are also important.

Council is now putting in place the measures needed to ensure a safe reopening of these community facilities and will announce opening dates as soon as possible. These measures include booking systems, cleaning regimes, physical distancing requirements and other operational issues.

Acting Director Sustainable Communities and Environment Stewart Brawley said there were a number of operational and health requirements which may delay the opening of some of these facilities.

"The community will appreciate that re-opening will be more complex than closing these facilities," Mr Brawley said.

"Council put safety first and led with the closure of our facilities and we will continue to be guided by safety when we reopen. We need to protect our community, especially elderly and vulnerable residents.

"The community can be assured that Council is working to ensure all facilities are safe and viable for our customers when they can return and we look forward to welcoming them back.

"Safety is our priority and a number of our visitors, staff and volunteers are vulnerable, so we are putting measures in place to keep them as safe as possible.

"In regards to pools, only the Kingscliff pool can be opened to the general public under the current restrictions. We are looking at the Murwillumbah facility being used for squad training only as an exemption has been granted under the Public Health Orders. However, we need more time to make assessments on the best way to safely reopen for our customers," he said.

Council is also working towards the safe reopening of customer service centres at Murwillumbah and Tweed Heads and will keep the community updated once an opening date is determined.

In the meantime, follow [Tweed Shire Council](#), [Tweed Regional Gallery](#), [Tweed Regional Museum](#), [TRAC](#) and the [Richmond-Tweed Regional Library](#) on Facebook and sign up to receive the latest news through our range of [newsletters](#) and [alerts](#).

To keep up to date with the latest status of Council facilities and government health and restrictions information, visit [emergency.tweed.nsw.gov.au/coronavirus](http://emergency.tweed.nsw.gov.au/coronavirus)



## In this together for National Reconciliation Week

**National Reconciliation Week is from 27 May to 3 June and the theme for 2020 is 'in this together'.**

It's a time for all Australians to learn about Aboriginal history, culture, and achievements, and to explore how everyone can contribute to achieving reconciliation in Australia.

Building on over 20 years of relationships through the Aboriginal Advisory Committee, Tweed Shire Council's first *Reconciliation Action Plan 2018-2020* (RAP) was launched in 2018 and outlines Council's commitment to reconciliation.



**Council staff attend a Banaam Cultural Intelligence Workshop to increase understanding of Indigenous culture.**

Two years on, and to coincide with National Reconciliation Week, it's an opportunity to reflect on some of the achievements that Council and its staff are proud of.

Alongside the deepening historical and present day understanding for staff and the relationships which have been strengthened, some of the other achievements over the past two years include:

- More than 100 staff attended the Banaam Cultural Intelligence Workshop to increase understanding and appreciation of Aboriginal and Torres Strait Island cultures, histories and achievements.
- A 'bring a friend' initiative was introduced for NAIDOC week celebrations, where Indigenous staff could bring along a non-Indigenous staff member to participate in the cultural celebrations.
- Inclusion of Aboriginal acknowledgment at all events and Council meetings and 'Welcome to country' at major events.
- Council has over 60 Indigenous businesses registered to do business with Council and engaged over 20 Indigenous businesses in 2019/20.
- Aboriginal cultural heritage induction training has been developed and will be rolled out for all outdoor staff.
- Incorporation of a public artwork by local Aboriginal artist Christine Slabb as part of the redevelopment of the Tweed Heads Civic and Cultural Centre.

The RAP Working Group is looking at next steps for Council to continue along the reconciliation journey, including drafting a revised set of RAP actions and renewal of the RAP Working Group with new members.

To view the *Reconciliation Action Plan 2018-2020*, visit [www.tweed.nsw.gov.au/atsi](http://www.tweed.nsw.gov.au/atsi)



Last week we each used  
**196L a day**  
as at 22 May 2020

## Youth in isolation

**Students are back in school this week and we caught up with a member of Tweed Shire's Youth Council, Montana Markland of Banora Point to find out her experiences during the pandemic.**

She's sharing this story as part of Council's Together Tweed initiative. "Life has changed pretty dramatically since March. It's hard to believe last term was actually last term and not years ago.

At first, it was like looking at life through binoculars, or reading it in a story – it wasn't actually real to my brain. Then, things changed even more, and suddenly I wasn't at school anymore, and I was resolved to living in the moment, trying not to get caught up in the news of the world.

Online schooling was really different to real school obviously, but there was a lot of freedom in it. But in saying that, it also became a bit tedious and of course there were no social aspects to it.

While the world kept and keeps changing around us, I think it is important to keep hope. In the past few months, even in the midst of a crisis, I have seen extraordinary acts of kindness among people in our community, crisis has turned our community into more of exactly that, a community."

Montana is also planning to film a short video about the transition back to school, which she plans to show at the next Youth Council meeting.

The students have missed one meeting this year due to the COVID-19 restrictions but plans are afoot to hold a virtual meeting in June.

The Youth Council is a student leadership and civic program which will involve young people in local government decision-making, to build a resilient youth population and provide opportunities for young people to reach their full potential.

Find out more about young people in the Tweed at [www.tweed.nsw.gov.au/youngpeople](http://www.tweed.nsw.gov.au/youngpeople)

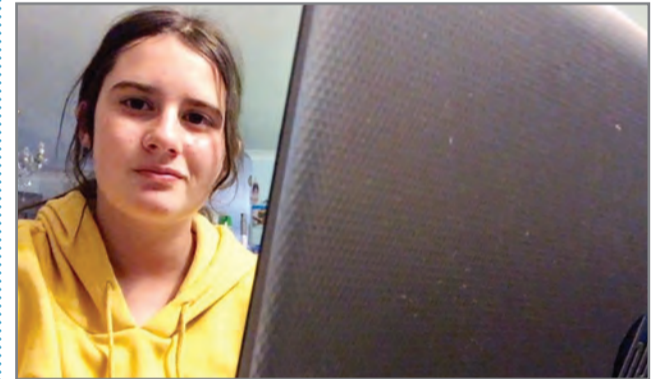

**High school student and Youth Council member Montana Markland reflects on her online schooling journey during the pandemic.**

## #TheTweed puzzle time

**A series of dreamy Tweed holiday digital jigsaw puzzles has been released online to help entertain us at home and inspire local travel to our stunning region.**

The Tweed Tourism Company has released the series online at [visitthetweed.com.au/puzzles](http://visitthetweed.com.au/puzzles)

More Tweed scene puzzles in the 'Dream Now, Visit Later' series will be released over the coming weeks.

Tweed Tourism's latest puzzle is now online and you can piece together some history in Main Street, Murwillumbah, supplied by Tweed Regional Museum's online collection of more than 50,000 photographs.

The beautiful streetscapes of Murwillumbah have always been famous for the art deco architecture and this artistic town and its café vibes are an awesome place to visit when we start travelling again.

The innovative digital jigsaw series, which also features the much-loved Tweed Regional Gallery & Margaret Olley Art Centre, is the latest element of the Tweed Tourism Company's #LoveTheTweed initiative that connects locals and Tweed-lovers alike to more than 80 local business offerings.

Check out #LoveTheTweed at [visitthetweed.com.au/lovethetweed](http://visitthetweed.com.au/lovethetweed)



**Historic Murwillumbah features in the latest digital jigsaw puzzle available for free online.**

# A naturally beautiful farewell



## Did you know that Tweed Valley Cemetery offers an outdoor option to celebrate the life of a loved one?

Affectionately known as 'Stumpy' this ancient tree stump overlooks our duck pond and glorious gardens. Topped with granite, the coffin sits in a calm and uniquely Australian environment.

To discuss options to honour the life of your loved one phone (02) 6670 2435 or visit [www.tweed.nsw.gov.au/cemeteries](http://www.tweed.nsw.gov.au/cemeteries)

### Resident and Ratepayer Association meetings

**Banora Point & District Residents Assoc.** meetings have been cancelled until further notice.

**Chinderah Districts Residents Association Inc.** meetings have been cancelled until further notice.

**Kingscliff Ratepayers and Progress Association** meetings have been cancelled until further notice.

### Proposed classification of land

In pursuance of section 34 of the *Local Government Act 1993*, Council proposes to classify Lot 603 DP 1243648x and proposed Lot 718 in the subdivision of Lot 628 DP 1243648 at Murwillumbah as Operational Land.

A period of twenty eight days from the date of this notice is allowed for any person to lodge a written submission to the proposed classification. General Manager, Tweed Shire Council, PO Box 816, Murwillumbah 2484.

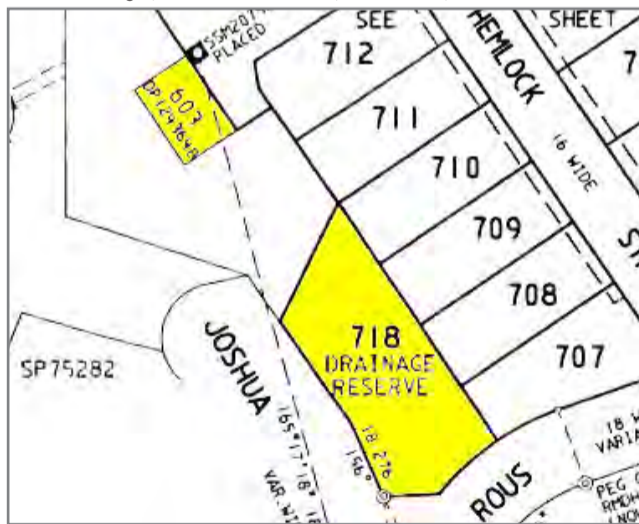

### Current vacancies

View current vacancies at [www.tweed.nsw.gov.au/careers](http://www.tweed.nsw.gov.au/careers)  
Subscribe to receive Job Vacancy Alerts via email at [www.tweed.nsw.gov.au/subscribe](http://www.tweed.nsw.gov.au/subscribe)

**WATER WEEK 9** Check when your water meter is read at [www.tweed.nsw.gov.au/meterreading](http://www.tweed.nsw.gov.au/meterreading)

### Development Application determinations

Notification of Development Application Determinations for the purposes of Section 4.59 of the *Environmental Planning and Assessment Act 1979* (as amended).

#### Application details

##### Approved

**CDC20/0044** – Demolition of existing dwelling and associated structures Lot 122 DP 263367, No. 14 Captains Way, **Banora Point**

**DA20/0257** – In-ground swimming pool and deck Lot 122 DP 263367, No. 14 Captains Way, **Banora Point**

**DA20/0228** – Dwelling with attached garage Lot 8 DP 1252272, No. 28 Denman Drive, **Cudgen**

**DA20/0222** – Use of existing shower and wash basin in farm shed Lot 4 DP 775393, No. 221 Duroby Creek Road, **Duroby**

**DA19/0676** – Use of existing shed and retaining wall Lot 7 DP 631700, No. 7170 Tweed Valley Way, **Fernvale**

**DA20/0150** – In-ground swimming pool, pool hut and 1.8m high front fence Lot 18 Section 8 DP 758571, No. 107 Kingscliff Street, **Kingscliff**

**DA20/0247** – In-ground swimming pool Lot 2 SP 93455, No. 64 Sailfish Way, **Kingscliff**

**DA20/0239** – Patio roof and carport Lot 1020 DP 1101846, No. 31 Newcastle Drive, **Pottsville**

**DA20/0204** – Patio Lot 2 SP 19853, Unit 2/No. 33 Shearwater Parade, **Tweed Heads**

**DA20/0249** – Covered patio Lot 1 SP 15028, Unit 1/No. 12 Tupia Avenue, **Tweed Heads**

**DA20/0220** – Alterations and additions to existing dwelling Lot 45 DP 26713, No. 9 Floral Avenue, **Tweed Heads South**

**DA20/0221** – Alterations and additions to existing dwelling Lot 104 DP 701433, No. 20 Limosa Road, **Tweed Heads West**

**DA20/0209** – Alterations and additions to existing dwelling Lot 5 DP 586487, No. 183 Zara Road, **Zara**

**DA19/0746** – Detached dual occupancy Lot 7 DP 842627, No. 22 Bushland Drive, **Banora Point**

**DA20/0057** – Alterations to an existing residential flat building returning one unit back to original use as two units resulting in a total of 10 units Lot 17 SP 85402, Unit 17/No. 18 Moss Street, **Kingscliff**

**DA20/0005** – Dwelling and attached secondary dwelling Lot 615 DP 1243648, No. 8 Sorrel Court, **Murwillumbah**

**DA19/0397** – Staged proposal comprising multi dwelling housing (4 dwellings), earthworks, tree removal (1), four swimming pools, additional ancillary works and strata subdivision

Lot 2 DP 1085558, Lot 1 DP 923918, No. 5 Razorback Road, **Tweed Heads**

**DA19/0775** – Change of use to a community facility including office and retail space

Lot 21 Section 4 DP 2379, Lot 0 ROAD 4640, No. 56 Recreation Street, **Tweed Heads**

The above development determinations are available for public inspection free of charge at the Planning and Regulation Division, Murwillumbah Civic Centre, during ordinary office hours or viewed on Council's DA Tracking site located at [www.tweed.nsw.gov.au/datracking](http://www.tweed.nsw.gov.au/datracking)

### Request for offer

**RF02020055 Supply and Install 6 x Bus Shelters**

**RF02020056 Road Safety Audit 3 Locations**

**Offers close:** Wednesday 12 noon 3 June 2020

Offers must be lodged as specified in the offer documentation.

Request For Offer documentation is available at no charge from Council's website at [www.tweed.nsw.gov.au/tenders](http://www.tweed.nsw.gov.au/tenders). Hard copy documentation is available and costs will be in accordance with Council's advertised photocopying fees.

All Offers will be opened at closing time and will be considered by Council in accordance with the provisions of the *Local Government Act 1993* and the *NSW Local Government (General) Regulation 2005*. The lowest or any offer is not necessarily accepted and canvassing of Councillors or staff will disqualify.

For further information please contact Contracts Administration on (02) 6670 2606.

Subscribe to Council's **Community Emergency Update** newsletter at [www.tweed.nsw.gov.au/subscribe](http://www.tweed.nsw.gov.au/subscribe)

1300 292 872 or (02) 6670 2400

[tsc@tweed.nsw.gov.au](mailto:tsc@tweed.nsw.gov.au)

Subscribe to the Tweed Link online at [www.tweed.nsw.gov.au/subscribe](http://www.tweed.nsw.gov.au/subscribe)

PO Box 816, Murwillumbah NSW 2484

[www.tweed.nsw.gov.au](http://www.tweed.nsw.gov.au)

or follow Council on: [f](#) [i](#) [t](#) [v](#) [in](#)

