

## Sandra Zietlow

---

**From:** pandjflynn1@bigpond.com  
**Sent:** Wednesday, 20 August 2014 9:18 PM  
**To:** Corporate Email  
**Subject:** Pottsville Service Lane Two-way Option

53 Newcastle Drive  
Pottsville NSW 2489

20th August, 2014

General Manager  
Tweed Shire Council  
PO Box 816  
Murwillumbah NSW 2484

Dear Sir,

I wish to make a submission on the Pottsville Service Lane two-way option behind the shops on Coronation Avenue.

When I was looking at purchasing a block of land and building a house in Pottsville in 2010 I went to the Tweed Shire Council website and noted some forward planning for a a bypass road for the Pottsville CBD in Coronation Avenue. I thought this was great foresight and encouraged me to come to Pottsville.

I would like to see a two-way service road behind the Coronation Avenue shops. This would eliminate the dangerous accesses to some of the shops in Coronation Avenue.

At the same time I am hoping that the Tweed Shire Council will take the opportunity to build a road that can in the future be part of a bypass for the Pottsville CBD. This means installing kerb and guttering, footpaths, parking and lighting so that when a full bypass road is constructed to the roundabout at the entrance to the Seabreeze estate the service road does not have to be reconstructed.

Berkleys Lane should also be a two-way road with kerb and guttering and the present tree in the middle of the lane should be removed.

Yours faithfully,

Phil Flynn.

## Sandra Zietlow

---

**From:** Ellie Penrose [ellie@grinddatecoffee.com.au]  
**Sent:** Thursday, 21 August 2014 1:18 PM  
**To:** Corporate Email  
**Subject:** The General Manager submission regarding rear Lane Construction off Coronation Ave in Pottsville

To the General Manager,

I am a resident of 2/6 Hassett Drive Pottsville and a business co-owner of shop 6/1 Coronation Ave. I am writing in support for the new two-way proposal for the rear lane construction of Coronation Ave. The revised two-way proposal is positive as it retains the current convenient access to my business for all west bound traffic entering town on Coronation Ave.

I also have a few queries regarding the eastern tennis court/sport field corner.

1. With the proposed works in this location will turf be laid to all disturbed grassed areas?
2. The current pedestrian footpath stops at the newsagents. Will this be extended? There is a garbage bin approximately 10m beyond the end of the current footpath and the grass is all worn away due to the amount of foot traffic. Also the current power pole stay is a potential safety issue as people walk into it or trip over it, a footpath could direct foot traffic away from the stay.

Kind Regards,

Ellie Penrose  
CORNER STOP ESPRESSO BAR  
0422 698 281



St Mark's Anglican Church

Coronation Av, Pottsville NSW 2489

PO Box 1057

Kingscliff, 2487

Phone: (02) 6674 5019

INF 11 - POTTVILLE CBD LANE

TWEED SHIRE COUNCIL	
FILE No:	Sus: 2416 + 339
DOC. No:	.....
RECD:	22 AUG 2014
ASSIGNED TO:	MORGAN P
HAED COPY	<input type="checkbox"/>
IMAGE	<input checked="" type="checkbox"/>

The General Manager,  
Tweed Shire Council  
Via email

Dear Sir / Madam

### Re Modifications to Traffic Flow Berkley's Lane, Pottsville

I emailed the Council on June 21 as a private resident, where I asked a series of questions about what Council had in mind with this change. I received a form letter, saying my "views" would be passed on to the review committee leaving all my questions unanswered.

This time I am writing as Warden of St Mark's Anglican Church, which sits directly on Berkley's Lane. I hope that this time someone from the council will contact me to discuss the issues raised.

Originally it was advertised that the traffic flow change would turn Berkley's Lane into a one-way street. I now believe the plan is to make the traffic flow two way right through to Phillip St.

This change has some direct impact on the Church, which I would like to detail to ensure the council carefully considers the issues.

- The church is contemplating an extension that will mean the only vehicular access to church property will be from Berkley's Lane. The presence of a large tree, and its raised garden bed, currently makes turning from the driveway into the Lane quite difficult for our parishioners. It would appear to us that the tree would also be a danger to the traffic in Berkley's Lane. Therefore, we would request that Council seriously considers removing that tree and its raised bed. It would also be appreciated if the driveway, which crosses council land, could be properly formed and widened to improve access to and from the church property.
- There are approximately half a dozen car spaces at right angles to Berkley's Lane including a disabled parking space. These car spaces are used by the community and also by our parishioners – particularly on Market days. They are partly on church property and partly on council property. What is going to happen to these parking spaces? Would they be converted to parallel parking, angled parking, or just removed? The disabled spot is directly opposite the wheelchair ramp into the church building. This combination makes it easier for people with physical disability to access the church for services, weddings and funerals. It is our view that at least one disabled spot must be preserved as disabled access from the rear of the church is not viable.
- It would be appreciated if we could be invited to participate in some planning discussion about how the church frontage would be included into the general landscaping upgrade of the lane once a proper kerbside was developed.

I look forward to discussing these issues with a council representative in the near future.

My phone number is 0412 328 347.

Yours faithfully

David Lucas

**Church Warden.**

Sharing God's love in our community through Worship, Discipleship and Mission

## ANGLICAN PARISH OF KINGSCLIFF

*Serving the Centres of Kingscliff, Pottsville, Burringbar and the wider Tweed Coast*

**Sharing God's Love in our Community through Worship, Discipleship and Mission**

The General Manager  
Tweed Shire Council  
PO Box 816  
Murwillumbah 2484  
Via email: [tsc@tweed.nsw.gov.au](mailto:tsc@tweed.nsw.gov.au)

23 August 2014op

Dear Sir/Madam

### **Re: Modifications of Two-way Traffic Flow in Berkleys Lane, Pottsville**

I am writing to you on behalf of the Parish Council of The Anglican Parish of Kingscliff regarding the modifications to traffic flow in Pottsville which will seriously impact the access to St Mark's Church on the corner of Berkleys Lane and Coronation Avenue.

A meeting of Parish Council was held at St Mark's on 20<sup>th</sup> August, immediately following TSC's 'drop in' meeting in Elizabeth Street Pottsville to which members of the public were invited. The 'drop in' meeting was attended by our Church Warden David Lucas and other members of our parish.

Mr Lucas emailed TSC on 21 June seeking clarification and making certain comments on the effects the modifications would have to St Mark's Church and its members but received no response. Again Mr Lucas emailed a letter to TSC prior to the 'drop in' meeting with a view to discussing the issues with a council representative but again no response was received.

Parish Council discussed the implications of the changes in Berkleys Lane and the serious effects it will have to St Mark's access and make the following requests and recommendations.

1. We are progressing with plans to upgrade and extend St Mark's church and these alterations will mean the only vehicle access to church grounds will be via Berkley's Lane. Mr Lucas reported to Parish Council that TSC intend to keep the fig tree and raised bed which already makes access to church grounds difficult and will cause greater danger to both our parishioners and the general public when Berkleys Lane is a main thoroughfare. We urgently request that Tweed Shire Council seriously consider removal of the fig tree and raised bed to eliminate the danger it would cause if left in situ. We would not be opposed to the planting of a replacement tree nearer to our property if it is felt necessary.
2. At present there are about six parking spaces, including a disabled, on Berkleys Lane at right angles to St Mark's Church (part on our property and part on TSC property). These are used by the general public and our parishioners and access to St Mark's church for disabled people is by the Coronation Street entrance only which has a ramp – there is no disabled access at the rear. This disabled parking space is essential for disabled access St Mark's Church for services, weddings, funerals and meetings. We request that these car parks be retained in addition to the planned three new parallel parking spaces.

APOK Parish Council request that Tweed Shire Council give careful consideration to the above recommendations before final planning of the modifications takes place and before the changes are implemented. St Mark's Church Warden, David Lucas, would welcome a meeting with a council representative to discuss these proposals (his phone number is 0412 328 347).

Yours faithfully

**Carole Cullen**  
Parish Council Secretary  
On behalf of the Anglican Parish of Kingscliff

St James Anglican Church  
123 Marine Parade  
PO Box 1056 Kingscliff NSW 2487

Office Phone: 07 5641 5298  
02 6674 5019  
Email: [office@apok.org.au](mailto:office@apok.org.au)  
Website: [www.apok.org.au](http://www.apok.org.au)

## Sandra Zietlow

---

**From:** Troy Green  
**Sent:** Tuesday, 26 August 2014 8:15 AM  
**To:** Corporate Email  
**Cc:** matt\_dea@yahoo.com  
**Subject:** FW: LEAVE BERKLEY'S LANE ALONE!

Records - Matt has inadvertently sent his submission on Berkley's Lane to me as opposed to the corporate email address. To ensure it is considered by Council, could you please register and task to Paul who is compiling the report with submissions.

Thanks

Troy

---

**Troy Green** | General Manager  
Executive



p (02) 6670 2412 | f (02) 6670 2483 | e [tgreen@tweed.nsw.gov.au](mailto:tgreen@tweed.nsw.gov.au) | w [www.tweed.nsw.gov.au](http://www.tweed.nsw.gov.au)  
Civic and Cultural Centre Tumbulgum Road Murwillumbah NSW 2484 | PO Box 816 Murwillumbah NSW 2484

Customer Service: (02) 6670 2400 or 1300 292 872 ABN: 90 178 732 496

Our values: transparency | customer focus | fairness | reliability | progressiveness | value for money | collaboration  
Please consider the environment before printing this email. One tonne of paper is equivalent to 13 trees and 30 kL of water

---

---

**From:** matt dea [mailto: ]  
**Sent:** Tuesday, 26 August 2014 7:37 AM  
**To:** Troy Green  
**Subject:** LEAVE BERKLEY'S LANE ALONE!

I object to Berkleys Lane in Pottsville being connected up to a Service Lane that is going behind the CBD.... It will turn the quiet dead end lane way into a main rd overnight.I also object to the removal of the very old figtree in the laneway being removed.I would appreciate your support regarding these issues.

## Sandra Zietlow

---

**From:** Noor [noor.abduljabbar@yahoo.com]  
**Sent:** Wednesday, 27 August 2014 12:11 AM  
**To:** Corporate Email  
**Subject:** Tweed Heads Council

To Council Tweed Heads. I am a concerned mother and I do not want the safety and peaceful living for the residents in BerkleyLane Pottsville to be changed by ruining it with a road to go around the back of the shops. Why not leave the lovely lane as it now is and has been for many many years. Use the other end of the shops to come and go like for the past many years it has been getting used. Please keep the Old residents safe.

In this beautiful country I've learned to take the individual needs in consideration and listen to them.

Thanks in advance.

Noor Abduljabbar  
0410976287

**Sandra Zietlow**

---

**From:** gloranddaz@bigpond.com  
**Sent:** Wednesday, 27 August 2014 6:05 PM  
**To:** Corporate Email  
**Subject:** Berkleys Lane.

To whom it may concern,

Good day to you, It has been brought to my attention that Berkleys lane way will be made into a service road and the beautiful old fig tree will be destroyed.

This is very distressing as this is one of the most beautiful lanes in the area.

It should not be used for a major service road. Surely there must be another alternative where the loss will be a lot less minimal to the residents and local beauty.

Please reconcider  
Thank you  
Gloreen Andersen



**FREE Animations for your email** [Click Here!](#)

## Sandra Zietlow

---

**From:** donna black [oydonnawanna@hotmail.com]  
**Sent:** Thursday, 28 August 2014 11:19 AM  
**To:** Corporate Email; Troy Green; Gary Bagnall; Michael Armstrong; Councilor Katie Milne; Barry Longland; Carolyn Byrne; Phil Youngblutt; Warren Polglase  
**Subject:** Berkleys lane

Good morning... Please if any emails come directly to your email address could you redirect them to the person appropriate... Also if you have already deleted any could you let it be known if the emails were in favour or against Berkleys lane being developed... Thanks

Sent from my iPhone



**Sandra Zietlow**

---

**From:** Ron [lettingitallgonow@gmail.com]  
**Sent:** Thursday, 28 August 2014 11:34 AM  
**To:** Corporate Email  
**Subject:** Laneway access next to IGA pottsville

I am writing to object to any changes made to the laneway next to IGA in Pottsville. This is a quiet dead end residential area and should remain that way Thanks Ron

Sent from my Huawei Mobile

Feedback form  
Pottsville service lane two-way option



Berkeley's Lane is safe the way it is. The traffic flows freely and the pedestrians are safe to cross. Changing the thoroughfare will cause havoc to both pedestrians and the traffic. It won't take the traffic off Coronation Ave. Closing the IGA driveway will do this... and leave the elegant fig tree alone, and no more parking spaces in town. Christina Congreest 23/8/14  
0449931118.

50: 2416.339  
TWEED SHIRE COUNCIL  
FILE No: 1561-2116-830  
DOC. No: .....  
RECD: 28 AUG 2014  
ASSIGNED TO: MORGAN, P  
HARD COPY  IMAGE

# Feedback form

## Pottsville service lane two-way option



At its meeting on 17 July 2014, Council resolved to undertake additional community consultation about the construction of a rear lane off Coronation Avenue, Pottsville, this time with two-way traffic flow.

(In June 2014, Council exhibited and sought public comment on the formation of a rear lane and a proposal to change the traffic flow in Berkleys Lane, the unnamed lane and eastern sports field car park to one-way.)

The proposed works will include the construction of an additional three (3) parallel car parks to the western side of Berkleys Lane, while ensuring an appropriate green buffer to the adjoining residence and adequate vehicle turning paths. It includes the retention of the fig tree in Berkleys Lane.

Your feedback on this form would be appreciated and will be considered as a formal submission. The closing date for submissions has been extended to Thursday 28 June 2014.

You can either submit your comments at this information session or send your submission by the closing date to: General Manager, Tweed Shire Council, PO Box 816, Murwillumbah NSW 2484 or email [tsc@tweed.nsw.gov.au](mailto:tsc@tweed.nsw.gov.au).

Your name: NICKY 0401254123  
Address: email \* nickychicky @ hotmail.com  
Comments: DONT RUIN BERKLEY'S LANE  
KEEP IT AS A QUIET  
DEAD END !!  
o o

21.8.2014!

SJ: 2416, 339.	
TWEED SHIRE COUNCIL	
FILE No:	WAI - PVILLE 030
DOC. No:	
RECD:	28 AUG 2014
ASSIGNED TO:	MOGGAN
HARD COPY	<input type="checkbox"/>
IMAGE	<input checked="" type="checkbox"/>

# Feedback form

## Pottsville service lane two-way option



At its meeting on 17 July 2014, Council resolved to undertake additional community consultation about the construction of a rear lane off Coronation Avenue, Pottsville, this time with two-way traffic flow.

(In June 2014, Council exhibited and sought public comment on the formation of a rear lane and a proposal to change the traffic flow in Berkleys Lane, the unnamed lane and eastern sports field car park to one-way.)

The proposed works will include the construction of an additional three (3) parallel car parks to the western side of Berkleys Lane, while ensuring an appropriate green buffer to the adjoining residence and adequate vehicle turning paths. It includes the retention of the fig tree in Berkleys Lane.

Your feedback on this form would be appreciated and will be considered as a formal submission. The closing date for submissions has been extended to Thursday 28 June 2014.

You can either submit your comments at this information session or send your submission by the closing date to: General Manager, Tweed Shire Council, PO Box 816, Murwillumbah NSW 2484 or email [tsc@tweed.nsw.gov.au](mailto:tsc@tweed.nsw.gov.au).

Your name: Sea Tirris 15A CORONATION AVE.

Address: Sea\_t91@hotmail.com

Comments: Please don't join service  
lane to Berkleys Lane. I have lived  
in Pottsville on and off for 23 years  
and believe that this would  
create more problems and  
may cause accidents for young  
children and adults.

512446, 339.

TWEED SHIRE COUNCIL
FILE No: 1061 - PIVUE 030
DOC. No: .....
RECD: 28 AUG 2014
ASSIGNED TO: MORCAS, P
HARD COPY <input type="checkbox"/> IMAGE <input checked="" type="checkbox"/>

# Feedback form

## Pottsville service lane two-way option



At its meeting on 17 July 2014, Council resolved to undertake additional community consultation about the construction of a rear lane off Coronation Avenue, Pottsville, this time with two-way traffic flow.

(In June 2014, Council exhibited and sought public comment on the formation of a rear lane and a proposal to change the traffic flow in Berkleys Lane, the unnamed lane and eastern sports field car park to one-way.)

The proposed works will include the construction of an additional three (3) parallel car parks to the western side of Berkleys Lane, while ensuring an appropriate green buffer to the adjoining residence and adequate vehicle turning paths. It includes the retention of the fig tree in Berkleys Lane.

Your feedback on this form would be appreciated and will be considered as a formal submission. The closing date for submissions has been extended to Thursday 28 June 2014.

You can either submit your comments at this information session or send your submission by the closing date to: General Manager, Tweed Shire Council, PO Box 816, Murwillumbah NSW 2484 or email [tsc@tweed.nsw.gov.au](mailto:tsc@tweed.nsw.gov.au).

Your name: Mark Tirris  
Address: 39 Walker St, Lismore (Former Pottsville resident)  
Comments: The Bushland behind IGA has important animals that use it. Please don't put the service road in as a connection road to Berkleys lane. Leave it as it is. The old tree has been used by goannas before. Please keep it there.

mark.tirris@gmail.com  
Mark Tirris  
23.8.14

55:2416 339

TWEED SHIRE COUNCIL
FILE No: <u>INFU - PVILLE</u> CBO
DOC. No: .....
REC'D: <u>28 AUG 2014</u>
ASSIGNED TO: <u>MORLEY P</u>
HARD COPY <input type="checkbox"/> IMAGE <input checked="" type="checkbox"/>

# Feedback form

## Pottsville service lane two-way option



At its meeting on 17 July 2014, Council resolved to undertake additional community consultation about the construction of a rear lane off Coronation Avenue, Pottsville, this time with two-way traffic flow.

(In June 2014, Council exhibited and sought public comment on the formation of a rear lane and a proposal to change the traffic flow in Berkleys Lane, the unnamed lane and eastern sports field car park to one-way.)

The proposed works will include the construction of an additional three (3) parallel car parks to the western side of Berkleys Lane, while ensuring an appropriate green buffer to the adjoining residence and adequate vehicle turning paths. It includes the retention of the fig tree in Berkleys Lane.

Your feedback on this form would be appreciated and will be considered as a formal submission. The closing date for submissions has been extended to Thursday 28 June 2014.

You can either submit your comments at this information session or send your submission by the closing date to: General Manager, Tweed Shire Council, PO Box 816, Murwillumbah NSW 2484 or email [tsc@tweed.nsw.gov.au](mailto:tsc@tweed.nsw.gov.au).

Your name: Zoy Osman

Address: 31 SASSAFRAS ST POTTSVILLE

Comments: Please don't join the service lane to Berkleys Lane. I feel it would be more of a hazard than it is already.

SS: 2416, 339

TWEED SHIRE COUNCIL	
FILE No: <u>1271 - PIVUE</u>	080
DOC. No: .....	
REC'D: 28 AUG 2014	
ASSIGNED TO: <u>MORCAY</u>	
HARD COPY <input type="checkbox"/>	IMAGE <input checked="" type="checkbox"/>

tirris2@yahoo.com.au

# Feedback form

## Pottsville service lane two-way option



At its meeting on 17 July 2014, Council resolved to undertake additional community consultation about the construction of a rear lane off Coronation Avenue, Pottsville, this time with two-way traffic flow.

(In June 2014, Council exhibited and sought public comment on the formation of a rear lane and a proposal to change the traffic flow in Berkleys Lane, the unnamed lane and eastern sports field car park to one-way.)

The proposed works will include the construction of an additional three (3) parallel car parks to the western side of Berkleys Lane, while ensuring an appropriate green buffer to the adjoining residence and adequate vehicle turning paths. It includes the retention of the fig tree in Berkleys Lane.

Your feedback on this form would be appreciated and will be considered as a formal submission. The closing date for submissions has been extended to Thursday 28 June 2014.

You can either submit your comments at this information session or send your submission by the closing date to: General Manager, Tweed Shire Council, PO Box 816, Murwillumbah NSW 2484 or email [tsc@tweed.nsw.gov.au](mailto:tsc@tweed.nsw.gov.au).

Your name: Janeene Payne JANEENE PAYNE  
Address: Paynejaneene@gmail.com  
Comments: Previously I have sent  
correspondence to Council Re  
this issue. I strongly disagree  
with the plan to make  
Berkley Lane lead into  
the Service Access Rd in the  
C.B.D. It works for us local,  
just as it is. Thank you.

SI: 2416, 339

TWEED SHIRE COUNCIL	
FILE No:	WHI- PINE 30
DOC. No:	
REC'D:	28 AUG 2014
ASSIGNED TO:	M. EGAN
HARD COPY	<input type="checkbox"/>
IMAGE	<input checked="" type="checkbox"/>

LEAVE BERKLEY'S LANE  
AS IT IS AND KEEP  
THE TREE

BIGKENNYA@YAHOO.COM.AU

ANONYMOUS.

SJ: 2416, 339

TWEED SHIRE COUNCIL	
FILE No:	WAI - PINE C80
DOC. No:	.....
RECD:	28 AUG 2014
ASSIGNED TO:	MORRIS. P
HARD COPY	<input type="checkbox"/>
IMAGE	<input checked="" type="checkbox"/>



Keep Berkeley lane pottsville as a dead-end street. And the tree can stay!

AK

~~026676115~~

0266762077

Born & Raised pottsville

23-8-14

Anonymous.

SI: 2416, 339

TWEED SHIRE COUNCIL	
FILE No:	1271 - PVILLE CSO
DOC. No:	
RECD:	28 AUG 2014
ASSIGNED TO:	MORGAN. P
HARD COPY	<input type="checkbox"/>
IMAGE	<input checked="" type="checkbox"/>

## Sandra Zietlow

---

**From:** amna.queshi.96@gmail.com  
**Sent:** Thursday, 28 August 2014 1:12 PM  
**To:** Corporate Email  
**Subject:** Berkley Laneway

Hi

Please don't turn a quiet little lawn way called Berkleys Lane into a Main Lead-in Road to service shops in Pottsville Beach. The safer and more acceptable thing to do is to keep using the other entrance as it's been used for more than 5 years.

Name: Amna Rehan  
Contact: 0470 120 721

## Sandra Zietlow

---

**From:** heybabe8 [heybabe8@hotmail.com]  
**Sent:** Thursday, 28 August 2014 3:07 PM  
**To:** Corporate Email  
**Subject:** Berkleys lane

Sir/Madam

With regards to Berkleys lane, we r against it being opened due to safety reasons. Please consider the effects it would have on the lical residents.

Thanking u for your consideration.

Kind Regards

In support of Donna Tiris Black, a local resident.

Sent from Samsung Mobile

**Sandra Zietlow**

---

**From:** debbie mundy [brajerak@yahoo.com.au]  
**Sent:** Thursday, 28 August 2014 3:24 PM  
**To:** Corporate Email  
**Subject:** New Road at Pottsville (Berklys Lane)

Attention:

Manager of  
Tweed Shire Council  
Tweed Heads NSW

Dear Sir/Madam,

I Debbie Mundy of 10 Yale street, *Kingscliff NSW 2487, a concerned resident* and member of the community, is writing in regards to the proposal of a new road that is proposed for **Berklys Lane, Pottsville NSW**. I have concerns to the safety of the residents and other community citizens, that have lived in that area of Pottsville and I am in unison with the residents and taxpayers of that part of Pottsville and is opposed to the development and construction of the proposed road earmarked to be built there indefinitely.

*with many thanks*  
*Debbie Mundy*

## Sandra Zietlow

---

**From:** Katie [sporty\_kate00@hotmail.com]  
**Sent:** Thursday, 28 August 2014 3:30 PM  
**To:** Corporate Email  
**Cc:** sporty\_kate00@hotmail.com  
**Subject:** Road.

I'm am writing to say I do not approve of the work going to be done on Barkley lane. I object!!!  
Sent from my iPhone

## Sandra Zietlow

---

**From:** Roger Wecker [rogerwecker@gmail.com]  
**Sent:** Thursday, 28 August 2014 3:38 PM  
**To:** Corporate Email  
**Subject:** Pottsville Service lane - Project Number - INF11

The General Manager, Tweed Shire Council

RE: Pottsville Service lane - Project Number - INF11

As long term residents of Pottsville, we wish to take this opportunity to provide our overall support to Tweed Shire Council's proposal regarding the construction of the Pottsville Service lane, thereby, restricting access to the IGA Pottsville store via Coronation Ave.

From firsthand experience, the current situation regarding ingress & egress to the IGA Pottsville store is dangerous to both pedestrians & motor vehicles, and needs to be rectified as soon as possible. In saying that we agree with Councils proposal as illustrated in Project Number INF11, Diagram 3, we do wish to make some additional suggestions.

**Berkleys Lane:**

1. Kerb & channelling on both sides of the street

**Unnamed Road:**

1. **No Right-hand exit from 'unnamed road' into Coronation Ave** to prevent traffic congestion during peak periods, weekends & market days. In Councils proposal, this street would be responsible for carrying a much greater volume of traffic. Drivers instead have the option to use the round-about to proceed back along Coronation Ave.

Thanks for your consideration.

Kind regards,

Roger & Ursula Wecker  
10 Flintwood Street  
Pottsville

## Sandra Zietlow

---

**From:** Kat [astrokitty.raver@hotmail.com]  
**Sent:** Thursday, 28 August 2014 3:48 PM  
**To:** Corporate Email  
**Subject:** Lane way berklys lane to main road

Hello my name is kathryne I'm weighting in regards The lane way (berklys lane) that might be getting turned into a lead in rd for the new service rd behind the IGA in Pottsville beach ... Due to safety reasons I'm against it...

Thanks kathryne

Sent from my iPad

**Sandra Zietlow**

---

**From:** CLARE WILLIAMSON [c.williamson27@gmail.com]  
**Sent:** Thursday, 28 August 2014 3:54 PM  
**To:** Corporate Email  
**Subject:** berklys lane

hi i'm sending this email to object against berklys lane being turned into a lead in road for the new service road behind iga at pottsville beach it would be turning a quiet area into a main traffic road nd i think it would be unsafe!! thank you for your time.. clare



**Sandra Zietlow**

---

**From:** Wooyung Park [info@wooyungbeach.com.au]  
**Sent:** Thursday, 28 August 2014 4:10 PM  
**To:** Corporate Email  
**Subject:** Submission to Pottsville Service Rd Exhibition

Dear Mr Green,

I strongly object to the removal of the tree in Berkleys lane and believe it would be inconsistent with Councils previous actions of placing protective barriers around this tree.

I believe the tree forms a natural traffic calming device and will have the effect of reducing the impact of traffic on the existing residents on this street, if a two way option through road option is approved by Council.

I support traffic calming measures being placed on this laneway and believe there is a high likelihood of this laneway attracting anti-social behaviour if traffic calming devices are not installed.

Regards

Chris Cherry  
515 Wooyung Rd  
Wooyung  
NSW 2483

--

***Wooyung Beach Holiday Park***

*www.WooyungBeach.com.au*

*info@WooyungBeach.com.au*

*Phone: 02-6677 1300*

## Sandra Zietlow

---

**From:** Bryan Threlfall [bryan\_dt@bigpond.net.au]  
**Sent:** Thursday, 28 August 2014 4:49 PM  
**To:** Corporate Email  
**Subject:** Pottsville Service Lane Submission

To:

General Manager  
Tweed Shire Council  
Murwillumbah

I agree with the currently proposed two-way traffic flow but, I submit that, if it is legally possible to remove the fig-tree in Berkley's Lane then it would be preferable to do so.

Even now cars have to give way to oncoming vehicles when passing the fig-tree. With the anticipated increase in volume of traffic using the lane it could become quite a problem. A number of residents I have spoken to cannot comprehend why they would use the lane if there is just one-way at the fig-tree.

In addition, if the fig-tree remains, I believe that trucks delivering goods to the rear of shops could have difficulty in doing a right-hand turn from the present Berkley's Lane to travel along the new section if they travel from Coronation Avenue & the chemist's corner.

A koala-proof fence along the northern side of the lane would be ideal but I accept the fact that no such fence exists now and the number of koalas, if any, in that vicinity is unknown.

I believe the recommendation that the name "Berkley's Lane" should be used for the extended roadway as well as the existing.

Yours faithfully,

Bryan Threlfall  
11 Korora Parkway  
Pottsville 2489

Notice to Council.

Leave Berkleys Lane  
Pottsville alone. Do not  
develop it into a lead in  
service Rd for the rear  
of the Shopping Centre.  
Also do not remove the  
Fig Tree.

50-2416,339

Tweed Shire Council	
FILE No:	WFL - PVILLE 030
DOC. No:	.....
RECD:	28 AUG 2014
ASSIGNED TO:	MORLAN, P
HARD COPY	<input type="checkbox"/>
IMAGE	<input checked="" type="checkbox"/>

Signed Natalie Whalan  
Natalie Whalan

Dated August 2014

Address Resident of Pottsville.

or 27 Macadamie Av

Phone number (07) 66760871

Pottsville

# Feedback form

## Pottsville service lane two-way option



At its meeting on 17 July 2014, Council resolved to undertake additional community consultation about the construction of a rear lane off Coronation Avenue, Pottsville, this time with two-way traffic flow.

(In June 2014, Council exhibited and sought public comment on the formation of a rear lane and a proposal to change the traffic flow in Berkleys Lane, the unnamed lane and eastern sports field car park to one-way.)

The proposed works will include the construction of an additional three (3) parallel car parks to the western side of Berkleys Lane, while ensuring an appropriate green buffer to the adjoining residence and adequate vehicle turning paths. It includes the retention of the fig tree in Berkleys Lane.

Your feedback on this form would be appreciated and will be considered as a formal submission. The closing date for submissions has been extended to Thursday 28 June 2014.

You can either submit your comments at this information session or send your submission by the closing date to: General Manager, Tweed Shire Council, PO Box 816, Murwillumbah NSW 2484 or email [tsc@tweed.nsw.gov.au](mailto:tsc@tweed.nsw.gov.au).

Your name: Rebecca Ingram  
Address: PO Box 464 Mullumbimby  
Comments: To whom it may concern, please  
leave the dead end lane way of Belle Pottsville  
Berkley lane as it is. It is beautiful & the Fig  
Tree that is there must remain in tact  
Thankyou. ss: 2416, 339

TWEED SHIRE COUNCIL	
FILE No:	<u>whi - POTTVILLE CBD</u>
DOC. No:	.....
REC'D:	<u>28 AUG 2014</u>
ASSIGNED TO:	<u>moe CAL. P</u>
HARD COPY	<input type="checkbox"/>
IMAGE	<input checked="" type="checkbox"/>

# Feedback form

## Pottsville service lane two-way option



At its meeting on 17 July 2014, Council resolved to undertake additional community consultation about the construction of a rear lane off Coronation Avenue, Pottsville, this time with two-way traffic flow.

(In June 2014, Council exhibited and sought public comment on the formation of a rear lane and a proposal to change the traffic flow in Berkleys Lane, the unnamed lane and eastern sports field car park to one-way.)

The proposed works will include the construction of an additional three (3) parallel car parks to the western side of Berkleys Lane, while ensuring an appropriate green buffer to the adjoining residence and adequate vehicle turning paths. It includes the retention of the fig tree in Berkleys Lane.

Your feedback on this form would be appreciated and will be considered as a formal submission. The closing date for submissions has been extended to Thursday 28 June 2014.

You can either submit your comments at this information session or send your submission by the closing date to: General Manager, Tweed Shire Council, PO Box 816, Murwillumbah NSW 2484 or email [tsc@tweed.nsw.gov.au](mailto:tsc@tweed.nsw.gov.au).

Your name: Mikayla Turk  
Address: Mikayla.Turk1314@gmail.com  
Comments: I don't want Berkleys Lane made into a busy road for ~~the~~ trucks and cars to use.

Mturk

SJ: 2416, 339  
TWEED SHIRE COUNCIL  
FILE NO: WHI - PVILLE 030  
DEC. No. ....  
REC'D: 28 AUG 2014  
ASSIGNED TO: MORGAJ.P  
HARD COPY  IMAGE

# Feedback form

## Pottsville service lane two-way option



At its meeting on 17 July 2014, Council resolved to undertake additional community consultation about the construction of a rear lane off Coronation Avenue, Pottsville, this time with two-way traffic flow.

(In June 2014, Council exhibited and sought public comment on the formation of a rear lane and a proposal to change the traffic flow in Berkleys Lane, the unnamed lane and eastern sports field car park to one-way.)

The proposed works will include the construction of an additional three (3) parallel car parks to the western side of Berkleys Lane, while ensuring an appropriate green buffer to the adjoining residence and adequate vehicle turning paths. It includes the retention of the fig tree in Berkleys Lane.

Your feedback on this form would be appreciated and will be considered as a formal submission. The closing date for submissions has been extended to Thursday 28 June 2014.

You can either submit your comments at this information session or send your submission by the closing date to: General Manager, Tweed Shire Council, PO Box 816, Murwillumbah NSW 2484 or email [tsc@tweed.nsw.gov.au](mailto:tsc@tweed.nsw.gov.au).

Your name: Julie West

Address: 0411 721 926 52 WANNINGARA VIEW LIMPINWOOD

Comments: \_\_\_\_\_

I THINK THE IDEA OF REMOVING THE TREE TO CREATE EASY ACCESS FOR TRUCKS INTO THE STRIPPING AREA WHEN THERE IS A VIABLE ALTERNATIVE IS OUTRAGEOUS!

PLEASE RECONSIDER THIS DECISION AS OUR NATURAL HERITAGE IS MORE IMPORTANT LONG TERM THAN COMMERCE. AND LEAVE BERKLEYS LANE AS A CUL-DE-SAC.

*[Handwritten signature]*

SJ: 2416, 339

TWEED SHIRE COUNCIL
FILE No: INF11 - PJULIE 080
DOC. No: _____
REC'D: 28 AUG 2014
ASSIGNED TO: MORCAY P
HARD COPY <input type="checkbox"/> IMAGE <input checked="" type="checkbox"/>

Page 1 of 2

# Feedback form

## Pottsville service lane two-way option



At its meeting on 17 July 2014, Council resolved to undertake additional community consultation about the construction of a rear lane off Coronation Avenue, Pottsville, this time with two-way traffic flow.

(In June 2014, Council exhibited and sought public comment on the formation of a rear lane and a proposal to change the traffic flow in Berkleys Lane, the unnamed lane and eastern sports field car park to one-way.)

The proposed works will include the construction of an additional three (3) parallel car parks to the western side of Berkleys Lane, while ensuring an appropriate green buffer to the adjoining residence and adequate vehicle turning paths. It includes the retention of the fig tree in Berkleys Lane.

Your feedback on this form would be appreciated and will be considered as a formal submission. The closing date for submissions has been extended to Thursday 28 June 2014.

You can either submit your comments at this information session or send your submission by the closing date to: General Manager, Tweed Shire Council, PO Box 816, Murwillumbah NSW 2484 or email [tsc@tweed.nsw.gov.au](mailto:tsc@tweed.nsw.gov.au).

Your name: Sherree Wearne

Address: ~~Sherree~~ @ shereewearne-hof-worren@hotmail.com

Comments: LEAVE BERKLEYS LANE - POTTSVILLE ALONE!!

DO NOT CUT DOWN THE FIG TREE OR DEVELOPE

THE LANE

SINCERELY

 earne

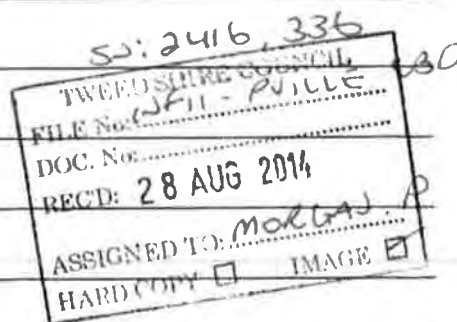

# Feedback form

## Pottsville service lane two-way option



At its meeting on 17 July 2014, Council resolved to undertake additional community consultation about the construction of a rear lane off Coronation Avenue, Pottsville, this time with two-way traffic flow.

(In June 2014, Council exhibited and sought public comment on the formation of a rear lane and a proposal to change the traffic flow in Berkleys Lane, the unnamed lane and eastern sports field car park to one-way.)

The proposed works will include the construction of an additional three (3) parallel car parks to the western side of Berkleys Lane, while ensuring an appropriate green buffer to the adjoining residence and adequate vehicle turning paths. It includes the retention of the fig tree in Berkleys Lane.

Your feedback on this form would be appreciated and will be considered as a formal submission. The closing date for submissions has been extended to Thursday 28 June 2014.

You can either submit your comments at this information session or send your submission by the closing date to: General Manager, Tweed Shire Council, PO Box 816, Murwillumbah NSW 2484 or email [tsc@tweed.nsw.gov.au](mailto:tsc@tweed.nsw.gov.au).

Your name: Nick Powell

Address: drew.kito@gmail.com

Comments: The big fig tree in Berkleys Lane is important  
so don't take it away also leave the lane way safe  
and don't turn it into a busy road by turning it up  
to the back service road model

S.J. 2416, 335  
TWEED SHIRE COUNCIL  
INF - PVILLE 080  
REC'D: 28 AUG 2014  
ASSIGNED TO: Mozart P  
HARD COPY  IMAGE



# Feedback form

## Pottsville service lane two-way option



At its meeting on 17 July 2014, Council resolved to undertake additional community consultation about the construction of a rear lane off Coronation Avenue, Pottsville, this time with two-way traffic flow.

(In June 2014, Council exhibited and sought public comment on the formation of a rear lane and a proposal to change the traffic flow in Berkleys Lane, the unnamed lane and eastern sports field car park to one-way.)

The proposed works will include the construction of an additional three (3) parallel car parks to the western side of Berkleys Lane, while ensuring an appropriate green buffer to the adjoining residence and adequate vehicle turning paths. It includes the retention of the fig tree in Berkleys Lane.

Your feedback on this form would be appreciated and will be considered as a formal submission. The closing date for submissions has been extended to Thursday 28 June 2014.

You can either submit your comments at this information session or send your submission by the closing date to: General Manager, Tweed Shire Council, PO Box 816, Murwillumbah NSW 2484 or email [tsc@tweed.nsw.gov.au](mailto:tsc@tweed.nsw.gov.au).

Your name: STEVEN McCLOY  
Address: 200 KILEY'S Road Moolball  
Comments: Please advocate taking the Fig Tree from the lane that council plans to use as a joined up road for way to many cars and heavy vehicles that would use it a forementioned lane is Berkleys Lane. S.D. McCloy

SJ: 2416, 339

TWEED SHIRE COUNCIL
FILE No: INF11 - PVILLE CBD
DOC No:
RECD: 28 AUG 2014
ASSIGNED TO: MORGAN, P
HARD COPY <input type="checkbox"/> IMAGE <input checked="" type="checkbox"/>

# Feedback form

## Pottsville service lane two-way option



At its meeting on 17 July 2014, Council resolved to undertake additional community consultation about the construction of a rear lane off Coronation Avenue, Pottsville, this time with two-way traffic flow.

(In June 2014, Council exhibited and sought public comment on the formation of a rear lane and a proposal to change the traffic flow in Berkleys Lane, the unnamed lane and eastern sports field car park to one-way.)

The proposed works will include the construction of an additional three (3) parallel car parks to the western side of Berkleys Lane, while ensuring an appropriate green buffer to the adjoining residence and adequate vehicle turning paths. It includes the retention of the fig tree in Berkleys Lane.

Your feedback on this form would be appreciated and will be considered as a formal submission. The closing date for submissions has been extended to Thursday 28 June 2014.

You can either submit your comments at this information session or send your submission by the closing date to: General Manager, Tweed Shire Council, PO Box 816, Murwillumbah NSW 2484 or email [tsc@tweed.nsw.gov.au](mailto:tsc@tweed.nsw.gov.au).

Your name: Annette Tartan

Address: 200 Kiley's Road Mooball

Comments: The removal of the fig tree is  
advisable and stand strongly against it.

I also stan against Berkley lane becoming  
part of a service road. Leave it as  
a no through road.

A. M. Tartan

52,2916,339  
Tweed Shire Council  
FILE NO: WHI-PLUVE 430  
DOC. No: .....  
RECD: 28 AUG 2014  
ASSIGNED TO: MOLLY P  
HARD COPY  IMAGE

Notice to Council.

Leave Berkleys Lane  
Pottsville alone. Do not  
develop it into a lead in  
service Rd for the rear  
of the Shopping Centre.  
Also do not remove the  
Fig Tree.



Signed Robert Cameron

Dated 28/8/14

Address Organic Revolution  
or

Phone number 66727 070

Notice to Council.

Leave Berkleys Lane

Pottsville alone. Do not  
develop it into a lead in  
service Rd for the rear  
of the Shopping Centre.

Also do not remove the  
Fig Tree.

SJ. 2416, 339.

TWEEDSHIRE COUNCIL	
FILE No:	INF11 - PVILLE 130
DOC. No:	
RECD:	28 AUG 2014
ASSIGNED TO:	MORGAN P
HARD COPY	<input type="checkbox"/>
IMAGE	<input checked="" type="checkbox"/>

Signed Wendy Cameron

Wendy Cameron

Dated 28/8/14

Address 253 Mt Warring Rd  
or 2484

Phone number 66795-017.

Notice to Council.

Leave Berkleys Lane

Pottsville alone. Do not  
develop it into a lead in  
service Rd for the rear  
of the Shopping Centre.

Also do not remove the  
Fig Tree.

50: 2416 339

TOWN & COUNTRY COUNCIL	
FILE No:	241 - PVILLE 280
DOC. No:	.....
RECD:	28 AUG 2014
ASSIGNED TO:	MOELAN. P
HARD COPY	<input type="checkbox"/>
IMAGE	<input checked="" type="checkbox"/>

Signed T. Halls

Dated 28/8/14

Address 11 Church lane  
or

Phone number

# Feedback form

## Pottsville service lane two-way option



At its meeting on 17 July 2014, Council resolved to undertake additional community consultation about the construction of a rear lane off Coronation Avenue, Pottsville, this time with two-way traffic flow.

(In June 2014, Council exhibited and sought public comment on the formation of a rear lane and a proposal to change the traffic flow in Berkleys Lane, the unnamed lane and eastern sports field car park to one-way.)

The proposed works will include the construction of an additional three (3) parallel car parks to the western side of Berkleys Lane, while ensuring an appropriate green buffer to the adjoining residence and adequate vehicle turning paths. It includes the retention of the fig tree in Berkleys Lane.

Your feedback on this form would be appreciated and will be considered as a formal submission. The closing date for submissions has been extended to Thursday 28 June 2014.

You can either submit your comments at this information session or send your submission by the closing date to: General Manager, Tweed Shire Council, PO Box 816, Murwillumbah NSW 2484 or email [tsc@tweed.nsw.gov.au](mailto:tsc@tweed.nsw.gov.au).

Your name: VICKI WHITE

Address: angels\_ink61@hotmail.com

Comments: \_\_\_\_\_

I disapprove of the removal of the fig tree in Berkleys Lane, Pottsville. Also I disapprove of the increased traffic that this development would create.

Faithfully

Vicki White

51: 2416 339 .

FILE No:	WF11 - PVILLE CBO
DOC No:	
REC'D:	28 AUG 2014
ASSIGNED TO:	MORGAN A
HARD COPY	<input type="checkbox"/>
IMAGE	<input checked="" type="checkbox"/>

Notice to Council.

Leave Berkleys Lane

Pottsville alone. Do not develop it into a lead in service Rd for the rear of the Shopping Centre.

Also do not remove the Fig Tree.

SI: 2416, 339

TWEED SHIRE COUNCIL	
FILE No:	L-41- PINE 080
DOC. No:	.....
RECD:	28 AUG 2014
ASSIGNED TO:	MORLAJ. A
HARD COPY	<input type="checkbox"/>
IMAGE	<input checked="" type="checkbox"/>

Signed Peter Whalan

Dated August 10<sup>th</sup>

Address 27 Macadamia DR  
or Pottsville

Phone number

Notice to Council.

Leave Berkleys Lane  
Pottsville alone. Do not  
develop it into a lead in  
service Rd for the rear  
of the Shopping Centre.  
Also do not remove the  
Fig Tree.

SJ: 2416, 339

TOWN OF SHIRE COUNCIL	
FILE No:	12/11-PTVILLE 080
DOC. No:	.....
RECD:	28 AUG 2014
ASSIGNED TO:	moewal.P
SEND COPY <input type="checkbox"/>	IMAGE <input checked="" type="checkbox"/>

Signed Jo Whalan  
J. Whalan

Dated August

Address 27 Macadamia Dr  
Pottsville  
or

Phone number



# Feedback form

## Pottsville service lane two-way option



At its meeting on 17 July 2014, Council resolved to undertake additional community consultation about the construction of a rear lane off Coronation Avenue, Pottsville, this time with two-way traffic flow.

(In June 2014, Council exhibited and sought public comment on the formation of a rear lane and a proposal to change the traffic flow in Berkleys Lane, the unnamed lane and eastern sports field car park to one-way.)

The proposed works will include the construction of an additional three (3) parallel car parks to the western side of Berkleys Lane, while ensuring an appropriate green buffer to the adjoining residence and adequate vehicle turning paths. It includes the retention of the fig tree in Berkleys Lane.

Your feedback on this form would be appreciated and will be considered as a formal submission. The closing date for submissions has been extended to Thursday 28 June 2014.

You can either submit your comments at this information session or send your submission by the closing date to: General Manager, Tweed Shire Council, PO Box 816, Murwillumbah NSW 2484 or email [tsc@tweed.nsw.gov.au](mailto:tsc@tweed.nsw.gov.au).

Your name: TRACEY THOMAS - 7 Kelly Ave

Address: mail to tracey@me.com.

Comments: The removal of the Fig Tree in Berkleys Lane in Pottsville is unnecessary best you leave the road as a quiet cul-de-sac

51: 2416, 339.

TWEED SHIRE COUNCIL	
FILE No:	AP11 - PVILLE 080
DOC. No:	
RECD:	28 AUG 2014
ASSIGNED TO:	MORCAY P
HARD COPY	<input type="checkbox"/>
IMAGE	<input checked="" type="checkbox"/>

# Feedback form

## Pottsville service lane two-way option



At its meeting on 17 July 2014, Council resolved to undertake additional community consultation about the construction of a rear lane off Coronation Avenue, Pottsville, this time with two-way traffic flow.

(In June 2014, Council exhibited and sought public comment on the formation of a rear lane and a proposal to change the traffic flow in Berkleys Lane, the unnamed lane and eastern sports field car park to one-way.)

The proposed works will include the construction of an additional three (3) parallel car parks to the western side of Berkleys Lane, while ensuring an appropriate green buffer to the adjoining residence and adequate vehicle turning paths. It includes the retention of the fig tree in Berkleys Lane.

Your feedback on this form would be appreciated and will be considered as a formal submission. The closing date for submissions has been extended to Thursday 28 June 2014.

You can either submit your comments at this information session or send your submission by the closing date to: General Manager, Tweed Shire Council, PO Box 816, Murwillumbah NSW 2484 or email [tsc@tweed.nsw.gov.au](mailto:tsc@tweed.nsw.gov.au).

Your name: Josh McEwen  
Address: 1 Pottsville PL Murwillumbah  
Comments: It's unnecessary to turn Berkleys lane  
into a bypass road just to service  
the shops and leave the fig tree there

ST. 2416 339  
TWEED SHIRE COUNCIL  
FILE NO: 11/11/14  
DOC. No: .....  
RECD: 28 AUG 2014  
ASSIGNED TO: MORLEY A  
HARD COPY  IMAGE

# Feedback form

## Pottsville service lane two-way option



At its meeting on 17 July 2014, Council resolved to undertake additional community consultation about the construction of a rear lane off Coronation Avenue, Pottsville, this time with two-way traffic flow.

(In June 2014, Council exhibited and sought public comment on the formation of a rear lane and a proposal to change the traffic flow in Berkleys Lane, the unnamed lane and eastern sports field car park to one-way.)

The proposed works will include the construction of an additional three (3) parallel car parks to the western side of Berkleys Lane, while ensuring an appropriate green buffer to the adjoining residence and adequate vehicle turning paths. It includes the retention of the fig tree in Berkleys Lane.

Your feedback on this form would be appreciated and will be considered as a formal submission. The closing date for submissions has been extended to Thursday 28 June 2014.

You can either submit your comments at this information session or send your submission by the closing date to: General Manager, Tweed Shire Council, PO Box 816, Murwillumbah NSW 2484 or email [tsc@tweed.nsw.gov.au](mailto:tsc@tweed.nsw.gov.au).

Your name: Reece Middleton

Address: 1121 Kyogle road

Comments: let berkleys lane stay how it is  
and dont remove the big fig tree.

*R. Middleton*

50.2416.339  
TWEED SHIRE COUNCIL  
FILE No: MF11 - PIVILE CGO  
DOC No: .....  
RECD: **28 AUG 2014**  
ASSIGNED TO: MORLEY, P  
HARD COPY  IMAGE

# Feedback form

## Pottsville service lane two-way option



At its meeting on 17 July 2014, Council resolved to undertake additional community consultation about the construction of a rear lane off Coronation Avenue, Pottsville, this time with two-way traffic flow.

(In June 2014, Council exhibited and sought public comment on the formation of a rear lane and a proposal to change the traffic flow in Berkleys Lane, the unnamed lane and eastern sports field car park to one-way.)

The proposed works will include the construction of an additional three (3) parallel car parks to the western side of Berkleys Lane, while ensuring an appropriate green buffer to the adjoining residence and adequate vehicle turning paths. It includes the retention of the fig tree in Berkleys Lane.

Your feedback on this form would be appreciated and will be considered as a formal submission. The closing date for submissions has been extended to Thursday 28 June 2014.

You can either submit your comments at this information session or send your submission by the closing date to: General Manager, Tweed Shire Council, PO Box 816, Murwillumbah NSW 2484 or email [tsc@tweed.nsw.gov.au](mailto:tsc@tweed.nsw.gov.au).

Your name: Alaxtha Turner 1033 BEAMS CREEK RD  
Address: 11-TAFE 66720860  
Comments: I would prefer an option that  
would retain the fig tree

*ADK*

SS: 2416, 339	
TWEED SHIRE COUNCIL	
FILE No:	PTV - PIVCE 080
DOC. No:	
RECD:	28 AUG 2014
ASSIGNED TO:	MOELAN J.P
HARD COPY	<input type="checkbox"/>
IMAGE	<input checked="" type="checkbox"/>

# Feedback form

## Pottsville service lane two-way option



At its meeting on 17 July 2014, Council resolved to undertake additional community consultation about the construction of a rear lane off Coronation Avenue, Pottsville, this time with two-way traffic flow.

(In June 2014, Council exhibited and sought public comment on the formation of a rear lane and a proposal to change the traffic flow in Berkleys Lane, the unnamed lane and eastern sports field car park to one-way.)

The proposed works will include the construction of an additional three (3) parallel car parks to the western side of Berkleys Lane, while ensuring an appropriate green buffer to the adjoining residence and adequate vehicle turning paths. It includes the retention of the fig tree in Berkleys Lane.

Your feedback on this form would be appreciated and will be considered as a formal submission. The closing date for submissions has been extended to Thursday 28 June 2014.

You can either submit your comments at this information session or send your submission by the closing date to: General Manager, Tweed Shire Council, PO Box 816, Murwillumbah NSW 2484 or email [tsc@tweed.nsw.gov.au](mailto:tsc@tweed.nsw.gov.au).

Your name: Fergus Canning

Address: 41 Morrison Ave Murwillumbah 2482

Comments: Don't take the tree & put a road in its place that's just wrong

SN: 2416.339.

TWEED SHIRE COUNCIL
FILE No: INF11-PVILLECBC
DOC. No:
REC'D: 28 AUG 2014
ASSIGNED TO: <u>Morgan P</u>
HARD COPY <input type="checkbox"/> IMAGE <input checked="" type="checkbox"/>

# Feedback form

## Pottsville service lane two-way option



At its meeting on 17 July 2014, Council resolved to undertake additional community consultation about the construction of a rear lane off Coronation Avenue, Pottsville, this time with two-way traffic flow.

(In June 2014, Council exhibited and sought public comment on the formation of a rear lane and a proposal to change the traffic flow in Berkleys Lane, the unnamed lane and eastern sports field car park to one-way.)

The proposed works will include the construction of an additional three (3) parallel car parks to the western side of Berkleys Lane, while ensuring an appropriate green buffer to the adjoining residence and adequate vehicle turning paths. It includes the retention of the fig tree in Berkleys Lane.

Your feedback on this form would be appreciated and will be considered as a formal submission. The closing date for submissions has been extended to Thursday 28 June 2014.

You can either submit your comments at this information session or send your submission by the closing date to: General Manager, Tweed Shire Council, PO Box 816, Murwillumbah NSW 2484 or email [tsc@tweed.nsw.gov.au](mailto:tsc@tweed.nsw.gov.au).

Your name: Julie Bruhn M'BAH DRIVE 146 MAINST M'BAH.

Address: 02 66 723141

Comments: Why destroy lovely fig when there  
is an alternative route already available.

Leave the laneway as is!

signed Julie Bruhn

SN: 2416, 339.

Tweed Shire Council	
FILE NO:	INF11 - P. WillecBO
DOC. No:	
RECD:	28 AUG 2014
ASSIGNED TO:	Morgan P
HARD COPY	<input type="checkbox"/>
IMAGE	<input checked="" type="checkbox"/>

# Feedback form

## Pottsville service lane two-way option



At its meeting on 17 July 2014, Council resolved to undertake additional community consultation about the construction of a rear lane off Coronation Avenue, Pottsville, this time with two-way traffic flow.

(In June 2014, Council exhibited and sought public comment on the formation of a rear lane and a proposal to change the traffic flow in Berkleys Lane, the unnamed lane and eastern sports field car park to one-way.)

The proposed works will include the construction of an additional three (3) parallel car parks to the western side of Berkleys Lane, while ensuring an appropriate green buffer to the adjoining residence and adequate vehicle turning paths. It includes the retention of the fig tree in Berkleys Lane.

Your feedback on this form would be appreciated and will be considered as a formal submission. The closing date for submissions has been extended to Thursday 28 June 2014.

You can either submit your comments at this information session or send your submission by the closing date to: General Manager, Tweed Shire Council, PO Box 816, Murwillumbah NSW 2484 or email [tsc@tweed.nsw.gov.au](mailto:tsc@tweed.nsw.gov.au).

Your name: Charitanga Beancy  
Address: C.beancy62@gmail.com  
Comments: I don't like that the laneway in Pottsville (berkleyslane) is going to be changed in to join on to a service road. Not a good idea.  
28/08/14  
Charitanga Beancy

SN: 2416, 339.

Tweed Shire Council
FILE No: <u>INF11-Pottle CBD</u>
DOC. No: .....
RECD: <u>28 AUG 2014</u>
ASSIGNED TO: <u>Morgan P</u>
HARD COPY <input type="checkbox"/> IMAGE <input checked="" type="checkbox"/>

# Feedback form

## Pottsville service lane two-way option



At its meeting on 17 July 2014, Council resolved to undertake additional community consultation about the construction of a rear lane off Coronation Avenue, Pottsville, this time with two-way traffic flow.

(In June 2014, Council exhibited and sought public comment on the formation of a rear lane and a proposal to change the traffic flow in Berkleys Lane, the unnamed lane and eastern sports field car park to one-way.)

The proposed works will include the construction of an additional three (3) parallel car parks to the western side of Berkleys Lane, while ensuring an appropriate green buffer to the adjoining residence and adequate vehicle turning paths. It includes the retention of the fig tree in Berkleys Lane.

Your feedback on this form would be appreciated and will be considered as a formal submission. The closing date for submissions has been extended to Thursday 28 June 2014.

You can either submit your comments at this information session or send your submission by the closing date to: General Manager, Tweed Shire Council, PO Box 816, Murwillumbah NSW 2484 or email [tsc@tweed.nsw.gov.au](mailto:tsc@tweed.nsw.gov.au).

Your name: Kathryn King KATHRYN KING

Address: kc-workings@yandex.com.au

Comments: As someone who appreciates the beautiful  
environment I'm not in support of destruction of a  
beautiful fig tree in Berkleys Lane, Pottsville, nor do I  
support opening the small lane way into a service road  
for heavy traffic use.  
KIKING

SN: 2416, 339.

FILE NO: INF11 - Pville CBD.
DOC. No: .....
REC'D: 28 AUG 2014
ASSIGNED TO: <u>morgen.P</u>
HARD COPY <input type="checkbox"/> IMAGE <input checked="" type="checkbox"/>



Notice to Council.

Leave Berkleys Lane Pottsville as it is. Do not develop it into a lead in service rd for the rear of the shopping centre. Also do not remove the Fig Tree in that laneway.

Thank You.

Name Natalie Dreha



Address PO Box 300  
M. bah.

or

Email nabrsumam@yahoo.com.au

Signature

A handwritten signature scribble consisting of several overlapping loops.

SN: 2416, 339.

TWEED SHIRE COUNCIL	
FILE No:	INELL - Pville cbd.
DOC. No:	.....
REC'D:	29 AUG 2014
ASSIGNED TO:	Morgan P
HARD COPY	<input type="checkbox"/>
IMAGE	<input checked="" type="checkbox"/>

Notice to Council.

Leave Berkleys Lane Pottsville as it is. Do not develop it into a lead in service rd for the rear of the shopping centre. Also do not remove the Fig Tree in that laneway.

Thank You.

Name PETER WHELAN

Address 77 MACADAMIA DR  
POTTSVILLE ✓

or

Email

Signature 



SN: 2416, 339.

TWEED SHIRE COUNCIL
FILE No: INF11 - Pvilleced
DOC No: .....
REC'D 29 AUG 2014
ASSIGNED TO: Morgan P
HARD COPY <input type="checkbox"/> IMAGE <input checked="" type="checkbox"/>

Notice to Council.

Leave Berkleys Lane Pottsville as it is. Do not develop it into a lead in service rd for the rear of the shopping centre. Also do not remove the Fig Tree in that laneway.

Thank You.

Name: Marilyn Lowe



Address: Walter Cres  
or Banana Point

Email

Signature *M. Lowe*

SN: 2416.339.  
TWEED SHIRE COUNCIL  
FILE No: INF11-PVILLECSD  
DOC. No: .....  
REC'D: 29 AUG 2014  
ASSIGNED TO: Morgan, P  
HARD COPY  IMAGE

Notice to Council.

Leave Berkleys Lane Pottsville as it is. Do not develop it into a lead in service rd for the rear of the shopping centre. Also do not remove the Fig Tree in that laneway.

Thank You.

Name Peter Hyde

Address 24 Condong St ✓  
Murrumbidgee

or

Email

Signature P. Hyde



SN: 2416, 339.

TWEED SHIRE COUNCIL	
FILE No:	INF11 - Pville CBD
DOC. No:	.....
REC'D:	29 AUG 2014
ASSIGNED TO:	Morgan, P
HARD COPY	<input type="checkbox"/>
IMAGE	<input checked="" type="checkbox"/>

Notice to Council.

Leave Berkleys Lane Pottsville as it is. Do not develop it into a lead in service rd for the rear of the shopping centre. Also do not remove the Fig Tree in that laneway.

Thank You.

Name STEPHEN DAVEY

SN: 2416, 339.  
TWEED SHIRE COUNCIL  
FILE No: INF11 - Pvilleced  
DOC. No: .....  
REC'D. 29 AUG 2014  
ASSIGNED TO: Morgan, P  
HARD COPY  IMAGE

Address PO Box 45  
P. ville.

or

Email STEVESPB@IINET.NET.AU

Signature *Stephen Davey*



Notice to Council.

Leave Berkleys Lane Pottsville as it is. Do not develop it into a lead in service rd for the rear of the shopping centre. Also do not remove the Fig Tree in that laneway.

Thank You.

Name KEITH ARMSTRONG

SN: 2416, 339.  
TWEED SHIRE COUNCIL  
FILE No: INF11 - P.ville CBD.  
DOC. No: .....  
RECD. 29 AUG 2014  
ASSIGNED TO: Morgan, P.  
HARD COPY  IMAGE

Address

18 THOMAS ST M/BATH ✓

or

Email

Signature

*Keith Armstrong*



Notice to Council.

Leave Berkleys Lane Pottsville as it is. Do not develop it into a lead in service rd for the rear of the shopping centre. Also do not remove the Fig Tree in that laneway.

Thank You.

Name Sean Bulmer.



Address 16 Hartigan St /  
Marwillumbah

or

Email

SN: 2416, 339.

TWEED SHIRE COUNCIL	
FILE No:	INF11-PvilleCBD.
DOC. No:	.....
RECD:	29 AUG 2014
ASSIGNED TO:	Morgan P
HARD COPY	<input type="checkbox"/>
IMAGE	<input checked="" type="checkbox"/>

Signature *S Bulmer*

Notice to Council.

Leave Berkleys Lane Pottsville as it is. Do not develop it into a lead in service rd for the rear of the shopping centre. Also do not remove the Fig Tree in that laneway.

Thank You.

Name Stephen Grant



Address 71 Wallungan St  
Murwillbah

or

Email

Signature

A handwritten signature in cursive script, appearing to be 'S Grant'.

SN: 2416, 339.

TWEED SHIRE COUNCIL	
FILE No:	INF11 - P. villedo.
DOC. No:	
REC'D:	29 AUG 2014
ASSIGNED TO:	Morgan, P
HARD COPY	<input type="checkbox"/>
IMAGE	<input checked="" type="checkbox"/>



Notice to Council.

Leave Berkleys Lane Pottsville as it is. Do not develop it into a lead in service rd for the rear of the shopping centre. Also do not remove the Fig Tree in that laneway.

Thank You.

Name Cath Caward  
Catherine Caward.

SN: 2416, 339.  
TWEED SHIRE COUNCIL  
FILE No: INF11 - Pville CBD.  
DOC. No: .....  
REC'D: 29 AUG 2014  
ASSIGNED TO: Morgan, P  
HARD COPY  IMAGE

Address 14. River St. M'Beh.

or

Email

Signature C. Caward



Notice to Council.

Leave Berkleys Lane Pottsville as it is. Do not develop it into a lead in service rd for the rear of the shopping centre. Also do not remove the Fig Tree in that laneway.

Thank You.

Name Joshua Lee

SN: 2416, 339.  
TWEED SHIRE COUNCIL  
FILE No: INF11 - Pville CBD.  
DOC. No: .....  
RECD: 29 AUG 2014  
ASSIGNED TO: Morgan, P.  
HARD COPY  IMAGE

Address Kiellvale  
18 Reserve Creek Rd ✓

or

Email

Signature Joshua Lee



Notice to Council.

Leave Berkleys Lane Pottsville as it is. Do not develop it into a lead in service rd for the rear of the shopping centre. Also do not remove the Fig Tree in that laneway.

Thank You.

Name ~~D~~ JAVNA FINARDI



Address 181 ZARA ROAD ✓  
HILLINGHAM 2484

or

Email

Signature

A handwritten signature in black ink, appearing to be "J. Finardi", written over a horizontal line.

SN: 2416, 339.

TWEED SHIRE COUNCIL	
FILE No:	INF11 - Pvillec80.
DOC. No:	.....
RECD:	29 AUG 2014
ASSIGNED TO:	Morgan, P
HARD COPY <input type="checkbox"/>	IMAGE <input checked="" type="checkbox"/>

Notice to Council.

Leave Berkleys Lane Pottsville as it is. Do not develop it into a lead in service rd for the rear of the shopping centre. Also do not remove the Fig Tree in that lane way.

Thank You.

SN: 2416, 339.

TWEED SHIRE COUNCIL	
FILE No:	INF11-Puille CBD.
DOC. No:	.....
RECD:	29 AUG 2014
ASSIGNED TO:	Morgan P.
HARD COPY	<input type="checkbox"/>
IMAGE	<input checked="" type="checkbox"/>

Name GINESTRA FINARDI

Address 47 GLORIA ST  
SOUTH GOLDEN BEACH

or  
Email ginestrafindari@gmail.com

Signature 



Notice to Council.

Leave Berkleys Lane Pottsville as it is. Do not develop it into a lead in service rd for the rear of the shopping centre. Also do not remove the Fig Tree in that laneway.

Thank You.

Name GIOVANNI FINARDI

Address 181 Zara Rd  
CHILLINGHAM

SN: 2416, 339.

TWEED SHIRE COUNCIL
FILE No: INF11 - Pville CBD.
DOC. No: .....
REC'D: 29 AUG 2014
ASSIGNED TO: Morgan, P
HARD COPY <input type="checkbox"/> <input checked="" type="checkbox"/>

or  
Email [freshwholefoods@westnet.com.au](mailto:freshwholefoods@westnet.com.au)

Signature Giovanni Finardi



Notice to Council.  
Leave Berkleys Lane Pottsville  
as it is. Do not develop it into  
a lead in service rd for the rear  
of the shopping centre. Also do  
not remove the Fig Tree in that  
lane way.

Thank You.

Name CHERYL ROSENBERG

SN: 2416, 339.  
TWEED SHIRE COUNCIL  
FILE No: INF11-PvilleDBD  
DOC. No: .....  
REC'D: 29 AUG 2014  
ASSIGNED TO: Morgan, J  
HARD COPY  IMAGE

Address 22 TUMBULGUM RD MURWILLUMBAIT ✓

or

Email

Signature *C Rosenberg*



Notice to Council.

Leave Berkleys Lane Pottsville as it is. Do not develop it into a lead in service rd for the rear of the shopping centre. Also do not remove the Fig Tree in that laneway.

Thank You.



Name Ian V Presland

Address 23 Byangum St ✓  
Murbach

or

Email

SN: 2416, 339.

TWEED SHIRE COUNCIL	
FILE No:	INF11 - P.ville CBD.
DOC. No:	.....
RECD:	29 AUG 2014
ASSIGNED TO:	Morgan, P
HARD COPY	<input type="checkbox"/>
IMAGE	<input checked="" type="checkbox"/>

Signature I. V. Presland

# Feedback form

## Pottsville service lane two-way option



At its meeting on 17 July 2014, Council resolved to undertake additional community consultation about the construction of a rear lane off Coronation Avenue, Pottsville, this time with two-way traffic flow.

(In June 2014, Council exhibited and sought public comment on the formation of a rear lane and a proposal to change the traffic flow in Berkleys Lane, the unnamed lane and eastern sports field car park to one-way.)

The proposed works will include the construction of an additional three (3) parallel car parks to the western side of Berkleys Lane, while ensuring an appropriate green buffer to the adjoining residence and adequate vehicle turning paths. It includes the retention of the fig tree in Berkleys Lane.

Your feedback on this form would be appreciated and will be considered as a formal submission. The closing date for submissions has been extended to Thursday 28 June 2014.

You can either submit your comments at this information session or send your submission by the closing date to: General Manager, Tweed Shire Council, PO Box 816, Murwillumbah NSW 2484 or email [tsc@tweed.nsw.gov.au](mailto:tsc@tweed.nsw.gov.au).

Your name: Veriest Serravi

Address: 33 Wollumbin St. ✓

Comments: please leave the tree! And do not develop the lane way! D. Ten



SN: 2416, 339.

TWEED SHIRE COUNCIL	
FILE No:	<u>INF11- Pville CBS.</u>
DOC No:	.....
RECD:	<u>29 AUG 2014</u>
ASSIGNED TO:	<u>Morgan P.</u>
HARD COPY	<input type="checkbox"/>
IMAGE	<input checked="" type="checkbox"/>



# Feedback form

## Pottsville service lane two-way option



At its meeting on 17 July 2014, Council resolved to undertake additional community consultation about the construction of a rear lane off Coronation Avenue, Pottsville, this time with two-way traffic flow.

(In June 2014, Council exhibited and sought public comment on the formation of a rear lane and a proposal to change the traffic flow in Berkleys Lane, the unnamed lane and eastern sports field car park to one-way.)

The proposed works will include the construction of an additional three (3) parallel car parks to the western side of Berkleys Lane, while ensuring an appropriate green buffer to the adjoining residence and adequate vehicle turning paths. It includes the retention of the fig tree in Berkleys Lane.

Your feedback on this form would be appreciated and will be considered as a formal submission. The closing date for submissions has been extended to Thursday 28 June 2014.

You can either submit your comments at this information session or send your submission by the closing date to: General Manager, Tweed Shire Council, PO Box 816, Murwillumbah NSW 2484 or email [tsc@tweed.nsw.gov.au](mailto:tsc@tweed.nsw.gov.au).

Your name: Lightly Sunlight ✓  
Address: 15 Coolidge St, Tyalgum 2484  
Comments: I love that tree. Don't develop the lane way

*Lightly Sunlight*



SN: 2416, 339.

TWEED SHIRE COUNCIL	
FILE No:	<u>INF11-Pottville CBD</u>
DOC. No:	
REC'D:	<u>29 AUG 2014</u>
ASSIGNED TO:	<u>Morgan P.</u>
HARD COPY <input type="checkbox"/>	IMAGE <input checked="" type="checkbox"/>

# Feedback form Pottsville service lane two-way option



At its meeting on 17 July 2014, Council resolved to undertake additional community consultation about the construction of a rear lane off Coronation Avenue, Pottsville, this time with two-way traffic flow.

(In June 2014, Council exhibited and sought public comment on the formation of a rear lane and a proposal to change the traffic flow in Berkleys Lane, the unnamed lane and eastern sports field car park to one-way.)

The proposed works will include the construction of an additional three (3) parallel car parks to the western side of Berkleys Lane, while ensuring an appropriate green buffer to the adjoining residence and adequate vehicle turning paths. It includes the retention of the fig tree in Berkleys Lane.

Your feedback on this form would be appreciated and will be considered as a formal submission. The closing date for submissions has been extended to Thursday 28 June 2014.

You can either submit your comments at this information session or send your submission by the closing date to: General Manager, Tweed Shire Council, PO Box 816, Murwillumbah NSW 2484 or email [tsc@tweed.nsw.gov.au](mailto:tsc@tweed.nsw.gov.au).

Your name: Cate Collier  
Address: 43 Charles St Murbah. ✓  
Comments: Please leave tree alone. Surely there is an alternative. Please do not make lane lead in to service road.  
OK

SN: 2416, 339.

TWEED SHIRE COUNCIL
FILE No: <u>INF11 - P.ville CBD</u>
DOC No: .....
RECD: <u>29 AUG 2014</u>
ASSIGNED TO: <u>Morgan, P.</u>
DUPLICATE COPY <input type="checkbox"/> <input checked="" type="checkbox"/>



# Feedback form

## Pottsville service lane two-way option



At its meeting on 17 July 2014, Council resolved to undertake additional community consultation about the construction of a rear lane off Coronation Avenue, Pottsville, this time with two-way traffic flow.

(In June 2014, Council exhibited and sought public comment on the formation of a rear lane and a proposal to change the traffic flow in Berkleys Lane, the unnamed lane and eastern sports field car park to one-way.)

The proposed works will include the construction of an additional three (3) parallel car parks to the western side of Berkleys Lane, while ensuring an appropriate green buffer to the adjoining residence and adequate vehicle turning paths. It includes the retention of the fig tree in Berkleys Lane.

Your feedback on this form would be appreciated and will be considered as a formal submission. The closing date for submissions has been extended to Thursday 28 June 2014.

You can either submit your comments at this information session or send your submission by the closing date to: General Manager, Tweed Shire Council, PO Box 816, Murwillumbah NSW 2484 or email [tsc@tweed.nsw.gov.au](mailto:tsc@tweed.nsw.gov.au).

Your name: Judith Trezise

Address: 33 George St Murwillumbah ✓

Comments: \_\_\_\_\_

save the fig tree  
don't develop Berkleys Lane  
Pottsville

Judith Trezise



SN: 2416.339.

TWEED SHIRE COUNCIL
FILE No: <u>NE11 Pottsville CBD.</u>
DOC. No: _____
RECD <u>29 AUG 2014</u>
ASSIGNED TO: <u>Morgan P</u>
HARD COPY <input type="checkbox"/> REVIEW <input checked="" type="checkbox"/>

# Feedback form

## Pottsville service lane two-way option



At its meeting on 17 July 2014, Council resolved to undertake additional community consultation about the construction of a rear lane off Coronation Avenue, Pottsville, this time with two-way traffic flow.

(In June 2014, Council exhibited and sought public comment on the formation of a rear lane and a proposal to change the traffic flow in Berkleys Lane, the unnamed lane and eastern sports field car park to one-way.)

The proposed works will include the construction of an additional three (3) parallel car parks to the western side of Berkleys Lane, while ensuring an appropriate green buffer to the adjoining residence and adequate vehicle turning paths. It includes the retention of the fig tree in Berkleys Lane.

Your feedback on this form would be appreciated and will be considered as a formal submission. The closing date for submissions has been extended to Thursday 28 June 2014.

You can either submit your comments at this information session or send your submission by the closing date to: General Manager, Tweed Shire Council, PO Box 816, Murwillumbah NSW 2484 or email [tsc@tweed.nsw.gov.au](mailto:tsc@tweed.nsw.gov.au).

Your name: Michelle Harper

Address: 14 Waterloo Street ✓

Comments: leave Berkleys lane Pottsville as is.

Do not turn into a lead in service road for the rear of the shopping centre. Please also leave the fig tree.

SN: 2416, 339.

TWEED SHIRE COUNCIL
FILE No: <u>NE11 - P.ville CBD</u>
DOC. No: .....
REC'D: 29 AUG 2014
ASSIGNED TO: <u>Morgan, P</u>
HARD COPY <input type="checkbox"/> IMAGE <input checked="" type="checkbox"/>



Notice to Council.

Leave Berkleys Lane Pottsville as it is. Do not develop it into a lead in service rd for the rear of the shopping centre. Also do not remove the Fig Tree in that laneway.

Thank You.

SN: 2416, 339.

TWEED SHIRE COUNCIL	
FILE No:	INF11-P.ville CBD.
DOC. No:	.....
REC'D:	29 AUG 2014
ASSIGNED TO:	Morgan, P
HARD COPY <input type="checkbox"/>	IMAGE <input checked="" type="checkbox"/>

Name CHANTELE LEONARD.  
LEONARD

Address 35 KYOGLE RD.

or

Email



Signature

A handwritten signature in cursive script, appearing to read 'Chantelle Leonard'.

Notice to Council.

Leave Berkleys Lane Pottsville as it is. Do not develop it into a lead in service rd for the rear of the shopping centre. Also do not remove the Fig Tree in that lane way.

Thank You.

Name Lisa Hartshorne.

USA HARTSHORNE

Address

4 Wauwamin St

or

Email rob.duncan@active.net.au

Signature *L Hartshorne*



SN: 2416, 339.

TWEED SHIRE COUNCIL	
FILE No:	INF11-Pville CBD.
DOC. No:	.....
REC'D:	29 AUG 2014
ASSIGNED TO:	Morgan P
HARD COPY <input type="checkbox"/>	IMAGE <input checked="" type="checkbox"/>

Notice to Council.

Leave Berkleys Lane Pottsville as it is. Do not develop it into a lead in service rd for the rear of the shopping centre. Also do not remove the Fig Tree in that laneway.

Thank You.

Name Name Barber: MARIA BARBIERI

Address 5 Brisbane Street Kurwillumbel

or

Email

Signature Maria Barber



SN: 2416, 339.

TWEED SHIRE COUNCIL	
FILE No:	INF11-PVILLE CBD
DOC. No:	.....
REC'D:	29 AUG 2014
ASSIGNED TO:	Morgan, P
HARD COPY	<input type="checkbox"/>
IMAGE	<input checked="" type="checkbox"/>

Notice to Council.  
Leave Berkleys Lane Pottsville  
as it is. Do not develop it into  
a lead in service rd for the rear  
of the shopping centre. Also do  
not remove the Fig Tree in that  
lane way.

Thank You.

Name KER RIPPIN

SN: 2416, 339.  
TWEED SHIRE COUNCIL  
FILE No: NEU - Pville CBD.  
DOC. No: .....  
REC'D. 29 AUG 2014  
ASSIGNED TO: Morgan, P  
HARD COPY  IMAGE

Address 5 BRISBANE STREET MURKILLURBAH

or

Email

Signature

~~Ken~~ Ken Rippin





Notice to Council.

Leave Berkleys Lane Pottsville as it is. Do not develop it into a lead in service rd for the rear of the shopping centre. Also do not remove the Fig Tree in that laneway.

Thank You.

Name Susan Neville



Address 284 Marine Pde Kingscliff

or

Email

Signature

SN: 2416, 339.

TWEED SHIRE COUNCIL
FILE No: INF.11 - P.villeced.
DOC. No: .....
REC'D 29 AUG 2014
ASSIGNED TO: Morgan, P
HARD COPY <input type="checkbox"/> IMAGE <input checked="" type="checkbox"/>

Notice to Council.

Leave Berkleys Lane Pottsville as it is. Do not develop it into a lead in service rd for the rear of the shopping centre. Also do not remove the Fig Tree in that laneway.

Thank You.

Name Robert Anderson



Address

or

Email

rivermanau@yahoo.com.au

Signature

SN: 2416, 339.

TWEED SHIRE COUNCIL	
FILE No:	INF11- Pville000
DOC. No:	
REC'D	29 AUG 2014
ASSIGNED TO:	morgan, p
HARD COPY	<input type="checkbox"/>
IMAGE	<input checked="" type="checkbox"/>

Notice to Council.

Leave Berkleys Lane Pottsville as it is. Do not develop it into a lead in service rd for the rear of the shopping centre. Also do not remove the Fig Tree in that laneway.

Thank You.

Name S. Henderson

Address Terranora

or

Email M'Ba tafe.

Signature



SN: 2416, 339.

TWEED SHIRE COUNCIL  
FILE No: INF11 - Pvillec30.

DOC. No: .....

REC'D. 29 AUG 2014

ASSIGNED TO: Morgan P

HARD COPY  IMAGE

Notice to Council.

Leave Berkleys Lane Pottsville as it is. Do not develop it into a lead in service rd for the rear of the shopping centre. Also do not remove the Fig Tree in that laneway.

Thank You.

Name Reberan Hesse



Address Food works Murwillumbah.

2484

or

Email

Signature

A handwritten signature in dark ink, appearing to read "Reberan Hesse".

SN: 2416, 339.

TWEED SHIRE COUNCIL	
FILE No:	INF11 - Pvillecbd
DOC. No:	.....
REC'D.	29 AUG 2014
ASSIGNED TO:	Morgan, P
HARD COPY	<input type="checkbox"/>
IMAGE	<input checked="" type="checkbox"/>

Notice to Council.

Leave Berkleys Lane Pottsville as it is. Do not develop it into a lead in service rd for the rear of the shopping centre. Also do not remove the Fig Tree in that laneway.

Thank You.

Name Reyman Gill

Address

or

Email gillreyman@gmail.com

Signature 

SN: 2416, 339.

TWEED SHIRE COUNCIL
FILE No: INF11 - Pville CBD.
DOC. No: .....
REC'D. 29 AUG 2014
ASSIGNED TO: Morgan P
HARD COPY <input type="checkbox"/> IMAGE <input checked="" type="checkbox"/>



Notice to Council.

Leave Berkleys Lane Pottsville as it is. Do not develop it into a lead in service rd for the rear of the shopping centre. Also do not remove the Fig Tree in that laneway.

Thank You.

Name N. SHOEMAN

SN: 2416, 339.  
TWEED SHIRE COUNCIL  
FILE No: INF11 - Pville CBD.  
DOC. No: .....  
RECD. 29 AUG 2014  
ASSIGNED TO: Morgan, P.  
HARD COPY  IMAGE

Address

or

Email N.SHOEMAN@gmail.com



Signature 

Notice to Council.

Leave Berkleys Lane Pottsville as it is. Do not develop it into a lead in service rd for the rear of the shopping centre. Also do not remove the Fig Tree in that laneway.

Thank You.

SN: 2416, 339.  
TWEED SHIRE COUNCIL  
FILE No: INFIL - P. villecbo.  
DOC. No: .....  
RECD. 29 AUG 2014  
ASSIGNED TO: Morgan P  
HARD COPY  IMAGE

Name NERILLI Francesco

Address 3 Quigan st. Kingscliff

or  
Email freshwholefoods@westnet.com.au

Signature *Nerilli Francesco*



Notice to Council.

Leave Berkleys Lane Pottsville as it is. Do not develop it into a lead in service rd for the rear of the shopping centre. Also do not remove the Fig Tree in that laneway.

Thank You.

Name Sarah Bergquist

SN: 2416, 339.

TWEED SHIRE COUNCIL
FILE No: <u>INF11 - Pvillecbd.</u>
DOC. No: .....
REC'D. 29 AUG 2014
ASSIGNED TO: <u>morgan.p</u>
HARD COPY <input type="checkbox"/> IMAGE <input checked="" type="checkbox"/>

Address ~~991~~ P/O Box 991  
Murwillumbah

or

Email

Signature 





Notice to Council.

Leave Berkleys Lane Pottsville as it is. Do not develop it into a lead in service rd for the rear of the shopping centre. Also do not remove the Fig Tree in that laneway.

Thank You.

Name Jake Maloney

SN: 2416, 339.  
TWEED SHIRE COUNCIL  
FILE No. INE11 - P.ville CBD.  
DOC. No. ....  
REC'D. 29 AUG 2014  
ASSIGNED TO: Morgan, P  
HARD COPY  IMAGE

Address

or

Email cadillac-rockers@hotmail.com

Signature



Notice to Council.  
Leave Berkleys Lane Pottsville  
as it is. Do not develop it into  
a lead in service rd for the rear  
of the shopping centre. Also do  
not remove the Fig Tree in that  
lane way.

Thank You.

SN: 2416, 339.  
TWEED SHIRE COUNCIL  
FILE No: INF11 - Pville CBD.  
DOC. No: .....  
REC'D. 29 AUG 2014  
ASSIGNED TO: Morgan, P  
HARD COPY  IMAGE

Name SAUL ROBERTSON

Address COUNTRY SIDE DRG.  
MURKUMBA UNBATH.

or

Email

Signature 



Notice to Council.

Leave Berkleys Lane Pottsville as it is. Do not develop it into a lead in service rd for the rear of the shopping centre. Also do not remove the Fig Tree in that laneway.

Thank You.

Name DARIO Squilloni



Address KRISHNA FARM, 525 TYALGUN ROAD, EUNGELLA

or

Email D,

SN: 2416, 339.

TWEED SHIRE COUNCIL  
FILE No: INF11-PVILLECBD.

DOC. No: .....

RECD 29 AUG 2014

ASSIGNED TO: morgan, p

HARD COPY  IMAGE

Signature Dario Squilloni

Notice to Council.

Leave Berkleys Lane Pottsville as it is. Do not develop it into a lead in service rd for the rear of the shopping centre. Also do not remove the Fig Tree in that laneway.

Thank You.

Name BEN COLEY



Address 46 GRASS TREE CABARITA 2488

or

Email

SN: 2416, 339.

TWEED SHIRE COUNCIL	
FILE No.	INF11-Pottville CBD.
DOC. No.	.....
REC'D:	29 AUG 2014
ASSIGNED TO:	Morgan, P.
HARD COPY	<input type="checkbox"/>
IMAGE	<input checked="" type="checkbox"/>

Signature

A handwritten signature in black ink, appearing to be 'Ben Coley'.

Notice to Council.

Leave Berkleys Lane Pottsville as it is. Do not develop it into a lead in service rd for the rear of the shopping centre. Also do not remove the Fig Tree in that laneway.

Thank You.

Name LAWRENCE PANKHURST



Address

or

Email pankhurstlawrence790@GMAIL.COM

Signature

A handwritten signature in blue ink, appearing to be 'Lawrence Pankhurst'.

SN: 2416, 339.

TWEED SHIRE COUNCIL
FILE No: INF11-Pville080.
DOC. No: .....
RECD 29 AUG 2014
ASSIGNED TO: Morgan P
HARD COPY <input type="checkbox"/> IMAGE <input checked="" type="checkbox"/>

Notice to Council.

Leave Berkleys Lane Pottsville as it is. Do not develop it into a lead in service rd for the rear of the shopping centre. Also do not remove the Fig Tree in that laneway.

Thank You.

Name Tony BAULMAN



Address

or

Email tbaulman@yahoo.com.au

Signature A Baulman

SN: 2416, 339.

TWEED SHIRE COUNCIL	
FILE No:	NEU-Pottle CBD.
DOC. No:	.....
RECD	29 AUG 2014
ASSIGNED TO:	Morgan, P
HARD COPY <input type="checkbox"/>	IMAGE <input checked="" type="checkbox"/>

Notice to Council.

Leave Berkleys Lane Pottsville as it is. Do not develop it into a lead in service rd for the rear of the shopping centre. Also do not remove the Fig Tree in that laneway.

Thank You.

Name <sup>JEANNIE PEASCOO</sup>  
J. Pearcoal



Address 293 Limpanwood Rd.

or

Email jeanniebel3@harbooursat.com.au

Signature *J. Pearcoal*

SN: 2416, 339.

TWEED SHIRE COUNCIL
FILE No: INF11 - Pville CBD
DOC. No: .....
RECD. 29 AUG 2014
ASSIGNED TO: Morgan, P
HARD COPY <input type="checkbox"/> IMAGE <input checked="" type="checkbox"/>

Notice to Council.  
Leave Berkleys Lane Pottsville  
as it is. Do not develop it into  
a lead in service rd for the rear  
of the shopping centre. Also do  
not remove the Fig Tree in that  
lane way.

Thank You.

SN: 2416, 339.  
TWEED SHIRE COUNCIL  
FILE No: INF11- Pville CBD.  
DOC. No: .....  
REC'D: 29 AUG 2014  
ASSIGNED TO: morgan  
HARD COPY  IMAGE

Name

Malinda McAndrew

Address

kiraah@hotmail.com.au.

or

Email

Signature





Notice to Council.

Leave Berkleys Lane Pottsville as it is. Do not develop it into a lead in service rd for the rear of the shopping centre. Also do not remove the Fig Tree in that laneway.

Thank You.

Name Karalee Berry



Address 120 Byangum Road, Murwillumbah

or

Email

Signature 

SN: 2416, 339.

TWEED SHIRE COUNCIL	
FILE No:	INF11-Pville CBD.
DOC. No:	.....
REC'D:	29 AUG 2014
ASSIGNED TO:	Morgan P
HARD COPY <input type="checkbox"/>	IMAGE <input checked="" type="checkbox"/>

Notice to Council.

Leave Berkleys Lane Pottsville as it is. Do not develop it into a lead in service rd for the rear of the shopping centre. Also do not remove the Fig Tree in that laneway.

Thank You.

Name Wayne Lewis

SN: 2416, 339.  
TWEED SHIRE COUNCIL  
FILE No: INF11-Pville CBD.  
DOC. No: .....  
REC'D: 29 AUG 2014  
ASSIGNED TO: Morgan J  
HARD COPY  IMAGE

Address

or

Email wkLewis1@hotmail.com

Signature

W Lewis



Notice to Council.  
Leave Berkleys Lane Pottsville  
as it is. Do not develop it into  
a lead in service rd for the rear  
of the shopping centre. Also do  
not remove the Fig Tree in that  
lane way.

Thank You.

Name *Jeff Rice*  
169 NORTH ARM ROAD.

SN: 2416, 339.  
TWEED SHIRE COUNCIL  
FILE No: *INF11 - P.ville CBD.*  
DOC. No: .....  
REC'D: 29 AUG 2014  
ASSIGNED TO: *Morgan, P.*  
HARD COPY

Address 63 Wallerbin St M Bah

or

Email

Signature *[Signature]*



Notice to Council.

Leave Berkleys Lane Pottsville as it is. Do not develop it into a lead in service rd for the rear of the shopping centre. Also do not remove the Fig Tree in that laneway.

Thank You.

Name Rosemary Wood



Address

or

Email rosiewood@dada.com.au

Signature

A handwritten signature in black ink, appearing to read 'Rosemary Wood'.

SN: 2416, 339.

TWEED SHIRE COUNCIL	
FILE No:	INF11- Pvillec80.
DOC. No:	.....
REC'D.	29 AUG 2014
ASSIGNED TO:	Morgan, P
HARD COPY	<input type="checkbox"/>
IMAGE	<input checked="" type="checkbox"/>

## Sandra Zietlow

---

**From:** Pottsville Community Association [pottsville2011@gmail.com]  
**Sent:** Thursday, 28 August 2014 3:56 PM  
**To:** Corporate Email  
**Subject:** Submission re Service Rd

Dear Mr Green,

At our general meeting of August 26th, 2014, after much discussion, a 57% majority vote of members present resolved the following to be included in a submission from the Pottsville Community Association in regards to the exhibition of the current 2-way proposal for Berkleys lane/ Service Lane:

1. Support for a two way option.
2. Support for the recommendations made by the Local Traffic Committee
3. Support for removal of the tree in Berkleys Lane if the two way option goes ahead
4. Support for kerbing and guttering along the southern side of the new lane behind the current Coronation Ave shops to be installed
5. Request for traffic calming devices to be installed in the new laneway to reduce the use of the area for anti-social hooning activity.

Members recognised the removal of the tree in Berkleys Lane is likely not in Council control if it is federally or state protected.

Please note: Members were advised at the meeting that the IGA entrance would be being kept open in a one-way configuration when the Service road was installed and members based their voting on this assumption.

Regards

Chris Cherry  
President  
Pottsville Community Association

Notice to Council.

Leave Berkleys Lane  
Pottsville alone. Do not  
develop it into a lead in  
service Rd for the rear  
of the Shopping Centre.  
Also do not remove the  
Fig Tree.

51:2416, 339

TWEED SHIRE COUNCIL	
FILE No:	WHI - PUNE 080
DOC. No:	
RECD:	28 AUG 2014
ASSIGNED TO:	MOCUAS.P
HARD COPY	<input type="checkbox"/>
IMAGE	<input checked="" type="checkbox"/>

Signed Dean Whalan  
A Whalan

Dated August

Address 27 Macadamia DR  
or Pottsville  
Phone number

# POTTSVILLE COMMUNITY ASSOCIATION INC

PO BOX 56  
POTTSVILLE BEACH, NSW, 2489

25th June, 2014

General Manager &  
Honorable Councilors  
Tweed Shire Council Chambers  
MURWILLUMBAH NSW 2489

Dear General Manager and Honorable Councilors,

At the the recent meeting of the Pottsville Community Association held on Tuesday 24th June, 2014 a lengthy discussion was held regarding the Service Road at the rear of the shops in Coronation Avenue. Following this the PCA, based on the Traffic Management Committee representation, would support a two-way service road all the way and that Berkleys Lane remain two-way subject to further public display and consultation for 28 days.

Yours faithfully,

John Wightman  
Vice-President,  
Pottsville Community Association

# Feedback form

## Pottsville service lane two-way option



At its meeting on 17 July 2014, Council resolved to undertake additional community consultation about the construction of a rear lane off Coronation Avenue, Pottsville, this time with two-way traffic flow.

(In June 2014, Council exhibited and sought public comment on the formation of a rear lane and a proposal to change the traffic flow in Berkleys Lane, the unnamed lane and eastern sports field car park to one-way.)

The proposed works will include the construction of an additional three (3) parallel car parks to the western side of Berkleys Lane, while ensuring an appropriate green buffer to the adjoining residence and adequate vehicle turning paths. It includes the retention of the fig tree in Berkleys Lane.

Your feedback on this form would be appreciated and will be considered as a formal submission. The closing date for submissions has been extended to Thursday 28 June 2014.

You can either submit your comments at this information session or send your submission by the closing date to: General Manager, Tweed Shire Council, PO Box 816, Murwillumbah NSW 2484 or email [tsc@tweed.nsw.gov.au](mailto:tsc@tweed.nsw.gov.au).

55. 2416, 339.

FILE No: INF1 - PUNE CBO
DGC No: .....
REC'D: 27 AUG 2014
ASSIGNED TO: MOLLAY P
HARD COPY: .....

Your name: Iris Howell

Address: 4 Philip St Pottsville

Comments: I think the proposal for Pottsville commercial area should be endorsed by residents as it is obvious that council has paid a lot of attention to the problems presently being experienced by the community and has come up with a sound resolution.

This proposal has my support.

I Howell



# Feedback form

## Pottsville service lane two-way option



At its meeting on 17 July 2014, Council resolved to undertake additional community consultation about the construction of a rear lane off Coronation Avenue, Pottsville, this time with two-way traffic flow.

(In June 2014, Council exhibited and sought public comment on the formation of a rear lane and a proposal to change the traffic flow in Berkleys Lane, the unnamed lane and eastern sports field car park to one-way.)

The proposed works will include the construction of an additional three (3) parallel car parks to the western side of Berkleys Lane, while ensuring an appropriate green buffer to the adjoining residence and adequate vehicle turning paths. It includes the retention of the fig tree in Berkleys Lane.

Your feedback on this form would be appreciated and will be considered as a formal submission. The closing date for submissions has been extended to Thursday 28 June 2014.

You can either submit your comments at this information session or send your submission by the closing date to: General Manager, Tweed Shire Council, PO Box 816 Murwillumbah, NSW 2484 or email [tsc@tweed.nsw.gov.au](mailto:tsc@tweed.nsw.gov.au).

SJ: 2416,339

Box 816 Murwillumbah
FILE No: 251 - PHILIP CBD
DOC. No: .....
RECE 27 AUG 2014

Your name: PETER HOWELL

Address: 4 PHILIP ST POTTSVILLE 2484

Comments: I wish to express my strong support for the council's proposal for the CBD at Pottsville.

I was given this form at the meeting in Pottsville on 20-8-14 at Neighbourhood Centre.

The proposal addresses all major issues and will alleviate many problems that are being experienced at present.

Congratulations to those who worked out this proposal, and I hope it goes ahead with no further worries. Thank you.

Peter Howell

# Feedback form

## Pottsville service lane two-way option



At its meeting on 17 July 2014, Council resolved to undertake additional community consultation about the construction of a rear lane off Coronation Avenue, Pottsville, this time with two-way traffic flow.

(In June 2014, Council exhibited and sought public comment on the formation of a rear lane and a proposal to change the traffic flow in Berkleys Lane, the unnamed lane and eastern sports field car park to one-way.)

The proposed works will include the construction of an additional three (3) parallel car parks to the western side of Berkleys Lane, while ensuring an appropriate green buffer to the adjoining residence and adequate vehicle turning paths. It includes the retention of the fig tree in Berkleys Lane.

Your feedback on this form would be appreciated and will be considered as a formal submission. The closing date for submissions has been extended to Thursday 28 ~~June~~ August 2014.

You can either submit your comments at this information session or send your submission by the closing date to: General Manager, Tweed Shire Council, PO Box 816, Murwillumbah NSW 2484 or email [tsc@tweed.nsw.gov.au](mailto:tsc@tweed.nsw.gov.au).

Your name: ANNE HONEYMAN

Address: 21/19-27 Elizabeth St, (P.O. Box 95) Pottsville. 2489.

Comments: \_\_\_\_\_

Please find enclosed my FEEDBACK in the form of a letter to The General Manager.

A. Honeyman

12/11 - POTTSVILLE CRO .

TWEED SHIRE COUNCIL	
FILE No:	SS: 2416, 339
DGC. No:	.....
RECD:	25 AUG 2014
ASSIGNED TO:	MORRIS, P
HARD COPY <input type="checkbox"/>	IMAGE <input checked="" type="checkbox"/>

# Feedback form

## Pottsville service lane two-way option



At its meeting on 17 July 2014, Council resolved to undertake additional community consultation about the construction of a rear lane off Coronation Avenue, Pottsville, this time with two-way traffic flow.

(In June 2014, Council exhibited and sought public comment on the formation of a rear lane and a proposal to change the traffic flow in Berkleys Lane, the unnamed lane and eastern sports field car park to one-way.)

The proposed works will include the construction of an additional three (3) parallel car parks to the western side of Berkleys Lane, while ensuring an appropriate green buffer to the adjoining residence and adequate vehicle turning paths. It includes the retention of the fig tree in Berkleys Lane.

Your feedback on this form would be appreciated and will be considered as a formal submission. The closing date for submissions has been extended to Thursday 28 June 2014.

You can either submit your comments at this information session or send your submission by the closing date to: General Manager, Tweed Shire Council, PO Box 816, Murwillumbah, NSW 2484 or email [tsc@tweed.nsw.gov.au](mailto:tsc@tweed.nsw.gov.au).

INFIL - POTTSVILLE CBD  
FILE NO: 2416 + 339  
REC'D: 22 AUG 2014  
ASSIGNED TO: Morgan P.  
PHOTO COPY  IMAGE

Your name: GRAHAM POPTIE

Address: 8 WARNE PLACE POTTSVILLE

Comments: I like the two way traffic  
flow, get rid of the tree it  
creates a dangerous squeeze, and  
I am happy to hear the I.G.A  
entrance on coronation ave, also  
keep the right hand turn at the  
car park at the eastern end car  
park and don't clog the through  
traffic on the roundabout.  
calming devices in the lane please

# Feedback form Pottsville service lane two-way option



At its meeting on 17 July 2014, Council resolved to undertake additional community consultation about the construction of a rear lane off Coronation Avenue, Pottsville, this time with two-way traffic flow.

(In June 2014, Council exhibited and sought public comment on the formation of a rear lane and a proposal to change the traffic flow in Berkleys Lane, the unnamed lane and eastern sports field car park to one-way.)

The proposed works will include the construction of an additional three (3) parallel car parks to the western side of Berkleys Lane, while ensuring an appropriate green buffer to the adjoining residence and adequate vehicle turning paths. It includes the retention of the fig tree in Berkleys Lane.

Your feedback on this form would be appreciated and will be considered as a formal submission. The closing date for submissions has been extended to Thursday 28 June 2014.

You can either submit your comments at this information session or send your submission by the closing date to: General Manager, Tweed Shire Council, PO Box 816, Murwillumbah NSW 2484 or email [tsc@tweed.nsw.gov.au](mailto:tsc@tweed.nsw.gov.au).

Inst 11 - Pottsville CBO Lane  
Municipality: Murwillumbah  
File No: 2416-330  
DOC. No: .....  
REC'D: 22 AUG 2014  
ASSIGNED TO: Morgan P  
IMAGE

Your name: ROGER McNEED  
Address: 1 CORONATION AVENUE POTTSVILLE

Comments: IT SEEMS THAT THE GENERAL OPINION OF PEOPLE AT THE INFORMATION MEETING FELT IT WAS VERY NECESSARY TO REMOVE THE FIG TREE BASED ON A TWO WAY OPTION. I AM SURE THE COUNCIL OFFICERS OBSERVED THIS GENERAL DIRECTION BY THE MAJORITY OF PEOPLE THAT WERE THERE ON THE 20TH OF AUGUST 2014 MEETING

# Feedback form

## Pottsville service lane two-way option



At its meeting on 17 July 2014, Council resolved to undertake additional community consultation about the construction of a rear lane off Coronation Avenue, Pottsville, this time with two-way traffic flow.

(In June 2014, Council exhibited and sought public comment on the formation of a rear lane and a proposal to change the traffic flow in Berkleys Lane, the unnamed lane and eastern sports field car park to one-way.)

The proposed works will include the construction of an additional three (3) parallel car parks to the western side of Berkleys Lane, while ensuring an appropriate green buffer to the adjoining residence and adequate vehicle turning paths. It includes the retention of the fig tree in Berkleys Lane.

Your feedback on this form would be appreciated and will be considered as a formal submission. The closing date for submissions has been extended to Thursday 28 June 2014.

You can either submit your comments at this information session or send your submission by the closing date to: General Manager, Tweed Shire Council, PO Box 816, Murwillumbah NSW 2484 or email [tsc@tweed.nsw.gov.au](mailto:tsc@tweed.nsw.gov.au).

Your name: DAVID LUCAS  
Address: 4 MELBA CLOSE POTTSVILLE  
Comments: KEEPING THE TREE IN BERKLEY'S  
LANE NEXT TO THE CHURCH IS LUDICROUS  
GIVEN BERKLEY'S LANE BECOMES  
TWO WAY.  
NEGOTIATE WITH THE CHURCH SO  
THE TREE CAN BE REMOVED & A  
SUITABLE ONE TO REPLACE IT BE  
PLANTED CLOSER TO THE CHURCH  
REMOVING THE ROAD WAY OBSTRUCTION  
TO BE CAUSED BY THE EXISTING TREE

TWEED SHIRE COUNCIL	
FILE No: <u>S/S: 2416 339</u>	
DOC. No: .....	
REC'D: <b>22 AUG 2014</b>	
ASSIGNED TO: <u>Morgan P</u>	
HARD COPY <input type="checkbox"/>	IMAGE <input checked="" type="checkbox"/>

INFU PIVILLE  
CSD LANE  
*Lucas*

# Feedback form

## Pottsville service lane two-way option



At its meeting on 17 July 2014, Council resolved to undertake additional community consultation about the construction of a rear lane off Coronation Avenue, Pottsville, this time with two-way traffic flow.

(In June 2014, Council exhibited and sought public comment on the formation of a rear lane and a proposal to change the traffic flow in Berkleys Lane, the unnamed lane and eastern sports field car park to one-way.)

The proposed works will include the construction of an additional three (3) parallel car parks to the western side of Berkleys Lane, while ensuring an appropriate green buffer to the adjoining residence and adequate vehicle turning paths. It includes the retention of the fig tree in Berkleys Lane.

Your feedback on this form would be appreciated and will be considered as a formal submission. The closing date for submissions has been extended to Thursday 28 June 2014.

You can either submit your comments at this information session or send your submission by the closing date to: General Manager, Tweed Shire Council, PO Box 816, Murwillumbah NSW 2484 or email [tsc@tweed.nsw.gov.au](mailto:tsc@tweed.nsw.gov.au).

Your name: RUTH CLARKE

Address: P.O. BOX 228, POTTSVILLE.

Comments: PLEASE REMOVE FIG TREE TO

MAKE WAY FOR A BETTER TRAFFIC

FLOW AND ACCESS TO CHURCH CAR PARK.

ALSO TRAFFIC COMING OUT OF ROAD

NEAR REAL ESTATE - LEFT HAND TURN

ONLY & USE ROUND-A-BOUNT TO REENTER

CORONATION AVE. BETTER TRAFFIC FLOW

INFILE: POTTVILLE USD LANE

TWEED SHIRE COUNCIL	
FILE No:	Sus: 2416. 33?
DOC. No:	
REC'D:	22 AUG 2014
ASSIGNED TO:	M. CLARKE
HARD COPY	<input type="checkbox"/>
IMAGE	<input checked="" type="checkbox"/>

**Sandra Zietlow**

---

**From:** Bruce Cumming [bcumm55@gmail.com]  
**Sent:** Wednesday, 6 August 2014 9:11 PM  
**To:** Corporate Email  
**Subject:** Pottsville Service Road

General Manager

Tweed Shire Council

Civic Centre

Murwillumbah NSW

Via Email , [tsc@tweed.nsw.gov.au](mailto:tsc@tweed.nsw.gov.au)

7 August 2014

Reference: Proposed service road - Pottsville commercial district

Dear Sir

I make this submission as a Pottsville resident home owner for consideration by Council's in their planning for this new roadwork project, which by my understanding is intended to mitigate the increasingly heavy flow of commercial vehicles in Coronation Avenue, which I conditionally support.

**The specific area of my concern with this project is within Berkley's Lane.**

For this project to operate safely and efficiently the proposed new roadwork configuration should not be impeded by the obstruction of the existing trees and garden surrounds in Berkley's Lane.

If a one-way service road is contemplated these obstructions to the increased traffic flow in Berkley's lane would be marginal at best however as it would seem more functional to make this

new road “two-way”, Berkley's lane must be cleared of this potential bottleneck and widened over its full length to preserve much needed parking space and a safe traffic flow

It does not please me to suggest these trees be removed but under these exceptional circumstances I have serious doubts this project would be worthy of undertaking without this sacrifice.

**Bruce Cumming**

2/45 Mylestom Circle Pottsville NSW 2489



**18<sup>th</sup> of August 2014**

General Manager &  
Honorable Councilors  
Tweed Shire Council

MURWILLUMBAH NSW 2484

Dear General Manager & Honorable Councilors,

***Amended Submission:***

**Re: Berkley's Lane Service Road Pottsville NSW 2489**

In relation to the above matter and Tweed Shire Councilors option/resolution, I make the following points and submission for your consideration and reply based on the most recent meetings with the Pottsville commercial property owners.

Tweed Civic Centre: **15<sup>th</sup> November 2013** General Manager and council officers.

Murwillumbah Councils Offices: **28<sup>th</sup> March 2014** General Manager and Council officers.

Pottsville Community Hall: **29<sup>th</sup> April 2014** General Manager and Council Officers.

At the last meeting on the 29<sup>th</sup> a **(one & two - way service road)** was discussed and the Council engineers plans were viewed, and the majority preferred the **(two-way option)** for the commercial property owners & private enterprise funding road contribution. The General Manager suggested that the laneway be constructed and allow to operate for three months prior to determining best traffic flow direction – suggesting that the owners come back to council with their suggestions following the laneway being in place.

The general community at large, being the most important consideration in relation to this fundamental infrastructure project, the following points are:

**Community Safety**  
**Community Amenity**  
**Community Practicality**  
**Traffic Flow Management**  
**Commercial & Environmental Reality**  
**Future Planning**

The community since 1996 has & still supports a **(one & two-way service road.)** The previous Engineer / General Manager Mike Rayner agreed that the parking area at the eastern end, be two way therefore providing amenity and easy access without putting heavier traffic flows in the main street.

Please review & consider the mentioned point summary as provided:

**Community Safety** - There are five driveways that cross the pedestrian footpath in the commercial precinct on the northern side of Coronation Avenue Pottsville. In an independent safety audit report, these driveways have been classified as a medium collision hazard. The intersection and driveway at the IGA super market being extremely hazardous and should be a priority safety consideration.

**Community Amenity** - There are two sporting organizations/clubs and bi-weekly Pottsville Markets, that use the recreation area adjacent to the **(two -way car park)** being Pottsville Tennis Club & Pottsville AFL Club and the Pottsville RSL memorial oval is widely used by the local/general & visiting community on a daily basis.

**Community Practicality** - There are three residential estates/precincts - Koala Beach, North Pottsville Beach & Pottsville Waters / Black Rocks and two Council caravan parks. These residents from the North, East and South direction use the Tweed Coast Road & Overall Drive to access the **(two-way car parking area)** at the eastern end of Coronation Avenue and Phillip Street to do their day to day business and walk down the street, then go back to their vehicles, turn around and proceed back to their respective residential areas, the *status quo/existing use rights for over 50 years would remain* with a **(two-way option to the car parking at the eastern end)** this relating to the existing businesses without congesting the traffic flow in the main street by driving all those extra local & visiting vehicles west through the main street being Coronation Avenue Pottsville.

**Traffic Flow Management** - Simply by directing the local residents from all of the previously mentioned areas /estates west through the main street Coronation Avenue Pottsville, for no apparent reason, **(the one only-way option)** not only contradicts the reason for a service road behind the main commercial precinct, this **(the one only -way option)** is without doubt illogical and represents a very poor planning measure. This option because there is no traffic management provision for a round about/ road widening on Coronation Avenue etc, at the Berkley's Lane western entry point to provide for the extra volumes of traffic, undoubtedly is unnecessary and will create a massive traffic jam for turning right and westerly traffic turning left vehicles into Berkley's Lane, therefore the already hazardous traffic conditions would be heavily compounded at the western end of the commercial precinct, this is not sensible traffic management route planning.

**Commercial & Environmental Reality** - There are no required removal of existing fig trees or any other trees along the entire **(One & two -way service road)** construction/route, accept one tree that happens to be in the middle of a designated public road as provided & recognized in the existing Tweed Shire Council Engineered Construction Plans. A delivery vehicle restriction (notice/signage) **20km speed limit** signage should be considered .There is a large roundabout at the eastern end to regulate the traffic flow supporting the **(two -way option all the way) e.g.** no right turn eastern end.

**Future Planning** - The purchase of this land and public road declaration has been a real positive initial step forward for the business community and the general public, which supports the original Pottsville Beach Village Strategy Plan and offers with proper planning, a real alternative for the local & visiting traffic management and car parking infrastructure requirements into the future.



Yours sincerely

Roger Allan McLeod

Director / Licensee Pottsville Properties Pty Ltd

0418 752 343 - rog@pottsvillebeachrealestate.com.au

Resident - 25 years & Business & Commercial Property Owner - 20 years.

**Note: Name Submission - Berkley's Lane and or McLeod's Road.**

**Annexure:** Optimum result / option **(two - way all the way)**

Based on the recent Tweed Shire Councils Traffic Management Committee Meeting on Thursday the **12<sup>th</sup> of June 2014** and recommendations by the RMS representative and Tweed Shire Council engineers recent advice with proper road construction & signage the **(two - way all the way option)** will solve the four main problems being congested traffic flows in coronation avenue, commercial driveways over main street pedestrian footpaths, large delivery trucks / heavy vehicle traffic and car parking issues. This option, I suggest would now receive the vast majority of support from the General Community, Pottsville Community Association, Pottsville Business Association and the adjoining Commercial Property Owners.

Also at a well-attended meeting of the Pottsville Community Association held on the **24<sup>th</sup> of June 2014** there was support by the overwhelming majority for a **(Two -way all the way option)** and the Pottsville Business Chamber President addressed the meeting and fully support this option.



**TEAM KOALA** inc  
FOR KOALAS ON THE TWEED  
P: 02 6672 7312  
❖ [teamkoala144@gmail.com](mailto:teamkoala144@gmail.com)

126 Tyalgum Rd

Eungella NSW 2484

12<sup>th</sup> August 2014

TO: The General Manager

Tweed Shire Council

PO Box 816

MURWILLUMBAH NSW 2484

**Re: SUBMISSION - Formation of Rear Lane and Two-way Traffic Flow in Berkleys Lane and Eastern Sports Field Car Park - Coronation Avenue Pottsville**

Dear General Manager,

Team Koala wish to express their concerns regarding lack of koala protection mechanisms in the design of the proposed service road behind the Pottsville shops. They wish to draw your attention to the information below extracted from the Tweed Coast Koala Habitat Study 2011, which documents significant koala activity in the area, koala mortality statistics and recommended ameliorative measures to protect them:

- **Figure 4.5:** Potential koala habitat map and **Figure 5.3b:** Koala mortality black spots and koala records along major roads indicate that the area adjacent to Berkleys Lane and the service road is categorised as Secondary A Koala Habitat. This habitat and koala corridor have recently been strengthened with primary koala food tree plantings under the Koala Connections Project.
- **Figure 3.1:** Location of active and inactive field sites indicates an active field site near Berkleys Lane.
- **Figure 3.2:** Indicative metapopulation boundaries (source populations) indicates significant koala activity in the area adjacent to Berkleys Lane.
- **Figure 5.1:** Indicative linkage areas indicates a linkage corridor that crosses Coronation Avenue in the area adjacent to Berkleys Lane that is used by the Koala Beach koala population (north of Coronation Avenue) and the Pottsville Wetland koala population (south of Coronation Avenue).
- **Figure 5.3a:** Koala mortality black spots and koala records along major roads indicates the section of Coronation Avenue that is intersected by Berkleys Lane as being located within a section of the road identified as a koala mortality black spot. It also indicates that there have been koala sightings recorded along Coronation Avenue not far to the west of the Berkleys Lane intersection.
- **Page 51:** Speed limits on the approach to Pottsville drop from 80km/h at Cudgera Creek Road to 60km/h at Seabreeze Estate then to 40km/h at Coronation Avenue. The vegetation abutting the road in the east provides the only linkage in the locality for provision of north south connectivity. Thus, any provision for ameliorative measures should be at this location where the road passes through potential koala habitat for a distance of 600- 700m. Tweed Coast.

Team Koala also wishes to draw your attention to the following extract from the Pottsville CBD Lane Construction Review of Environmental Factors:

- **Table 5.1:** Project environmental impact types, their likelihood and impact mitigation measures - 'Likely Impact' (page 25): The expected increased traffic movements along the lane would increase the vehicle strike hazard for fauna.

#### COMMENTS BY TEAM KOALA

The opening of Berkleys Lane to through traffic will shift the koala mortality black spot along Coronation Avenue (refer TCKHS Figure 5.3a) to the footprint of the lane way which is closer to the Secondary Koala habitat, the recently planted koala food trees (refer Koala Connections Project) and the Koala Corridor identified in TCKHS Figure 5.1. TCKHS Figure 3.2 also shows significant koala activity adjacent to Berkleys Lane. indicates that impact mitigation measures rely only on a lowering of traffic speed to address this increased threat to koala survival.

#### RECOMMENDATIONS BY TEAM KOALA

As Team Koala believes that the lowering of traffic speed as the only ameliorative measure is inadequate, Team Koala calls for the construction of a koala-proof fence to isolate koala habitat adjacent to the Pottsville CBD lane way site in order to mitigate the threat of koala vehicle strike.

Team Koala calls for the matters raised in this submission to be referred to the Koala Advisory Committee for their consideration and recommendations prior to a decision being made on this development application.

Yours faithfully

Jan Pilgrim Secretary

Jenny Hayes President

On behalf of

TEAM KOALA INC

**Sandra Zietlow**

---

**From:** Andrew and Melissa Darnley [beachshack@netspace.net.au]  
**Sent:** Thursday, 21 August 2014 8:45 AM  
**To:** Corporate Email  
**Cc:** Barry Longland  
**Subject:** Concerns Re Proposed Rear Lane change behind IGA Pottsville

Dear Tweed Shire Council

As a long time former resident of Pottsville, I have read with deep concern, about the proposed construction of rear lane access for heavy traffic behind the IGA off Berkleys Lane, Pottsville. Further construction work and constant traffic through this are abutting an area of remnant forest and Cudgera Creek will have a huge impact on the habitat of many species, including these endangered Bush Stone Curlews.

These photographs are of a mating pair and chick ( see bottom photos foreground) that I photographed 2 years ago immediately behind Pottsville IGA next to where cars were parked alongside the forest. These photographs are genuine. This area needs to be extensively researched before any further work is done on an already overburdened area of Pottsville.

Sincerely  
Melissa Darnley  
92 Hunter St  
Burringbar  
NSW 2483  
0428528178











# Feedback form

## Pottsville service lane two-way option



At its meeting on 17 July 2014, Council resolved to undertake additional community consultation about the construction of a rear lane off Coronation Avenue, Pottsville, this time with two-way traffic flow.

(In June 2014, Council exhibited and sought public comment on the formation of a rear lane and a proposal to change the traffic flow in Berkleys Lane, the unnamed lane and eastern sports field car park to one-way.)

The proposed works will include the construction of an additional three (3) parallel car parks to the western side of Berkleys Lane, while ensuring an appropriate green buffer to the adjoining residence and adequate vehicle turning paths. It includes the retention of the fig tree in Berkleys Lane.

Your feedback on this form would be appreciated and will be considered as a formal submission. The closing date for submissions has been extended to Thursday 28 June 2014.

You can either submit your comments at this information session or send your submission by the closing date to: General Manager, Tweed Shire Council, PO Box 816, Murwillumbah NSW 2484 or email [tsc@tweed.nsw.gov.au](mailto:tsc@tweed.nsw.gov.au).

Your name: Tony Cosgrove 11411 Prince CBD Lane  
 Address: 6 Seabreeze Blvd.

Comments: 

TWEED SHIRE COUNCIL	
FILE No:	655: 2016 339
DOC. No:	.....
RECD:	22 AUG 2014
ASSIGNED TO:	MORRAN, D
HARD COPY	<input type="checkbox"/>
IMAGE	<input checked="" type="checkbox"/>

1. Support 2-way option
2. Please consider:
  - footpaths around CBD
  - disabled access to business areas
  - bicycles ~~access~~ through CBD
3. Significance of existing fig tree is in doubt??  
 It would be a shame to see it go but it appears vehicle & pedestrian safety will be affected.  
 It may be in the community's best

170

**Feedback form**  
**Pottsville service lane two-way option**



interest to see it removed.

4. Thank you for inviting community input

5. Thank you to business houses for financial commitment to the project.

6. Traffic congestion appears to be growing - safety is an issue. Further action will be required as Pottsville becomes more and more a desirable location for tourists.

# Feedback form

## Pottsville service lane two-way option



At its meeting on 17 July 2014, Council resolved to undertake additional community consultation about the construction of a rear lane off Coronation Avenue, Pottsville, this time with two-way traffic flow.

(In June 2014, Council exhibited and sought public comment on the formation of a rear lane and a proposal to change the traffic flow in Berkleys Lane, the unnamed lane and eastern sports field car park to one-way.)

The proposed works will include the construction of an additional three (3) parallel car parks to the western side of Berkleys Lane, while ensuring an appropriate green buffer to the adjoining residence and adequate vehicle turning paths. It includes the retention of the fig tree in Berkleys Lane.

Your feedback on this form would be appreciated and will be considered as a formal submission. The closing date for submissions has been extended to Thursday 28 June 2014.

You can either submit your comments at this information session or send your submission by the closing date to: General Manager, Tweed Shire Council, PO Box 816, Murwillumbah NSW 2484 or email [tsc@tweed.nsw.gov.au](mailto:tsc@tweed.nsw.gov.au).

Your name: MARGARET WALK  
 Address: 16 KELLEHERS ROAD  
 Comments: POTTSVILLE

SEE OVER →

INFL- POTTVILLE CBD LANE	
TWEED SHIRE COUNCIL	
FILE No:	Sans: 2416 r 339
DOC. No:	
REC'D:	22 AUG 2014
ASSIGNED TO:	Morgan P
HARD COPY	<input type="checkbox"/>
IMAGE	<input checked="" type="checkbox"/>



Feedback form  
Pottsville service lane two-way option



Meeting Wed Aug 20 - summary + SUGGESTIONS

① Remove the tree !!! (general consensus)

WV ✓ ② Service Road to be two-way.

WV ✓ ③ " " to be wide

WV ✓ ④ " " to include pedestrian pathway

see ⑧

⑤ Passageway between IGA & Post Office to be made PEDESTRIAN ONLY (mall style)

⑥ People, residents + tourists needs supersede those of koalas

⑦ Cyclists need some consideration (car parks at service road could remove car parks in Coronation Ave,

⑧ Car parks, tons more, on service road,

\* ANOTHER IMPORTANT SUGGESTION:  
Charles St → one way towards school  
Anne St ← one way towards

\* This alleviates Coronation Ave fears.....

Overall Drive. (as it is) Page 2 of 2

**SUBMISSION TO TWEED SHIRE COUNCIL - 20 AUGUST 2014**  
**POTTSVILLE CBD SERVICE ROAD**

Terence O'Toole  
16 Buckingham Drive, Pottsville 2489  
Telephone: 66760186 - 048788909  
E-Mail: terryotoole@optusnet.com.au

INFIL - POTTVILLE CBD LANE

TWEED SHIRE COUNCIL	
FILE No:	SN: 2416 + 329
DCC No:	.....
RECD:	22 AUG 2014
ASSIGNED TO:	MORGAN P.
<input type="checkbox"/> COPY	<input checked="" type="checkbox"/> IMAGE

**BACKGROUND MATERIAL**

**Just One Name.**

The 2009 Pottsville Locality Plan, prepared by Tweed Shire Council, incorporated the necessary Planning for the creation of Infrastructure required to re-route the continually-growing Coronation Avenue traffic flow around the Village CBD.

**Tweed Shire Council Planning Dept. named the Full Project "The Pottsville CBD North Loop Road" - and separated it into 3 clear stages:-**

**NORTH LOOP ROAD - STAGE 1 - Coronation St. Access - This is the Service Road Proposal now being considered**

This shows a full-width Berkleys Lane (as we now call it) minus the tree, leading to a roundabout at the Northern end accessing "The Loop Road" the "Service Road" and the "Car Parking Area".

**NORTH LOOP ROAD - STAGE 2 - Bypass Road**

This shows the complete Bypass Road from Tweed Coast Road, running behind the shops, across Berkleys Lane (unnamed at that stage) then West behind the houses to rejoin Coronation at another roundabout past the last house.

**NORTH LOOP ROAD - STAGE 3 - Car Parking**

This shows 120 car parking spaces behind the shops.

Tweed Shire Council obviously felt this was a long-term project, to be constructed in 3 stages over quite a number of years. The Pottsville Community considered these plans and they were approved at a number of Community Meetings and passed back to Council to be implemented when possible. It is important that this plan for the future is not derailed. The basic premise behind the need for the **North Loop Road Infrastructure** is that Coronation Avenue has become the only pathway for the traffic flowing between the Pacific Highway and the Tweed Coastal Strip which stretches North to Chinderah. This traffic flow will not just go away, it is increasing daily as Casuarina, Salt, Cotton Beach, Surfside Beach residents move in and eventually Kings Forest residents will join them. This traffic is now jamming Coronation Avenue morning and afternoon.



You will note that the "Service Road" Project we are currently considering is just Part 1 of this 3 stage Community/Council plan for the future. No doubt the remainder of the North Loop Road Infrastructure will be worked on by future Tweed Shire Council Planning and Engineering Staff and future Tweed Shire Councillors. We should not increase their workload by making ill-considered decisions now.

## **SUBMISSION**

1. Berkleys Lane should be the Full-Width Roadway shown on the North Loop Road - Stage 1 Documentation - Full guttering, footpath, driveways, drains and lights down the Western side from the Church to the Laneway Drive at the Northern end. Fully Accessible Pedestrian access with adequate lighting from this point to the Service Road to be facilitated. The Tree and the garden bed to be removed, all shrubbery and other blockages on Council property to be removed to allow the footpath construction.
2. There should be Fully Accessible Pedestrian Access along the full length of the Service Road, to the rear of the Businesses, with lighting for evening shopping. Shoppers will increasingly park behind the shops and this will lessen the traffic flow and parking difficulties on Coronation Avenue.
3. Guttering, drainage, lighting to extend along the Southern edge of the North Loop Road with structured driveways for commercial vehicle access.
4. Adequately defined turning radiuses to be structured at both ends of the North Loop Road. These should be the correct large vehicle/bus corner radiuses. You will note that we have already had one example of incorrect radiuses on the Pottsville Roundabout. These will be required at the Coffee Shop, the rear of the Chemist Shop property and both corners where Coronation Avenue joins Phillip Street North (as we now call it).
5. Electricity Poles on the North loop Road form an obstruction. This will have to be addressed. The Coffee Shop and the Chemist Property again.
6. The Bus Stop/Layway shown in the North Loop Road Documentation (Location 7) is an area adjacent to the Tennis Courts. Following construction of the North Loop Road- Stage 1, allowance should be provided so that this stop could be used by the daily Train Connection Coaches which are now stopping outside what used to be the Pottsville Motel. When justified, established and future Public Transport Services would also use this stop. It is designed to be adjacent to the car parking area detailed in Stage 3 of the North loop Road, so that commuters can transfer from cars, but could commence operation in Stage 1..

**NOTE: There is an existing property on Crown Land to the North which is accessed by a driveway starting at the Northern end of Berkleys Lane. This driveway will have be allowed for. The Electricity Supply to the property also needs to be considered.**

General Manager  
Tweed Shire Council  
PO Box 816  
Murwillumbah  
2484

Sent by Email from [kim.holdom@bigpond.com](mailto:kim.holdom@bigpond.com)

Re: Pottsville Service Lane

#### Preamble

My submission (on the two options for Berkleys Lane Pottsville) comes from my knowledge of the outdoor dining precinct at Kingscliff (as originally mooted and designed early/mid 1990's) the revamping of same that came later and the growth of the requirement of more outdoor dining spaces needed/approved on Marine Parade.

This knowledge also includes the initial provision of the Crown Reserve Car Park (parallel to caravan park situated between Turnock and Seaview Streets) and my knowledge of the one-way street option now operating between Turnock Street and Seaview Street Kingscliff on Marine Parade and the public and business sentiment to same since implemented.

Let me acknowledge two things:

I'm no expert on road design, and

I was not originally going to write a submission on this matter, however, given what has now transpired on this laneway (from possibly one-way to two-way) I believe I should.

As you may be aware the IRB Championships were conducted in July 2014 (18/19/20) and part of my involvement in that event was to consult the business community of Kingscliff to advise them that the IRB Championships were coming and what would and would not be happening with regard to same.

I also had the responsibility of undertaking debrief consultation after the event which has been conducted.

This very "hands on" form of consultation has proved most helpful and has reinforced my view to the value of "foot slogging" consultation. The value of same (on many fronts) and how (some) people (visitors/residents) and (some) businesses; feel about the one-way street option now operating on part of Marine Parade is also part of the reason I offer Council an avenue to sort out Berkleys lane without having to perhaps rip it up and start again/modify etc, regardless of whatever option is initially/finally signed off on. While the two areas have different site constraints, it is the knowledge and experience I offer up only.

I am in fact offering a very simple solution to the matter, even though it may take additional time to arrive at a "most people are happy with the final outcome" position.

I am also putting forward this simple solution; because there is the possibility; that this could become a very costly outcome if it is not successful the first time round and it does not work/suit the residents/businesses of Pottsville.

Preamble ends.

Possible solution:

Do a *trial* of either (or both) options as was conducted at Kingscliff when the outdoor dining precinct was originally put forward. Lay the logs, place pot plants etc to define the area in question, put down the permanent (back of lane) extra car parks if they fit either option, place signage that it is "ONLY a TRIAL" - then survey - and the results then provide another report to council with the survey results. This may provide a final outcome.

While the trial on Marine Parade was awkward/messy/unpopular (to some) it cost a lot less than just putting in the changes and infrastructure then finding out it didn't work. I suggest (and it is only a suggestion) that the one-way option be trialed first.

Conclusion:

You are never going to please everyone. Some ideas put forward (mine included) may not be possible, however given the time it has taken to finally get this area under council's control, the site constraints of the area in question and its relationship to what is a land locked business area through the zonings etc, you need to be prudent on many levels. This possible solution also hands back the management of the area to the experts to design the final outcome, rather than just having something that actually makes the entire area a nightmare to navigate and manage in the long term, not to mention long term maintenance costs of this infrastructure.

Yours Sincerely

Dorothy M Holdom

Tweed Shire Resident

Former Business Owner Marine Parade Kingscliff

86 Kingscliff Street

Kingscliff

2487

24/8/14

# Feedback form

## Pottsville service lane two-way option

1271 - POTTSVILLE C80.

TWEED SHIRE COUNCIL
FILE No: <u>SD: 2416, 339</u>
DOC. No: .....
REC'D: <u>25 AUG 2014</u>
ASSIGNED TO: <u>MORGAN, P</u>
HARD COPY <input type="checkbox"/> IMAGE <input checked="" type="checkbox"/>



TWEED SHIRE COUNCIL

At its meeting on 17 July 2014, Council resolved to undertake additional community consultation about the construction of a rear lane off Coronation Avenue, Pottsville, this time with two-way traffic flow.

(In June 2014, Council exhibited and sought public comment on the formation of a rear lane and a proposal to change the traffic flow in Berkleys Lane, the unnamed lane and eastern sports field car park to one-way.)

The proposed works will include the construction of an additional three (3) parallel car parks to the western side of Berkleys Lane, while ensuring an appropriate green buffer to the adjoining residence and adequate vehicle turning paths. It includes the retention of the fig tree in Berkleys Lane.

Your feedback on this form would be appreciated and will be considered as a formal submission. The closing date for submissions has been extended to Thursday 28 June 2014.

You can either submit your comments at this information session or send your submission by the closing date to: General Manager, Tweed Shire Council, PO Box 816, Murwillumbah NSW 2484 or email [tsc@tweed.nsw.gov.au](mailto:tsc@tweed.nsw.gov.au).

Your name: L.A. D'ELBOUX & R.J. D'ELBOUX

Address: 2/4 SARAH COURT POTTSVILLE 2489

Comments: ① REMOVE FIG TREE IN BERKLEYS LANE

Will result in better movement of traffic to + fro.

Will also open up more parking spaces.

② Only ~~RIGHT~~ LEFT TURN ALLOWED EXITING NEAR PROFESSIONALS onto CORONATION AVE using roundabout extend of street.

③ SAME TO APPLY ON EXITING BERKLEYS LANE (LEFT TURN ONLY)

④ ANOTHER PEDESTRIAN CROSSING TO BE PUT ON CORONATION AVE AND A PEDESTRIAN CROSSING TO BE PLACED ACROSS PHILIP STREET TO ALLOW FOLK TO CROSS STREET FROM MARKETS TO FOOTPATH WHICH CAN TAKE THEM ONTO CORONATION AVE PEDESTRIAN CROSSINGS.

⑤ PERHAPS A PED. CROSSING COULD BE PLACED ON OR NEAR CORNER OF ELIZABETH STREET (FOR SAFETY)

Feedback form  
Pottsville service lane two-way option

- ⑥ On extension of Barkleys Lane at back of present shops - I suggest you provide a footpath and adequate guttering for pedestrians easy access. Mothers with prams and persons crossing over from parking.
- ⑦ Perhaps a pedestrian crossing for Car Owners / Drivers to access shops
- ⑧ The already provided pavement on shop side has a divided area. This could be widened to provide cyclists / skateboarders a safe area to ride / bikes / skateboard to meet up with already existing cycle paths from Sea Breeze to Park Grove across How Professionals Estate Office. Bike-path can be marked as two-way cycle-path.  
Coronation Ave could also benefit with widening by no parking along that side of the road.
- ⑨ Close off all driveway accesses to present shops except left turn only access to present underground parking under one group of shops.
- ⑩ I have concerns re right turns into either end of proposed two-way CBD Barkleys Lane construction - perhaps traffic lights - one is a 4-way junction  $\perp$  and the other Barkleys Lane a T-junction.

Al Elliott

The General Manager  
Tweed Shire Council  
P.O. Box 816  
Murwillumbah. 2484

Anne Honeyman  
P.O. Box 95  
Pottsville 2489

Dear Sir,

Re: POTTSVILLE CBD AREA – COMMUNITY CONSULTATION on 20.8.14 - FEEDBACK

Thank you to the Council staff who gave their time to conduct the community consultation which I attended on Wednesday 20th August and thanks for the opportunity to now present the following feedback to you for consideration.

**PARKING:** I was one of many at the session who asked that more parking bays be created in the back lane behind the shops. We were informed that Council own the land on the northern side of the new road and that some of the existing parking behind IGA will be used for a 'service vehicles only' area. With this in mind, plus the fact that there is not enough parking in the CBD area of Pottsville at the moment, I ask Council to consider providing as many nose-in parking bays as is possible along the northern side of the new road.

**FOOTPATH:** It was suggested by someone at the meeting that a footpath would be needed along the southern side of the road behind the shops. I believe a footpath is needed but that it should be situated along the northern side where there is parking. If it was on the southern side, vehicles entering/exiting behind the shops, could pose a hazard to pedestrians.

**PEDESTRIAN CROSSINGS:** If a footpath was created on the northern side of the new road behind the shops, I believe that two pedestrian crossings would be needed – one at the western end and another at the eastern end of the new road. Someone suggested that two more crossings were needed in Coronation Avenue. I believe that one more is needed – towards the eastern end of Coronation Avenue and somewhere in the vicinity of LJ Hooker Real Estate.

**EXISTING EXITS FROM BUSINESSES ON CORONATION AVENUE:** We were informed that these would be closed at the completion of the new road works. I urge Council to ensure this is done – especially the entrance/exit near IGA, because it can be a major problem area at the moment.

**STOP SIGNS:** I ask that Council place these for all traffic exiting businesses into the new road.

SPEED LIMITS: This was discussed and someone suggested that a 25km limit be imposed on traffic along the new road. We already have too many variations to the speed limit, so I suggest that the new road be a 40km zone and that this limit be extended around into the unnamed street in front of the Newsagency and continued into Phillip Street. I also believe that Elizabeth Street needs to be included in the 40km zoning. It is a very busy street at present, with high vehicle and pedestrian usage which will increase greatly when the new school is opened next year. Both Anne Street and Charles Street could be included in the 40km zoning which would make the total CBD area safer for all.

TRAFFIC EXITING THE NEW ROAD – EASTERN END: I mentioned this at the session and also in my original submission dated 24<sup>th</sup> June 2014 :- that a new road be created for all exiting traffic only from the new road across to the Tweed Coast Road roundabout. This may not be possible now but it may be worth considering for the future as it could reduce some of the traffic flow along Coronation Avenue.

STOP SIGNS: I ask that Council place stop signs for traffic using all exits from behind the CBD area into the new road. It was mentioned that Council may also install speed humps at each exit.

INTERSECTION OF CORONATION AVE. and ELIZABETH STREET: In previous correspondence to Council I have written about vehicles using this intersection as a roundabout and I spoke to Council staff about it at the consultation session. It is happening on a regular basis and creates danger for pedestrians and other road users. Council staff told me it could be prevented by placing a cement strip along the middle of the road. If this is done, then the parallel parking along the western side of Elizabeth Street must go. The said parking is already a problem because if cars are parked there, as well as nose-in across the road, there is not enough road room for two-way traffic. I often have to drive over the double white lines ( where the cement strips would be) to negotiate around parked cars.

BY-PASS: There were questions/discussions at the session about when the by-pass from Seabreeze to Black Rocks would be constructed. I have mentioned this also in previous correspondence to Council. Many at the meeting (including myself) believe it should be done sooner rather than later. This would reduce the volume of traffic along Coronation Avenue. Elizabeth Street is used as a mini by-pass at the moment and it has a high volume of speeding traffic. I am very concerned about the greater amount of traffic along Elizabeth Street when the school is opened next year. A by-pass is needed now.

My file tells me that I first wrote to Council in 2007 about traffic/parking problems. Recent mention of these problems could be found in response to the DA for the new school.

Yours faithfully,

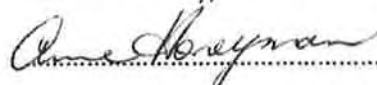
.....Anne Honeyman

dated 22nd August 2014.

# Feedback form

## Pottsville service lane two-way option



At its meeting on 17 July 2014, Council resolved to undertake additional community consultation about the construction of a rear lane off Coronation Avenue, Pottsville, this time with two-way traffic flow.

(In June 2014, Council exhibited and sought public comment on the formation of a rear lane and a proposal to change the traffic flow in Berkleys Lane, the unnamed lane and eastern sports field car park to one-way.)

The proposed works will include the construction of an additional three (3) parallel car parks to the western side of Berkleys Lane, while ensuring an appropriate green buffer to the adjoining residence and adequate vehicle turning paths. It includes the retention of the fig tree in Berkleys Lane.

Your feedback on this form would be appreciated and will be considered as a formal submission. The closing date for submissions has been extended to Thursday 28 June 2014.

SS: 2416,339

You can either submit your comments at this information session or send your submission by the closing date to: General Manager, Tweed Shire Council, PO Box 816, Murwillumbah NSW 2484 or email [tsc@tweed.nsw.gov.au](mailto:tsc@tweed.nsw.gov.au).

Your name: Mrs. Shirley Gill

Address: 3 Buckingham Dr. Pottsville

Comments: The Service Road should be the full

width Roadway of two lanes with full  
guttering and drainage right along.

Also a footpath is needed right along the  
Service Road and car Parks.

Bus stops should be added to the  
Service Road as Coronation Ave. is too  
narrow for buses to stop. The train Bus  
stops out side the motel and that is a long  
way from the C.B.D.

Berkley's Lane should be two ways with the

TWEED SHIRE COUNCIL	
FILE No:	<u>WFS - PVILLE CBO</u>
DATE No:	.....
RECV:	<u>26 AUG 2014</u>
AS SENT TO:	<u>MORGAN, P</u>
HARD COPY	<input type="checkbox"/>
IMAGE	<input checked="" type="checkbox"/>



**Feedback form**  
**Pottsville service lane two-way option**



Tree removed as well as the garden.

The Service Road will provide service vehicles and car access, to which will help to improve traffic congestion in Pottsville, CBD for the time being. I hope this is part one of the Council's plan - in the near future I expect the Council's planning and engineering staff to remember the next stage for the Service Road to go right through past the back of the houses to join with Coronation Ave as promised in 1996. This would certainly make Coronation Ave safe from many large vehicles.

All vehicles entrances near shops along Coronation Ave to be closed, and these could be made into car parks.

No right hand turn coming out of the Service Road, onto Coronation Ave, near the Professionals

I thought your suggestions on the map shown to us on Wednesday was good, so hope it can be carried out

**Sandra Zietlow**

---

**From:** Janeene [payne.janeene@gmail.com]  
**Sent:** Tuesday, 26 August 2014 11:45 PM  
**To:** Corporate Email  
**Subject:** Fwd: Re:

Sent from my iPhone

Begin forwarded message:

**From:** Troy Green <[TGreen@tweed.nsw.gov.au](mailto:TGreen@tweed.nsw.gov.au)>  
**Date:** 26 August 2014 9:40:35 pm AEST  
**To:** Janeene <[payne.janeene@gmail.com](mailto:payne.janeene@gmail.com)>  
**Subject: Re:**

Ben

Can you send your emails to [tsc@tweed.nsw.gov.au](mailto:tsc@tweed.nsw.gov.au) so the councillors and appropriate staff receive it.

Cheers

Troy

On 26/08/2014, at 9:10 PM, "Janeene" <[payne.janeene@gmail.com](mailto:payne.janeene@gmail.com)> wrote:

Lane has been a safe place for 25 years, now I hear that Council are planning to open it up to the general Pottsville traffic so as to access the back of the shops. I appeal to you as our Local Council to NOT do this. Let the people use the Eastern end that they already do and keep Berkley's Lane Blocked off. I know my 2 kids and wife have sent emails in telling you of their health issues and I ask that this definitely be a Huge Consideration when you are making the final decision re this proposal. As parents yourselves I am sure you will appreciate my concerns about my kids safety. Keeping all Kids safe I'm sure is a big priority for council.

Regards Ben Payne

Sent from my iPhone

---

All official correspondence requiring a formal written response should be addressed to the General Manager, PO Box 816, Murwillumbah, 2484; or emailed to [tsc@tweed.nsw.gov.au](mailto:tsc@tweed.nsw.gov.au); or faxed to 02 6670 2429.

This email and any files transmitted with it are confidential and intended solely for the use of the individual or entity to whom they are addressed. If you have received this email in error please notify the system

manager.

Opinions, conclusions and other information in this message that do not relate to official Council business shall be understood as neither given nor endorsed by it.

This e-mail may contain an e-Letter attachment. A digital message is deemed to have been delivered, opened, viewed, presented and provisioned to a customer when the digital message is accessible by the customer to whom it was sent. If an original hard copy of the message is required, please reply to this message requesting a hard copy.

[www.tweed.nsw.gov.au](http://www.tweed.nsw.gov.au)

---

This email has been scanned by the MessageLabs Email Security System

---

## Sandra Zietlow

---

**From:** Dave Norris [norrilyn@gmail.com]  
**Sent:** Wednesday, 27 August 2014 4:04 PM  
**To:** Corporate Email  
**Subject:** Re: Submission\_Pottsville service lane two-way option

Dear General Manager

Could you please consider the following points when making your decision on the Pottsville CBD lane road construction:-

- Council should hold back on allowing vehicular traffic from the service lane-way through into Berkleys Lane at this stage in order to test if the service lane can operate successfully without through traffic. This may operate better if traffic (other than trucks) is allowed to enter the IGA car park from Coronation Avenue but not exit onto Coronation Avenue. However, this has the potential to choke up westbound traffic on Coronation Avenue east of the IGA entry point, and cause further safety issues as motorists dart across eastbound traffic in order to enter the car park. Perhaps allowing entry for eastbound traffic only may be safer.
- Council needs to consider safety issues, eg where children exiting the IGA could run out the door (which is very close to the existing car park entry) and be hit by a vehicle entering the car park. I believe the best option is to close the IGA driveway onto Coronation Avenue. Perhaps the shop doorway could be relocated to the west closer to the pedestrian crossing on Coronation Ave and away from the driveway.
- No through traffic onto Berkleys Lane would reduce the likelihood of hooning on the service road, which was identified as a major problem/safety issue at the drop-in information session. Also hooning has the potential to compromise the quality of the koala habitat adjacent to the lane-way. Tweed Coast Habitat Study 2011 (TCKHS) identifies that habitat stress resulting from disturbance generally is a contributor to koala immune system degradation, resulting in disease and death. The large tea tree (containing habitat hollows) at the western end of the lane-way, which is proposed to be removed, should be retained if the 'no through traffic option' is to be tested.
- There should be a footpath incorporated into the design on the northern side of the lane (safety for pedestrians and mothers with children and prams).
- If possible, there should be a cycle-way incorporated into the design for the lane-way and also on Coronation Avenue (safety for catholic primary school kids).
- Consideration should be given to the installation of koala-proof fencing along the western side of the lane-way. The opening of Berkleys Lane to through traffic will shift the koala mortality black spot along Coronation Avenue (refer TCKHS Figure 5.3a) to the footprint of the lane-way, which is closer to the Secondary A Koala Habitat, the recently planted koala food trees (refer Koala Connections Project) and the Koala Corridor identified in TCKHS Figure 5.1. TCKHS Figure 3.2 also shows significant koala activity adjacent to Berkleys Lane.
- Bollards should be installed on the western side of lane-way to stop vehicles nosing or backing into the environmental protection zone and to protect tree root systems.

- Traffic calming devices should be built into the lane-way; however, consideration should be given to the possibility that this may raise the trajectory of vehicle lighting into the house in Berkleys Lane opposite the western end of the lane-way.
- I believe the fig tree on Berkleys Lane should stay in place to act as a traffic calming measure. Also I believe it is listed as a threatened plant species and should not be damaged for this reason.
- No through traffic onto Berkleys Lane and retention of the fig tree would maintain the unique village atmosphere that is attracting tourists to Pottsville. The qualities that draw tourists to seaside villages are too often destroyed in the name of short-term traffic management when in the longer term traffic is diverted to commercial precincts outside the village. If you ask any tourist that visits Pottsville as to what attracts them here, they will say the village atmosphere. The area north of the shops on Coronation Avenue has a northerly aspect onto bushland which provides one of the few pleasant outlooks in Pottsville where tourist-orientated specialty shops and eateries could be focused.

Yours faithfully

David Norris

On behalf of Team Koala

Phone: 02 6676 0615

Mobile: 0423 267 555

Email: [norrilyn@gmail.com](mailto:norrilyn@gmail.com)

## Sandra Zietlow

---

**From:** David McDowell [david@mcdowell.com]  
**Sent:** Wednesday, 27 August 2014 9:21 PM  
**To:** Corporate Email  
**Cc:** oynomore@hotmail.com  
**Subject:** Pottsville Service Lane Feedback  
**Attachments:** MCD Berkley's Lane.jpg

**Name:** David McDowell

**Address:** 24 McKenzie Ave. Pottsville, 2489.

Following the recent meetings of the community regarding the service lane off Coronation Ave, Pottsville, there appears to be little concern for pedestrians or the unique Tweed Coast issue of the aging of the community. This introduces mobility issues that would normally not be a concern within your average community in NSW. In Pottsville, many members of the community using the CBD precinct use mobility scooters, walking frames, canes and even Guide Dogs and blind canes. Of course, most of the impaired also drive cars. This sector of our community requires special consideration when we address traffic flow plans in Pottsville. I have attached a diagram to help illustrate some of the ideas I think may help improve safety for all pedestrians and drivers using a two-way service lane.

One of the primary intentions of the service lane is to bring traffic for the CBD along the rear of the Coronation Ave shops for parking and access to the properties. This will, obviously lead to increased pedestrian traffic along the lane. To allow safe and easy pedestrian flow along the lane, I feel we need to formalize the road edging on the Southern side of the lane and include an adequate foot path that can accommodate scooters and walking frames. This will also allow the impaired to move at their own speed in safety.

Another safety issue unique to this area is the parking. We regularly have small crashed in the parking area at the Eastern end of the lane. I believe a lot of these are caused by drivers not being able to turn their bodies adequately to assess traffic in the lane into which they are now reversing. Many of our elderly drivers simply reverse slowly hoping anyone behind them will stop or honk. We have a grassed area East of the parking area that is allocated Overflow parking for the markets. This overflow area can no longer be accessed due to a row of bollards that have been installed. A simple solution will allow the elderly drivers to enter the parking driving forward and exit the parking driving forward. If two bollards were removed and formalized parking constructed in the overflow area, we will gain a dozen or so parking spaces and provide the less mobile drivers a safer alternative for parking in this area. I know of a couple of drivers already that will park in Philip St and walk across Coronation Ave because they are not confident enough to park on the Eastern side of Rundel's Corner (1 Coronation Ave).

A third safety issue is the u-turning at the intersection of Coronation and Elizabeth Streets as well as at the Berkley's Lane / Coronation Ave intersection. With the opening of St Ambrose primary school in Elizabeth St, illegal driver behavior becomes a major safety issue. Devices will need to be installed to prevent u-turns at both of these intersections. Further to the congestion at Elizabeth St, at the moment, Coronation Ave is regularly blocked by traffic turning into the IGA parking area from all three directions (Coronation West, Coronation East and Elizabeth) and having to wait for a break in pedestrians before moving off Coronation Ave. Should this driveway remain open, the situation can only worsen and safety be further compromised. I feel the community cannot accept anything less than a total closure of the driveways crossing the pedestrian footpath on Coronation Ave in this area; in particularly the driveway opposite Elizabeth St. Rundel's Corner has already taken the initiative to close off the access from Coronation Ave.

Finally, and critically, the speed of traffic along the service lane will play a role in pedestrian, bike and koala safety. There are several initiatives that may work in controlling traffic on the service road:

- Extend Berkley's Lane. If Berkley's lane was formed into a cul-de-sac beyond the junction of the service lane, that junction becomes a T-intersection giving the traffic on Berkley's Lane and the residences right of way over

traffic coming from the service lane making it easier for residents to leave their homes. It also gives pedestrians a better opportunity to cross the service road in safety.

- Cul-de-sac behind chemist. Having the service road a two way road and terminating behind the chemist in a turning circle will allow truck access to the commercial properties only from the Eastern end of the lane preventing trucks having to pass the fig tree in Berkley's Lane. The problem with a cul-de-sac is forcing any traffic from West (Seabreeze and Dunloe Park) along Coronation Ave twice to park at any business on Coronation Ave and then return home. Should there be a single lane, raised feeder from the lane through to Berkley's Lane, West bound car traffic will be able to access Coronation Ave at a hindered speed without having to go through the centre of town again. All trucks can exit via the Eastern end of the lane.

In summary, whether the lane is two way all of the way or we create a speed retarding device such as a cul-de-sac/raised feeder solution, critical to the safety and flow of our (more impaired than average) pedestrian community are the three devices highlighted above:

- Footpath and formal road edging servicing the new service lane at least on the Southern side of the lane;
- Additional formal parking opposite 1 Coronation Ave to eliminate the need to reverse into passing traffic;
- Most importantly the mandatory closure of driveways crossing the pedestrian footpath along Coronation Ave between Berkley's Lane and the Eastern end of the Service Lane;
- Extend Berkley's lane to a cul-de-sac to form a T-intersection with the service lane giving Berkley's Lane right of way.

Thank you for your time and consideration,

Regards

David McDowell

24 McKenzie Ave. Pottsville, 2489

Pottsville Beach News

1 Coronation Ave. Pottsville, 2489

OVIAL

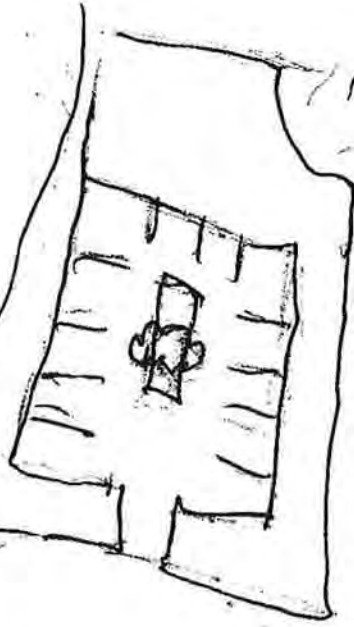

PHILIP

RONDEL'S CORNER  
1

DUNE/MEDICAL

OLD POTTSVILLE  
STORE

IGA

CHEM

CORONATION

ELIZ.

C. MURPHY

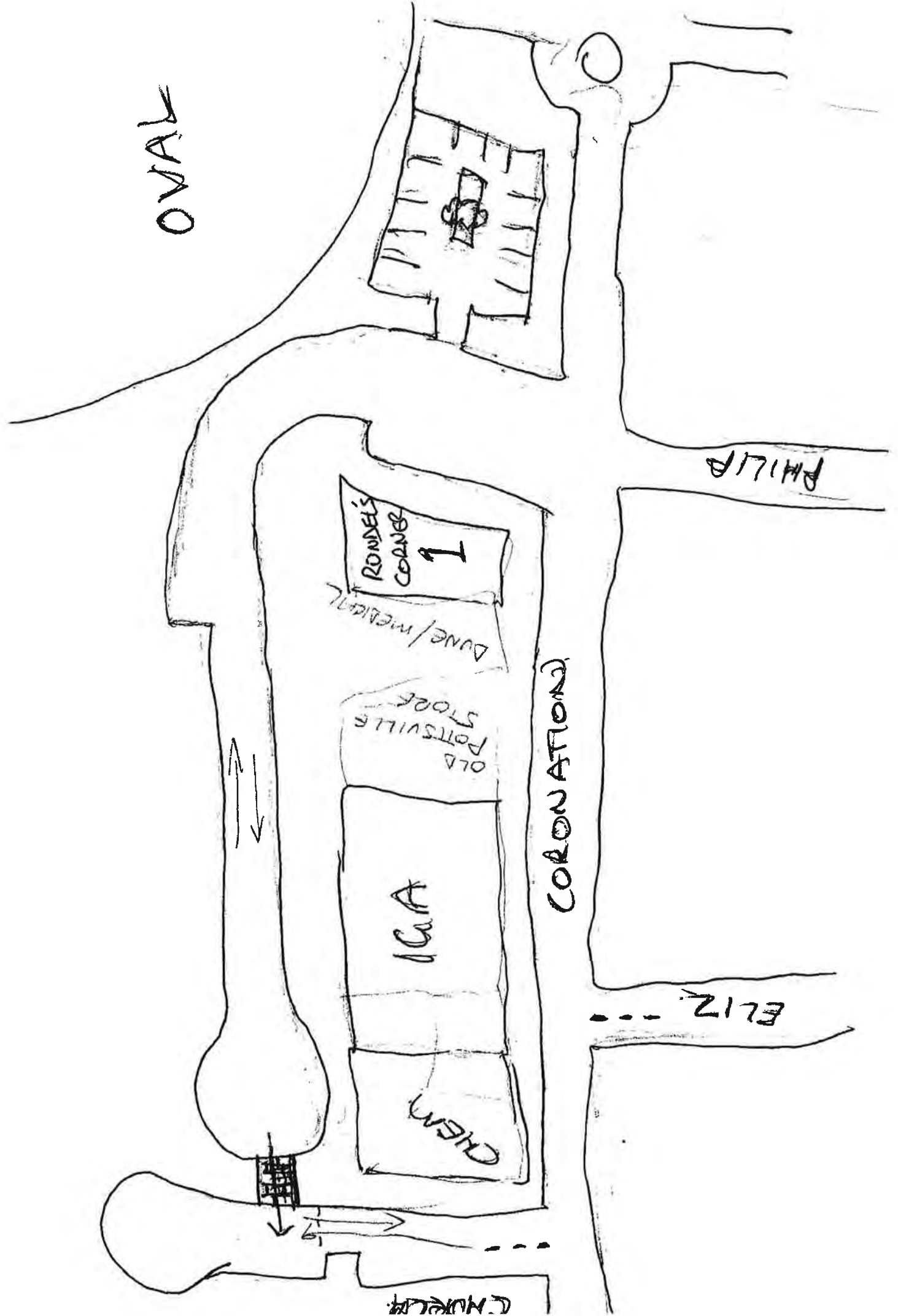



I hereby agree to the Option 1 for Berkleys Lane - Service Rd and the closing of all driveways on the IGA side of Coronation ave between Berkley Rd and the new Service Rd Pottsville. I agree that Berkleys Lane and the service Rd should be 2 way traffic and also that parking spaces should be made where the driveways have been closed off and they should be signed 30-1hr parking. Also a "no-thru" sign should be at the entry of Berkleys lane

Signed  
Desley Pike

Date  
1/7/2014

SJ: 2416, 339

T. MIDSHIRE COUNCIL	
FILE No:	WAI - POTTVILLE CEO
DOC. No:	
RECD:	28 AUG 2014
ASSIGNED TO:	MORGAN
HARD COPY <input type="checkbox"/>	IMAGN <input checked="" type="checkbox"/>

PETITION

resident Cudgera Creek NSW 2484  
Christina Conquest Coronation St. 2489

Carman Lew 17 Coronation Ave Pottsville 2489

~~Carman Lew~~ 17 Coronation Ave, Pottsville, 2489

Sam Wiper Seabreeze Estate Pottsville, 2489

Steve Allen 19 Coronation Ave Pottsville 2489

Pat Harvey 22 Coronation Pottsville

Kevin Hardy . 22 Coronation on Pott.

RON RICHARDSON 2/2 HUKA CRT POTTSVILLE ALLEN







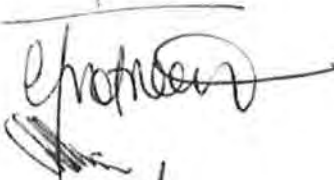

3/48 Coronation Ave Pottsville. 2489

8/42 " " " " 2/10  
9/30 " " " " 2/10

3/7/14 DAVID NEARNS. 28 ROSMERE PLACE POTTSVILLE  
2/5 CORONATION AVE, POTTSVILLE

*[Handwritten signature]*

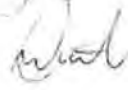
I hereby agree to the option 1 for Berkleys Lane - Service Rd and the closing of all driveways on the IGA side of Coronation ave between Berkle Rd and the new Service Rd Pottsville. I agree that Berkleys Lane and the Service Rd should be 2 way traffic and also that parking spaces should be made where the driveways have been closed of and they should be signed 30-1hr parking. Also a "no-thru" sign should be at the entry of Berkleys lane

<u>Signed</u>	<u>Date</u>	<u>ADDRESS</u>
	3.7.14	2/5 Coronation Ave Pottsville
	3.7.14	Coronation Ave Pottsville
	3.7.14	Coronation Ave Pottsville
	3/7/14	Coronation Ave Pottsville
	3.7.14	Coronation Av Pottsville
	3/7/14	Coronation A
	3/7/14	2/80 Teak Circuit - Suffolk Park
	3/7/14	12 Mooree st Pottsville
	3/7/14	12 Mooree st Pottsville

PETITION.

SW: 2416, 339  
 LOCAL GOVERNMENT SHIRE COUNCIL  
 FILE No: 1271 - PINE GROVE  
 DOC. No: .....  
 ECD: 28 AUG 2014  
 SIGNED TO: MORCA  
 HARD COPY  IMAGE

SJ: 2416 339

TWEED SHIRE COUNCIL	
FILE No:	WAI - PVILLE 130
DOC. No:	.....
RECD:	28 AUG 2014
ASSIGNED TO:	MOCKAJ. P
HARD COPY	<input type="checkbox"/>
IMAGE	<input checked="" type="checkbox"/>

Customer: PETITION

I hereby agree to the Option 1 for Berkleys Lane - Service Rd and the closing of all driveways on the IGA side of Coronation ave between Berkley Rd and the new Service Rd Pottsville. I agree that Berkleys Lane and the service Rd should be 2 way traffic and also that parking spaces should be made where the driveways have been closed off and they should be signed 30-1hr parking. Also a "no-thru" sign should be at the entry of Berkleys Lane

3/7/14	Pat B	29/ CASSION CROSS BOGARTON
3/7/14	BILL HANNET	15 ELMAN AVE POTTSVILLE
3/7/14	DON SWAN	2 EDINBURGH CRT POTTSVILLE
3/7/14	DARREN LOGAN	11 DIANA CT PVILLE
3-7-14	SEAN REAS	11 WOODFILL CRESNT POTTSVILLE
3-7-14	Ian KIRK	ELIZABETH ST. POTTSVILLE
3-7-14	BRAD SWEARD	12 ROSE ARM CRT.
3-7-14	IRIS QUINN	POTTSVILLE
3-7-14	Evabel Henry	Haskings Point
3-7-14	Kym Abbott	19/27 Elizabeth Grove Pville
3-7-14	Catherine Clifton	10 Anne St Pottsville
3.7.14	JOHN CASTNER	OVERALL DR POTTSVILLE
3.7.14	Revel Lemant	34 Newcastle Dr Pottsville
3.7.14	L. HUBBARD	Pottsville
3.7.14	H. MUNN	Pottsville
3.7.14	L. BUCCY	Pottsville
3.7.14	N. DAVIS	Pottsville

# Feedback form

## Pottsville service lane two-way option



At its meeting on 17 July 2014, Council resolved to undertake additional community consultation about the construction of a rear lane off Coronation Avenue, Pottsville, this time with two-way traffic flow.

(In June 2014, Council exhibited and sought public comment on the formation of a rear lane and a proposal to change the traffic flow in Berkleys Lane, the unnamed lane and eastern sports field car park to one-way.)

The proposed works will include the construction of an additional three (3) parallel car parks to the western side of Berkleys Lane, while ensuring an appropriate green buffer to the adjoining residence and adequate vehicle turning paths. It includes the retention of the fig tree in Berkleys Lane.

Your feedback on this form would be appreciated and will be considered as a formal submission. The closing date for submissions has been extended to Thursday 28 June 2014.

You can either submit your comments at this information session or send your submission by the closing date to: General Manager, Tweed Shire Council, PO Box 816, Murwillumbah NSW 2484 or email [tsc@tweed.nsw.gov.au](mailto:tsc@tweed.nsw.gov.au).

Your name: Carol Chandler

Address: 14 Tweed Coast Road Pottsville

Comments: Attached.

S.S: 2416, 339  
TWEED SHIRE COUNCIL  
FILE NO: 13/11/14/1116 080  
DOC. No: .....  
REC'D: 28 AUG 2014  
ASSIGNED TO: MORGAN, A  
HARD COPY  IMAGE



## **SUBMISSION TO THE PROPOSAL RE THE POTTSVILLE SERVICE LANE OPTION**

Name: Carol Chandler

Address: 14 Tweed Coast Road Pottsville

I understand that this is a stop gap proposal to remove the dangerous car entrance into the supermarket and attempt to reduce some of the through traffic using Coronation Drive, but it would have been better to make a plan with longer term benefits and less impact on our wonderful, fortuitous nature reserve at the back of the shops. If you wanted to plant a nature reserve like that, it would take many years and we are lucky enough to have it there already. At Cabarita Beach, there is a wee remnant coastal rainforest on the headland, signed and celebrated as a wonderful piece of nature. Here we have the equivalent in Pottsville and we want a two lane paved road beside it to break up the environment. It is one of the most wonderful car park views ever.

I believe that the real issue is that too many cars are coming into town, many of them are just passing through and if we could reduce that problem, it would help with the general congestion in Coronation Drive. Catering to cars just exacerbates the problem, highlighting other options to reduce traffic flow in the narrow main street, would be a big step forward. We have to be careful that the attractions that we like so much about our village are not killed off by catering to the things that destroy natural beauty.

My submission

1 Install signage at the Community Hall that there is parking available behind there. This would mean that folks could then use the footpath round the oval to the shops, market, whatever. The parking near the playground in Ambrose Brown park is quite visible and complements this suggestion. The parking at the back of the toilet block in Ambrose Brown Park could perhaps be given some signage as there are quite a number of spaces there.

2. Signage at the intersection of Philip Street and Coronation Avenue that there is parking available there. There are a large number of spaces and if not a market day, availability is good, along with good footpaths to Coronation Avenue.

3. No right turn out of north Philip Street (where the newsagent is located). It is difficult to do this with oncoming traffic along Coronation Avenue. It is far better for cars to all turn left and go round the roundabout, if they need to travel back along Coronation Avenue towards the highway.

4. Signage that cars can bypass Coronation Avenue by going through Koala Beach and through Seabreeze and onto Pottsville Road/Cudgera Creek Road towards the highway. These signs could be both located on Tweed Coast Road before the school and on Pottsville Road at the entrance to Seabreeze. This would reduce a lot of traffic that is only passing through town to get to the other side and not to access the shops.

5. I think that one way option in the Service Lane should be retained as it keeps cars more visible as you are then only looking one way for oncoming vehicles. If the degree of development that was proposed at the meeting goes ahead, it will be similar to a major road, what with two way traffic and footpaths and driveways etc. There will be trucks using that road reserve, cars, pedestrians, prams, children.

6. I suggest that the trees be retained in Berkley's Lane to slow traffic, especially if the one way option is retained.

7. If the traffic is one way in the Service Lane then the traffic flow could be left off Coronation Avenue and right into the service lane. This would mean no car headlights shine into the house in Berkley's Lane as the cars would turn right and not head towards the house.

8. The traffic to be two way up to the end of the tennis courts enabling pick up from the tennis court and access to the businesses and buildings from the rear and one way in the Service Lane.

Please let's not pave paradise to put up a parking lot.

Carol Chandler

*Carol Chandler*

*28/8/14*

# Feedback form Pottsville service lane two-way option

30: 2416, 339  
TWEED SHIRE COUNCIL  
FILE No: 1211 - POTTVILLE C80  
DOC. No: .....  
REC'D: 28 AUG 2014  
ASSIGNED TO: MOKKAN.  
HARD COPY  IMAGE



At its meeting on 17 July 2014, Council resolved to undertake additional community consultation about the construction of a rear lane off Coronation Avenue, Pottsville, this time with two-way traffic flow.

(In June 2014, Council exhibited and sought public comment on the formation of a rear lane and a proposal to change the traffic flow in Berkleys Lane, the unnamed lane and eastern sports field car park to one-way.)

The proposed works will include the construction of an additional three (3) parallel car parks to the western side of Berkleys Lane, while ensuring an appropriate green buffer to the adjoining residence and adequate vehicle turning paths. It includes the retention of the fig tree in Berkleys Lane.

Your feedback on this form would be appreciated and will be considered as a formal submission. The closing date for submissions has been extended to Thursday 28 June 2014.

You can either submit your comments at this information session or send your submission by the closing date to: General Manager, Tweed Shire Council, PO Box 816, Murwillumbah NSW 2484 or email [tsc@tweed.nsw.gov.au](mailto:tsc@tweed.nsw.gov.au).

Your name: Donna Black

Address: 15A Coronation Ave Pottsville Beach

Comments: Please, I beg you at Council to please please construct the SERVICE LANE independent of Berkley's Laneway. For a period of time have the Service Rd, operating with a truck turn point at the Berkley's lane end and see if the public respond favourable to it. Leave Berkley's lane as a "No Thru Lane" perhaps placing some Movable Large rocks or large potted trees to stop the traffic entering from Berkley's





## Feedback form

### Pottsville service lane two-way option



**TWEED**  
SHIRE COUNCIL

Lane. As I said at the last council gathering, 85-90% of the danger and congestion on Coronation Ave will be instantly ceased as soon as the IGA driveway closes permanently to the public traffic (as is part of his DA approval on the proviso that the Service Lane is open). Pedestrians will be safer and the flow of traffic will be as it was before he opened that driveway. Please give it a go, what have you got to lose. Your aim is to increase pedestrian safety and ease the traffic problems along Coronation Ave CBD. Closing off the IGA "Will Do Both". There is another ~~option~~ option and that is the suggestion that I am putting forward, not just to open Berkeley Lane into the Service Lane cause Berkeley's Lane to potentially become another congested Rd. Please leave it just like it is for a trial period.

## Sandra Zietlow

---

**From:** Sharyn Borger [sharynb@apexconsultants.com.au]  
**Sent:** Thursday, 28 August 2014 2:18 PM  
**To:** Corporate Email  
**Cc:** Paul Morgan; 'John Wightman'  
**Subject:** Pottsville CBD Lane Construction  
**Attachments:** Ltr TSC 280814 - Berkleys Lane Construction.pdf

Hi Paul,

Please find attached a submission regarding the upgrading of the Pottsville Service Lane.

If you have any queries, or would like to discuss, please don't hesitate to call.

Regards,  
Sharyn



### Sharyn Borger

*M:* 0413 921 607    *E:* [sharynb@apexconsultants.com.au](mailto:sharynb@apexconsultants.com.au)  
*P:* 07 5599 1002    *A:* po box 693, coolangatta qld 4225  
*F:* 07 5599 1003    *W:* [www.apexconsultants.com.au](http://www.apexconsultants.com.au)

---

26 August 2014



Pottsville Service Lane  
Tweed Shire Council  
PO Box 816  
Murwillumbah NSW 2484

**Attention:** Paul Morgan  
Traffic Management Committee

Dear Sir,

**PROPOSED CONSTRUCTION OF POTTSVILLE CBD LANE (BERKLEY'S LANE), POTTSVILLE**

On behalf of Pottsville IGA, located at 11-13 Coronation Avenue, Pottsville, I would like to thank you for providing the advice that Council has resolved to support two way traffic flow in Berkleys Lane, Pottsville, and for the provision of a draft plan of the lane alignment and the location of driveway crossover points from the new road to the commercial properties fronting Coronation Avenue.

Whilst we are in full support of the construction of Berkleys Lane to two way traffic, there are a number of suggestions/concerns in relation to the Pottsville IGA site that we would like to discuss with Council.

The main concern relating to the Pottsville IGA site is the loading/unloading area and the impact on the existing car park, and public safety.

The draft plan indicates that a new driveway crossover to Berkelys Lane will be provided, approximately 6.0m from the eastern boundary. Complicated maneuvering would then be required for a vehicle to access the loading dock at the rear of the IGA premises. The provision of the driveway, and the maneuvering areas would result in the loss of approximately 7 car parking spaces. Furthermore, the arrangement would result in an undesirable situation where delivery vehicles would conflict with pedestrian access through the carpark, potentially creating an unsafe situation for pedestrians walking to/from their vehicles.

Currently the IGA receives deliveries from 12.0m rigid vehicles, 8.0m rigid vehicles and from vans. Deliveries from the trucks generally occur in the mornings between the hours of 6.00am – 10.00am. Van deliveries take place sporadically throughout the day, with the majority being between the hours of 3.00pm – 5.00pm. On average, approximately 28 truck deliveries and 16 van deliveries occur each week.

The volume of truck deliveries to the site has the potential to conflict with the customer use of the carpark.

Pottsville IGA would like to put forward a suggestion for Council's consideration, in an attempt to resolve the above issues regarding loss of parking and conflict between pedestrians and delivery vehicles.

p.o.box 693  
coolangatta  
qld 4225  
p: 07 5599 1002  
f: 07 5599 1003  
apexadmin@apexconsultants.com.au  
BSA: A1029849  
ABN: 81 922 441 937

Council is respectfully requested to consider the provision of a loading bay adjacent to the rear boundary of the Pottsville IGA complex. The loading bay would be best positioned parallel to the rear boundary, at the western corner of the site. An indicative plan of the suggested loading bay's location is attached.

There are many benefits of providing a loading bay in this location, including:

- The loading area could be accessed by a fork lift, which would transport the goods to the rear of the IGA store, alongside the western boundary of the site.
- The travel path of the fork lift would be far safer than the initial proposal of delivery vehicles negotiating and maneuvering in the customer car park area.
- The loss of customer parking would be minimized – Perhaps only one space removed for a fork lift travel path, as opposed to the loss of 5 customer parking spaces for truck maneuvering on site (as originally proposed)

It is recognised that the proposed location of the loading bay will likely require the proposed vehicle traffic lanes on Berkley's Lane to be relocated northward by approximately 2.0m

It appears that an area of approximately 1.5m will exist between the rear boundary of the IGA site, and the proposed laneway alignment, and that Council has allowed a road pavement width of 7.5m. There would appear to be scope to move the road alignment northwards to make room for a loading bay.

There is a long history of negotiations and discussions between Council and the representatives of the Pottsville IGA regarding the construction of Berkelys Lane and the ability to access the lane to facilitate deliveries to the site. Meetings have been held with the General Manger and with Paul Morgan, Council's traffic engineer. Discussions have revolved around the issues relating to delivery of stock to the IGA and retail tenancies at the site.

It is imperative that the construction of Berkelys Lane be undertaken in a manner which optimizes the safety and ease of deliveries to the supermarket. Opportunity exists to provide a loading area adjacent to the site, and to thereby minimise conflict between customers and delivery vehicles. A loading area adjacent to the rear boundary, between the IGA carpark and the proposed alignment of Berkelys Lane would be a logical and practical move, to improve site safety and function of not only the IGA but all tenancies on the site.

We would be pleased to discuss the loading bay concept with Council further, and can be reached on 0418 989 445 (John Wightman).

Please do not hesitate to call if you have any queries regarding the above.

Yours faithfully,



Sharyn Borger  
Senior Town Planner  
**Apex Building & Development Consultants**

## Sandra Zietlow

---

**From:** Dave Norris [norrilyn@gmail.com]  
**Sent:** Thursday, 28 August 2014 3:42 PM  
**To:** Corporate Email  
**Subject:** Re: Correction\_Submission\_Pottsville service lane two-way option

Dear General Manager

There was an error in the submission I emailed to Council on 27 August 2014 regarding the Pottsville service lane two-way option, which I inadvertently signed as a spokesperson on behalf of Team Koala instead of on my own behalf.

Could you please replace it with the email below. Please accept my apologies for any inconvenience caused.

Yours faithfully  
David Norris

Dear General Manager

Could you please consider the following points when making your decision on the Pottsville CBD lane road construction:-

- Council should hold back on allowing vehicular traffic from the service lane-way through into Berkleys Lane at this stage in order to test if the service lane can operate successfully without through traffic. This may operate better if traffic (other than trucks) is allowed to enter the IGA car park from Coronation Avenue but not exit onto Coronation Avenue. However, this has the potential to choke up westbound traffic on Coronation Avenue east of the IGA entry point, and cause further safety issues as motorists dart across eastbound traffic in order to enter the car park. Perhaps allowing entry for eastbound traffic only may be safer.
- Council needs to consider safety issues, eg where children exiting the IGA could run out the door (which is very close to the existing car park entry) and be hit by a vehicle entering the car park. I believe the best option is to close the IGA driveway onto Coronation Avenue. Perhaps the shop doorway could be relocated to the west closer to the pedestrian crossing on Coronation Ave and away from the driveway.
- No through traffic onto Berkleys Lane would reduce the likelihood of hooning on the service road, which was identified as a major problem/safety issue at the drop-in information session. Also hooning has the potential to compromise the quality of the koala habitat adjacent to the lane-way. Tweed Coast Habitat Study 2011 (TCKHS) identifies that habitat stress resulting from disturbance generally is a contributor to koala immune system degradation, resulting in disease and death. The large tea tree (containing habitat hollows) at the western end of the lane-way, which is proposed to be removed, should be retained if the 'no through traffic option' is to be tested.
- There should be a footpath incorporated into the design on the northern side of the lane (safety for pedestrians and mothers with children and prams).
- If possible, there should be a cycle-way incorporated into the design for the lane-way and also on Coronation Avenue (safety for catholic primary school kids).

- Consideration should be given to the installation of koala-proof fencing along the western side of the lane-way. The opening of Berkleys Lane to through traffic will shift the koala mortality black spot along Coronation Avenue (refer TCKHS Figure 5.3a) to the footprint of the lane-way, which is closer to the Secondary A Koala Habitat, the recently planted koala food trees (refer Koala Connections Project) and the Koala Corridor identified in TCKHS Figure 5.1. TCKHS Figure 3.2 also shows significant koala activity adjacent to Berkleys Lane.
- Bollards should be installed on the western side of lane-way to stop vehicles nosing or backing into the environmental protection zone and to protect tree root systems.
- Traffic calming devices should be built into the lane-way; however, consideration should be given to the possibility that this may raise the trajectory of vehicle lighting into the house in Berkleys Lane opposite the western end of the lane-way.
- I believe the fig tree on Berkleys Lane should stay in place to act as a traffic calming measure. Also I believe it is listed as a threatened plant species and should not be damaged for this reason.
- No through traffic onto Berkleys Lane and retention of the fig tree would maintain the unique village atmosphere that is attracting tourists to Pottsville. The qualities that draw tourists to seaside villages are too often destroyed in the name of short-term traffic management when in the longer term traffic is diverted to commercial precincts outside the village. If you ask any tourist that visits Pottsville as to what attracts them here, they will say the village atmosphere. The area north of the shops on Coronation Avenue has a northerly aspect onto bushland which provides one of the few pleasant outlooks in Pottsville where tourist-orientated specialty shops and eateries could be focused.

Yours faithfully  
David Norris  
28 Toshack Place  
POTTSVILLE NSW 2489  
Phone: 02 6676 0615  
Mobile: 0423 267 555  
Email: [norrilyn@gmail.com](mailto:norrilyn@gmail.com)

## Sandra Zietlow

---

**From:** Paul Morgan  
**Sent:** Monday, 1 September 2014 9:19 AM  
**To:** Sandra Zietlow  
**Subject:** FW: Pottsville service lane two-way option  
**Attachments:** Feedback form Pottsville service lane FJB.docx

Dataworks please and include in the table you are doing  
thanks

---

**Paul Morgan** | Manager Design  
Engineering



p (02) 6670 2485 | f (02) 6670 2429 | e paulm@tweed.nsw.gov.au | w www.tweed.nsw.gov.au  
Civic and Cultural Centre Tumbulgum Road Murwillumbah NSW 2484 | PO Box 816 Murwillumbah NSW 2484

Customer Service: (02) 6670 2400 or 1300 292 872 ABN: 90 178 732 496

Our values: transparency | customer focus | fairness | reliability | progressiveness | value for money | collaboration  
Please consider the environment before printing this email. One tonne of paper is equivalent to 13 trees and 30 kL of water

---

---

**From:** Jeff & Penny Baldwin [<mailto:jeffpenn2@bigpond.com>]  
**Sent:** Sunday, 31 August 2014 11:40 PM  
**To:** Paul Morgan  
**Subject:** Pottsville service lane two-way option

G'day Paul

After speaking to you by 'phone on 27 August I had trouble downloading copies of the four pages you handed out to others at the community meeting of Wednesday 20 August. As I explained to you I didn't receive them as I had to leave early. It wasn't until after I got the "on exhibition" link from Terry O'Toole late on Thursday 28 August that I was able to obtain my copies; by then I had missed your Thursday 28 August deadline.

I nevertheless remained hopeful and phoned you unsuccessfully at 12.40 pm on Friday 29 August. I did speak to Nyree who told me you were absent from your desk.

As I understand that other community members and associations have made lengthy submissions to you and that I am "tail end Charlie" so to speak, you will see that I have kept my attached submission comparatively brief. Please don't hesitate to phone me at 6676 0439 or email me if you would like clarification on any point.

Cheers

F.J.(Jeff) Baldwin

**Feedback form Pottsville service lane two-way option Page 1 of 2**

*At its meeting on 17 July 2014, Council resolved to undertake additional community consultation about the construction of a rear lane off Coronation Avenue, Pottsville, this time with two-way traffic flow.*

*(In June 2014, Council exhibited and sought public comment on the formation of a rear lane and a proposal to change the traffic flow in Berkleys Lane, the unnamed lane and eastern sports field car park to one-way.)*

*The proposed works will include the construction of an additional three (3) parallel car parks to the western side of Berkleys Lane, while ensuring an appropriate green buffer to the adjoining residence and adequate vehicle turning paths. It includes the retention of the fig tree in Berkleys Lane.*

*Your feedback on this form would be appreciated and will be considered as a formal submission. The closing date for submissions has been extended to Thursday 28 August 2014.*

*Please send your submission by the closing date to: General Manager, Tweed Shire Council, PO Box 816, Murwillumbah NSW 2484 or email [tsc@tweed.nsw.gov.au](mailto:tsc@tweed.nsw.gov.au).*

**Your name:** Jeff Baldwin

**Address:** Post Office Box 75 Pottsville Beach  
Home: 1 Edinburgh Court Pottsville Beach NSW 2489

**Comments:**

**1. TREE & ITS SURROUNDING GARDEN IN BERKLEYS LANE**

In paragraph 4 of page 8 of the 9 pages representing your Design Section's Submission to Council you state "Advice is that the tree is of significance and should be preserved if possible" but you have given no indication of who gave you the advice. Until such time as Council, yourself and people like me learn who gave the advice and the basis for it we should all ignore it. If and when we get this information we can then decide if it "stacks up".

I believe that the tree and its garden should be removed as one of the first steps in the construction of the two way service lane as

- a) Its removal will make the situation safer for vehicles, people and nearby buildings.
- b) I have neither seen nor heard of anybody looking in admiration at the tree nor am I aware of anyone photographing it. I believe it is unloved.
- c) Once the tree is removed the three planned new parallel parking spaces will be able to be moved a little closer to Coronation Avenue and thus make it easier for large vehicles to move in or out of the east-west section of the road.

**2. IGA CAR PARK**

I understand that this car park and the present driveway to it from Coronation Avenue are the private property of the owner of the attached building occupied primarily by IGA, its associate Cellarbrations and Australia Post. This being so, I accept that the property owner has good reason to make access to the business occupants as easy and as safe as possible.

At your community meeting of 20 August you stated that you propose to block vehicles entry or exit between Coronation Avenue and the IGA carpark and to



erect bollards to enforce this blockage. The plan which you handed out at the meeting supports your statement.

Were these bollards placed close to Coronation Avenue I foresee accidents occurring. I believe it desirable that vehicles enter from Coronation Avenue and exit to the service road and that automatically raising arms be installed at both points to ensure traffic flows in only one direction.

**3. RAMPS**

Within the last 10 years TSC built dangerous footpath ramps in Phillip Street and to this day have made no effort to make them safe. As kerbing and guttering will be required when the service road is built it is essential that safe ramps for parents with prams and people with disabilities be included at appropriate points.

**4. MEETING ROOM**

I accept that the management of Pottsville Beach Neighbourhood Centre claims that its Sandbar Room is wheelchair accessible but I challenge any one of them to pass either way through its child proof gate and inward opening doors without significant help from an able bodied person; obviously no PBNC manager or TSC Councillor has faced the challenge so I suggest they soon do. Council should never again use this room for public meetings.

.....