

streetscape upgrades- coolum & caloundra

free flowing paving layout



side street cross over detail



themed landscape



paving finish to angled parking

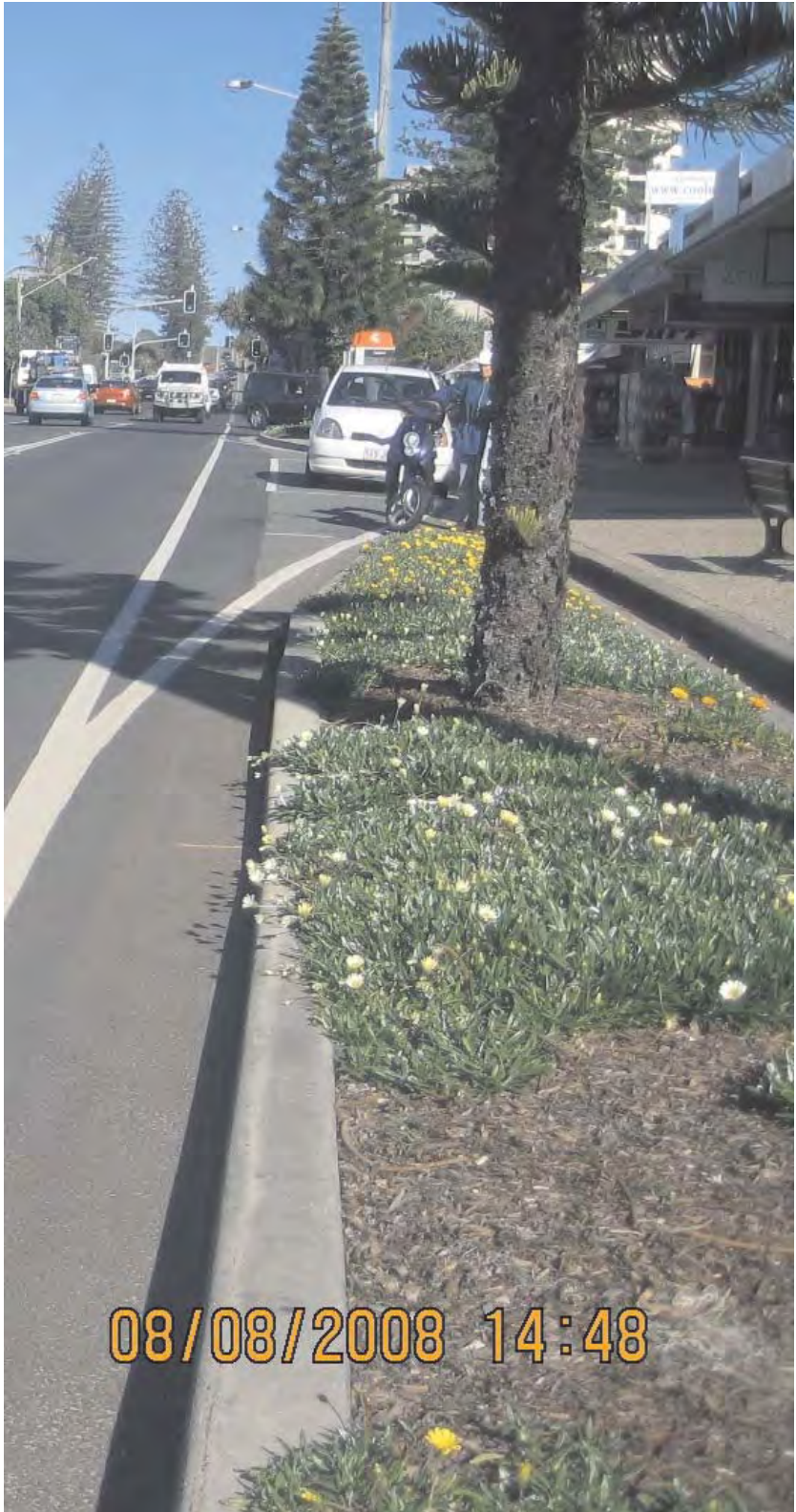

roadway built outs

streetscape upgrades- noosa

trees in pavement



built out/traffic calming detail



seating arrangements



paving details



trees in pavement and roadway



meeting points and seating layouts



streetscape upgrades

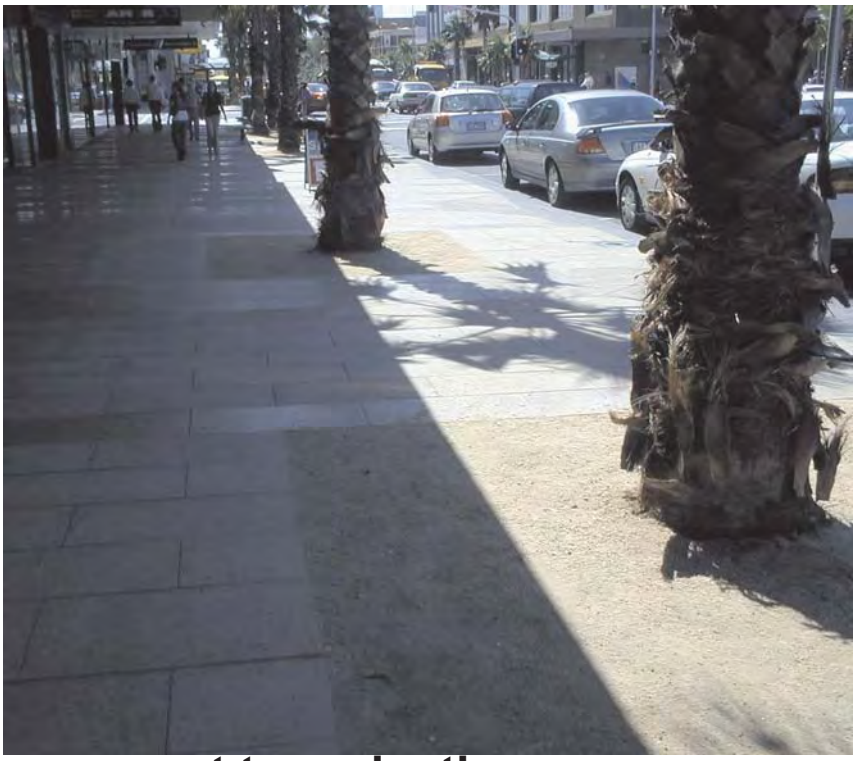

pavement tree planting

historical signage



alfresco dining and public

Streetscape Upgrade Brief

The brief for the upgrade was to once again make the main street of Cabarita a pedestrian friendly environment building on the existing coastal character whilst retaining the areas natural character and relaxed village lifestyle.

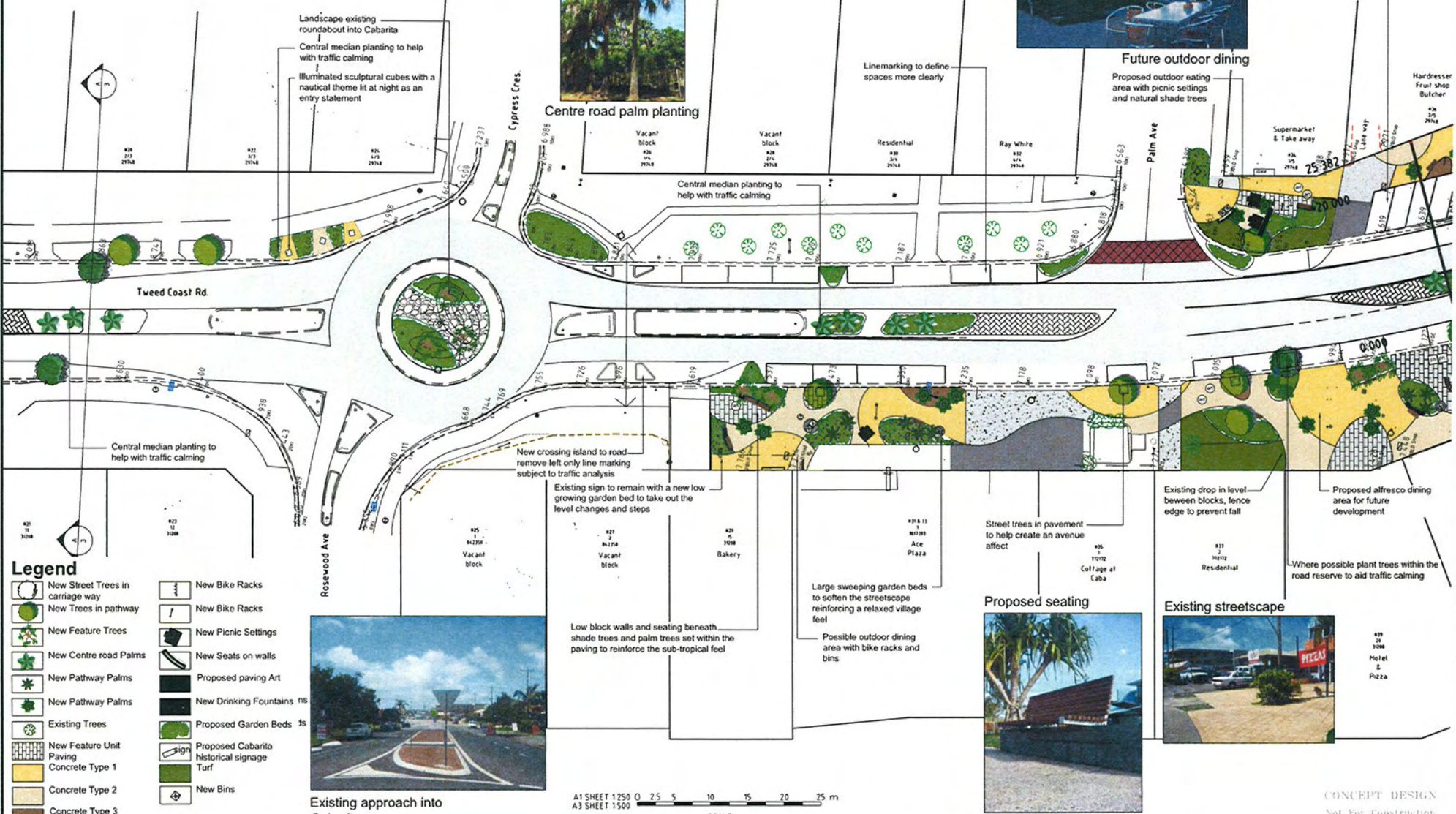

Legend

- New Street Trees in carriage way
- New Trees in pathway
- New Feature Trees
- New Centre road Palms
- New Pathway Palms
- Existing Trees
- New Feature Unit Paving Concrete Type 1
- Concrete Type 2
- Concrete Type 3
- New Bike Racks
- New Picnic Settings
- New Seats on walls
- Proposed paving Art
- New Drinking Fountains
- Proposed Garden Beds
- Proposed Cabarita historical signage
- New Bins



Existing approach into Cabarita

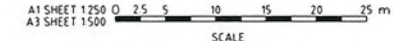

		TWEED SHIRE COUNCIL DESIGN UNIT		DESIGN ENGINEER: MURWILLUMBAH 02 66702400 CHECKING ENGINEER: MURWILLUMBAH 02 66727513 DRAWN: MURWILLUMBAH 02 66702400 DATE: 8.2009	PROJECT: TWEED COAST ROAD, BOGARANG TRAFFIC MANAGEMENT & STREETSCAPING	DRAWING NUMBER: PD08009/01
COUNCIL OFFICES: TUMBULOWM ROAD, MURWILLUMBAH, NEW SOUTH WALES, 2484		PHONE: MURWILLUMBAH 02 66702400 FAX: MURWILLUMBAH 02 66727513 WEBSITE: www.tweed.nsw.gov.au		DESIGNED: MURWILLUMBAH 02 66702400 CHECKED: MURWILLUMBAH 02 66702400 VERTICAL DATUM: MGA REDUCTION RATIO: 1:250(A1)	PLAN TITLE: CONCEPT PLAN SHEET 1	SHEET 1 OF 3 SHEETS ISSUE A

Existing streetscape



Proposed finishes to tie in with Pandanus Parade upgrade



Caba Village sign

Proposed entry statement to southern end of village within roadway to help traffic calming

Proposed pedestrian crossover point with central refuge to roadway

Streetscape Upgrade Intent of the Design

The intent of the design is to reinforce the coastal character whilst providing a safe and inviting environment in which to do business and engage with the local community. To achieve this a number of issues need to be dealt with. Tweed Coast Road is an important arterial road for local and surrounding business. With this in mind passive traffic calming initiatives are proposed to be implemented, these include central median planting to reduce the perceived width of the carriageway, whilst complimenting this with tree planting in the pedestrian walkways to create that arching affect over the road and the re-aligning of line markings to provide a constant carriageway width. A benefit of slowing passing traffic is the potential for them to stop and do business. A new entry statement is also proposed for the southern end of town, reducing the carriageway width and announcing arrivals into Cabarita. An upgrade to the landscaping at the northern roundabout is also proposed.

The planting of trees in the pathways also creates natural shade for pedestrians and a vibrant streetscape in which to engage with others. Endemic and native plant species are to be utilised to create a local sense of place. The design intends to promote 'mixed use', including alfresco dining, places to sit and watch with street furniture placed throughout including bins, drinking fountains, bike racks and seating. Works already completed in Pandanus Parade will help create a physical link to Tweed Coast Road and the Ocean itself with a strong visual link. Colours and themes are designed to reinforce the coastal character, using light, sandy colours and textures and natural timber finishes, reminiscent of timber wharfs and walkways.

The streetscape works on completion are designed to bring all the individual elements together through uniform design and be able to evolve with time and future developments.

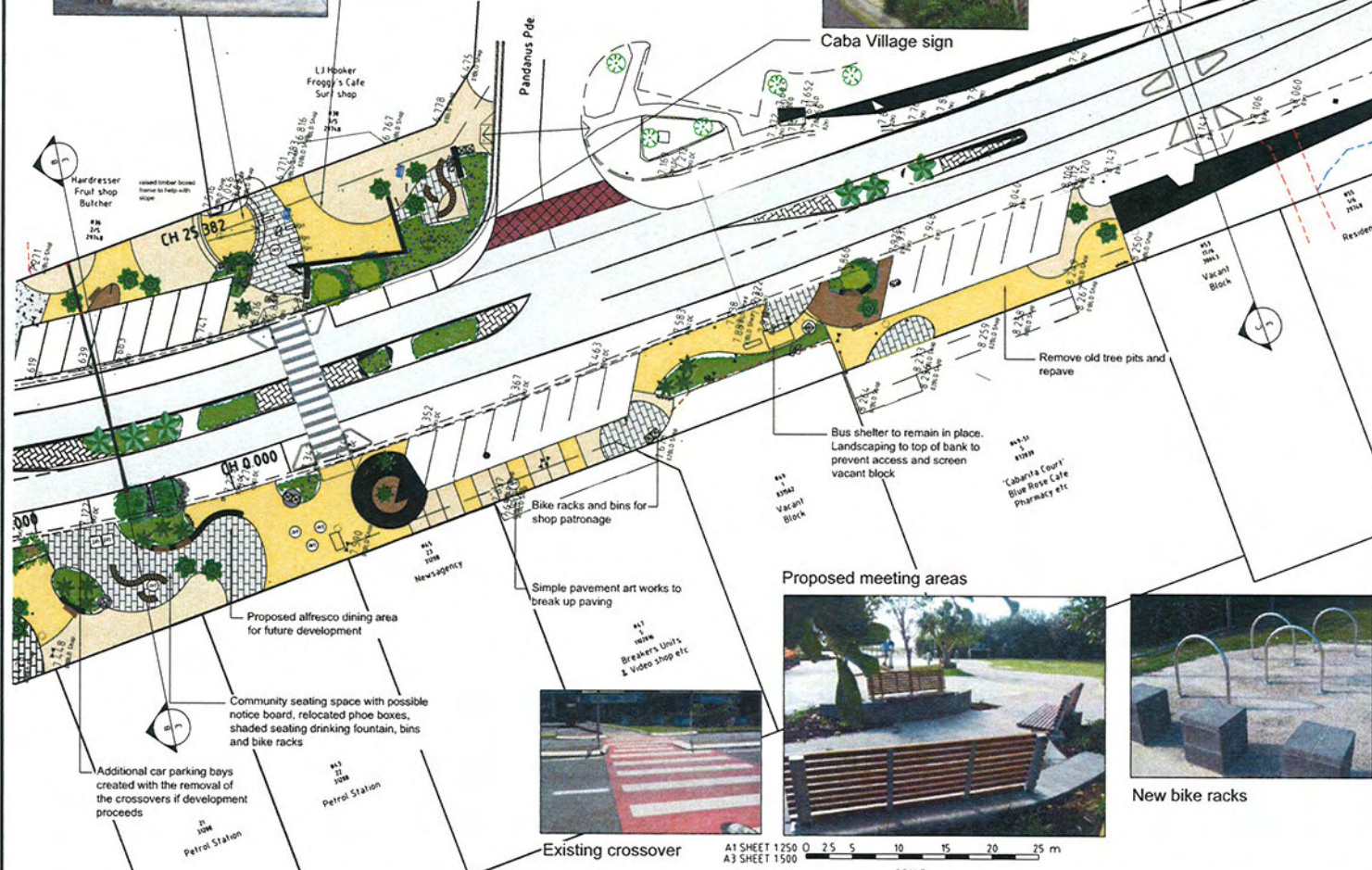

Proposed meeting areas



New bike racks



Existing crossover

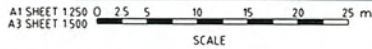

CONCEPT DESIGN
Not For Construction

A	ORIGINAL ISSUE	A.D.	8.2009		
ISSUE	AMENDMENT DETAILS	INITIALS	DATE		

TWEED SHIRE COUNCIL
DESIGN UNIT

COUNCIL OFFICES
TUMBLGUM ROAD,
MURWILLUMBAN,
NEW SOUTH WALES, 2484

PHONE MURWILLUMBAN 02 66702400
FAX MURWILLUMBAN 02 66727513
WEBSITE www.tweed.nsw.gov.au

CHECKING ENGINEER		DATE	
DESIGNED	I.B. 8.2009	DESIGN NO.	PD08009
DRAWN	A.D. 8.2009	SURVEY NO.	PD08009
CHECKED			
HORIZONTAL DATUM	MGA	REDUCTION RATIO	PH
VERTICAL DATUM	AHD	1:250(A1)	C

PROJECT:	TWEED COAST ROAD, BOGANGAR TRAFFIC MANAGEMENT & STREETSCAPING
PLAN TITLE:	CONCEPT PLAN SHEET 2
ACAD FILE No	G:\AUTOCAD DRAWINGS\Alex D\PD08009-Tweed Coast Rd\PD08009_Design.dwg

DRAWING NUMBER:	PD08009/02
SHEET 2 OF 3 SHEETS	
ISSUE	A

Any comments regarding this concept design can be forwarded by post to:

The General Manager
Tweed Shire Council
PO BOX 816
MURWILLUMBAH NSW 2484

or phoned through to council's
Traffic Engineer John Zawadski
on 02 6670 2691.

Electronic copies of these plans can be downloaded from councils website at www.tweed.nsw.gov.au

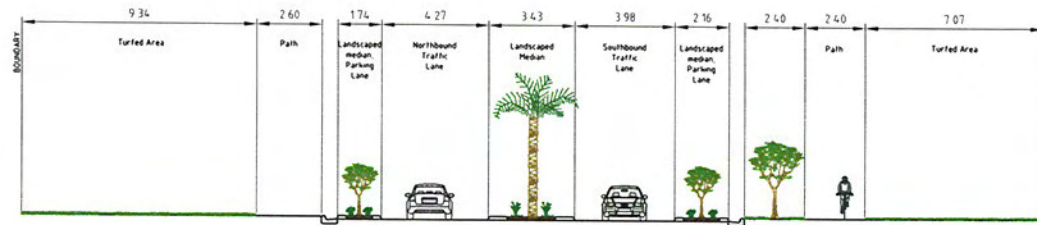

SECTION A-A

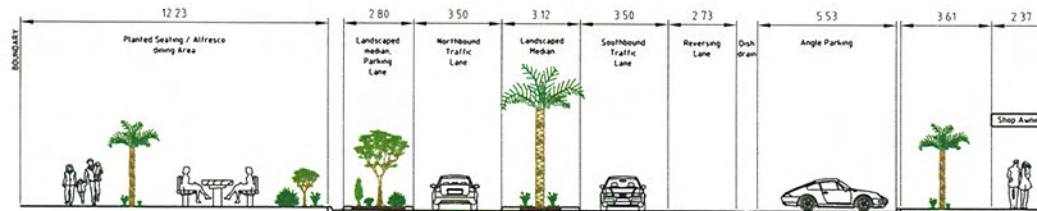

SECTION B-B

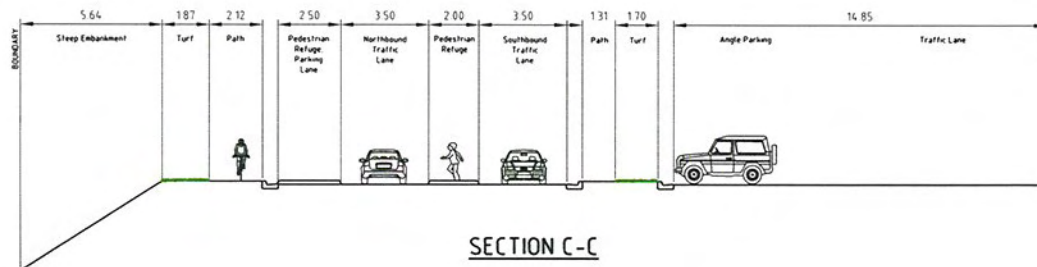

SECTION C-C

A1 SCALE 1:100
A3 SCALE 1:200

CONCEPT DESIGN
Not For Construction

<p>TWEED SHIRE COUNCIL DESIGN UNIT</p> <p>COUNCIL OFFICES TUMBULOW ROAD, MURWILLUMBAH, NEW SOUTH WALES, 2484</p> <p>PHONE MURWILLUMBAH 02 66702400 FAX MURWILLUMBAH 02 66727513 WEBSITE www.tweed.nsw.gov.au</p>		DESIGN ENGINEER	DATE	PROJECT: TWEED COAST ROAD, BOGANGAR TRAFFIC MANAGEMENT & STREETSCAPING	DRAWING NUMBER: PD08009/03
		DESIGNED I.B. 8.2009	DESIGN NO. PD08009	PLAN TITLE: TYPICAL SECTIONS	SHEET 3 OF 3 SHEETS ISSUE A
A ORIGINAL ISSUE	A.D. 8.2009	CHECKED	DATE	REDUCTION RATIO 1:100(A1)	
ISSUE AMENDMENT DETAILS	INITIALS DATE	HORIZONTAL DATUM	VERTICAL DATUM	ACAD FILE No G:_AUTOCAD DRAWINGS\Alex D\PD08009-Tweed Coast Rd\PD08009_Design.dwg	

0m 10m 20m 30m 40m 50m 100m 150m 200m 250m