

- NOTES:**
- JOINT TYPE ① FULL DEPTH EXPANSION JOINT WITH 10MM THICK APPROVED COMPRESSIBLE JOINT FILLER.
 - JOINT TYPE ② TOOL GROOVED JOINT 25MM DEEP.
 - 1. ALL EXPOSED EDGES TO BE ROUNDED TO 20MM RADIUS.
 - 2. MINIMUM CONCRETE GRADE TO BE N25 TO AS3600.
 - 3. SURFACE OF PATH IS TO BE WOODEN FLOAT & BROOM FINISHED.
 - 4. SURFACE OF PATH IS TO BE FINISHED FLUSH WITH TOP OF KERB.
 - 5. TOP OF TURF TO FINISH FLUSH WITH FOOTPATH
 - 6. FOOTPATH TO HAVE A CROSSFALL OF 2.00%
 - 7. REINFORCE WITH SL62 AT DRIVEWAYS

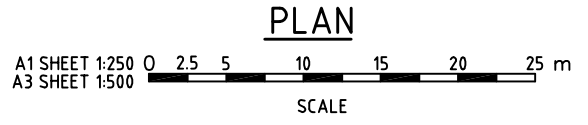
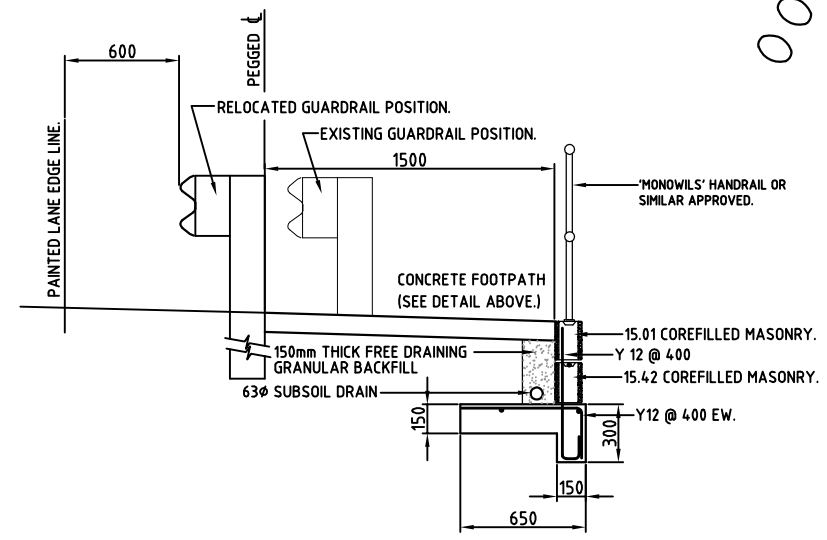

NOTE - UNDERGROUND SERVICES
 UNDERGROUND SERVICE LOCATIONS SHOWN ON THIS PLAN HAVE BEEN DETERMINED BY FIELD SURVEY AND/OR OFFICE RECORDS, AND MAY NOT REPRESENT ALL SERVICES OR EXACT LOCATIONS. THE CONTRACTOR SHALL ACCURATELY LOCATE AND DEPTH ALL SERVICES LIKELY TO BE ENCOUNTERED DURING CONSTRUCTION, PRIOR TO COMMENCING ANY EXCAVATION WORKS.

A	ORIGINAL ISSUE	R.C.	2.2002
ISSUE	AMENDMENT DETAILS	INITIALS	DATE

TWEED SHIRE COUNCIL DESIGN UNIT

COUNCIL OFFICES
 TUMBULGUM ROAD,
 MURWILLUMBAH,
 NEW SOUTH WALES, 2484

PHONE MURWILLUMBAH 02 66702400
 FAX MURWILLUMBAH 02 66727513
 WEBSITE www.tweed.nsw.gov.au

DESIGN ENGINEER	DATE	02/08
CHECKING ENGINEER	DATE	
DESIGNED GC	DESIGN NO.	
DRAWN GC	SURVEY NO.	
CHECKED WB		
HORIZONTAL DATUM MGA	REDUCTION RATIO	PM
VERTICAL DATUM AHD		EN

PROJECT: CONCRETE FOOTPATH ADJACENT TO SOUTH MURWILLUMBAH PRIMARY SCHOOL AT GREENHILLS

PLAN TITLE: GENERAL ARRANGEMENT. (SHEET 1.)

DRAWING NUMBER:	WK06021/01
SHEET 1 OF 4 SHEETS	
ISSUE A	

SETTING OUT SCHEDULE.

CHAINAGE	EASTING	NORTHING
0.00	539257.894	6865066.208
57.735	539287.137	6865115.990
61.151	539289.418	6865118.532
85.775	539301.890	6865139.764
98.547	539306.697	6865151.597
142.879	539308.702	6865195.883
155.940	539308.630	6865208.944
190.603	539311.355	6865243.500

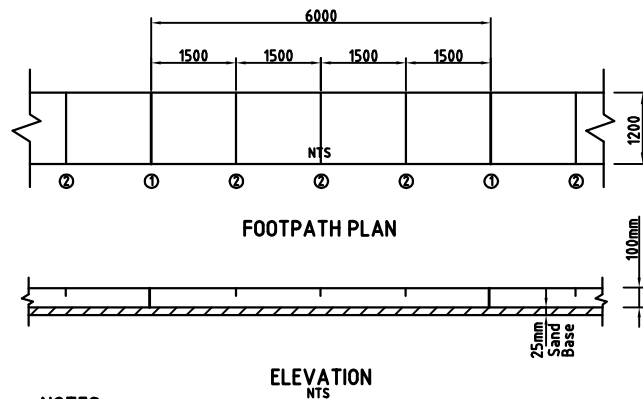
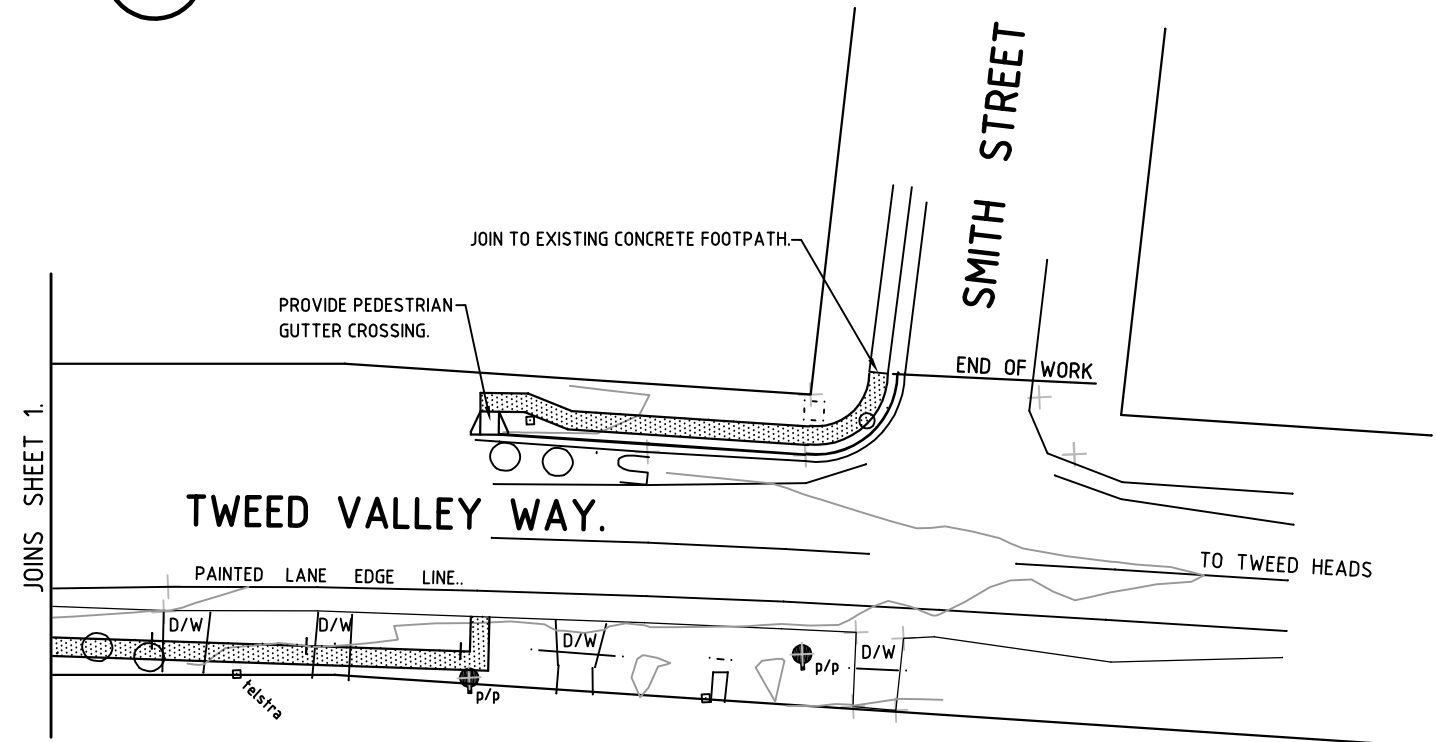

NOTES:

- JOINT TYPE ① FULL DEPTH EXPANSION JOINT WITH 10MM THICK APPROVED COMPRESSIBLE JOINT FILLER.
- JOINT TYPE ② TOOL GROOVED JOINT 25MM DEEP.
- 1. ALL EXPOSED EDGES TO BE ROUNDED TO 20MM RADIUS.
- 2. MINIMUM CONCRETE GRADE TO BE N25 TO AS3600.
- 3. SURFACE OF PATH IS TO BE WOODEN FLOAT & BROOM FINISHED.
- 4. SURFACE OF PATH IS TO BE FINISHED FLUSH WITH TOP OF KERB.
- 5. TOP OF TURF TO FINISH FLUSH WITH FOOTPATH
- 6. FOOTPATH TO HAVE A CROSSFALL OF 2.00%
- 7. REINFORCE WITH SL62 AT DRIVEWAYS

170.000
180.000
190.000

NOTE - UNDERGROUND SERVICES
UNDERGROUND SERVICE LOCATIONS SHOWN ON THIS PLAN HAVE BEEN DETERMINED BY FIELD SURVEY AND/OR OFFICE RECORDS, AND MAY NOT REPRESENT ALL SERVICES OR EXACT LOCATIONS THE CONTRACTOR SHALL ACCURATELY LOCATE AND DEPTH ALL SERVICES LIKELY TO BE ENCOUNTERED DURING CONSTRUCTION, PRIOR TO COMMENCING ANY EXCAVATION WORKS.

PLAN

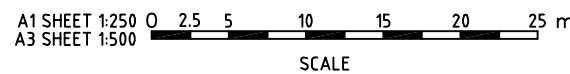

TWEED SHIRE COUNCIL DESIGN UNIT		DESIGN ENGINEER <i>[Signature]</i> DATE 02/08...		PROJECT: CONCRETE FOOTPATH ADJACENT TO SOUTH MURWILLUMBAH PRIMARY SCHOOL AT GREENHILLS.		DRAWING NUMBER: WK06021/02	
		CHECKING ENGINEER DATE		PLAN TITLE: GENERAL ARRANGEMENT. (SHEET 2.)		SHEET 2 OF 4 SHEETS ISSUE A	
COUNCIL OFFICES TUMBULGUM ROAD, MURWILLUMBAH, NEW SOUTH WALES, 2484		PHONE MURWILLUMBAH 02 66702400 FAX MURWILLUMBAH 02 66727513 WEBSITE www.tweed.nsw.gov.au		ACAD FILE No		G:_AUTOCAD DRAWINGS\Greg\WK06021.	

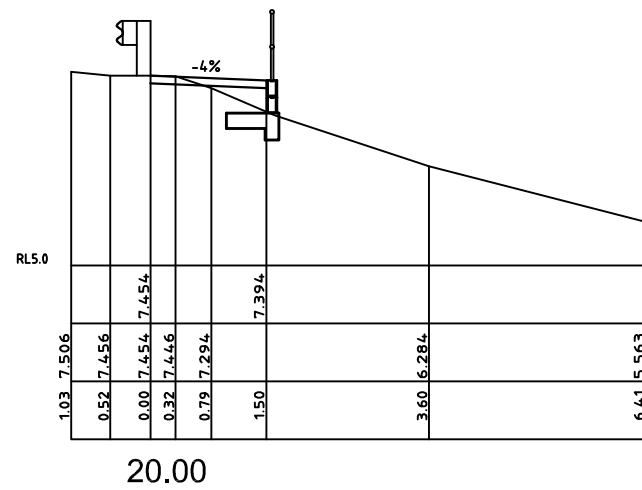

20.00

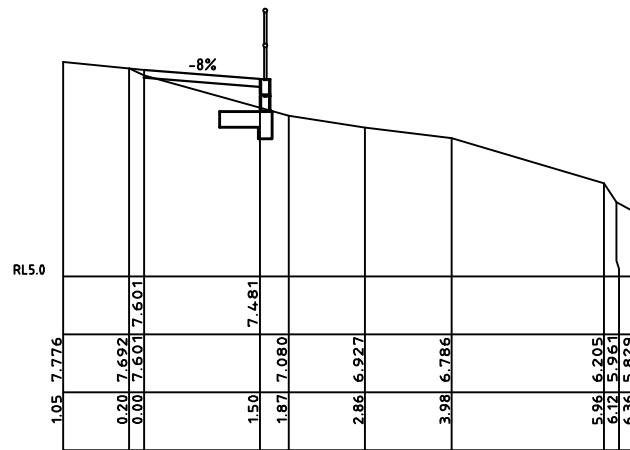

31.741

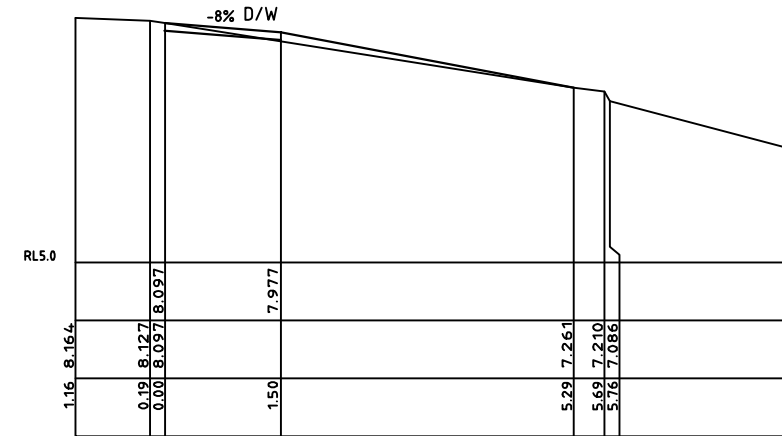

53.722

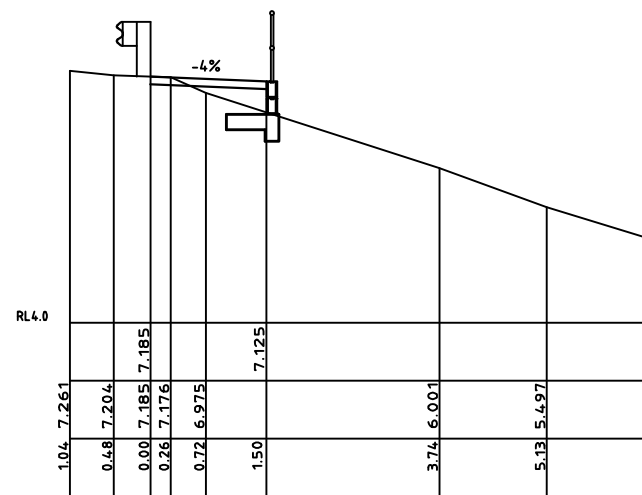

10.00

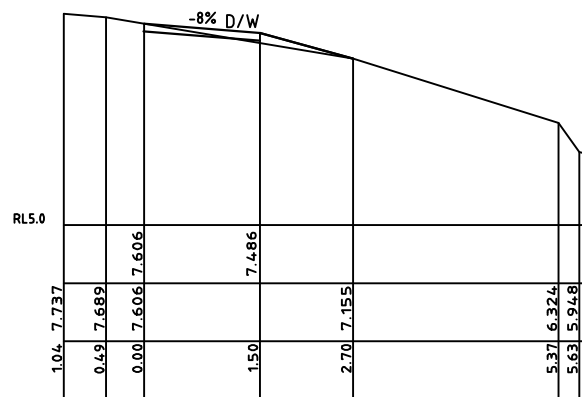

30.00

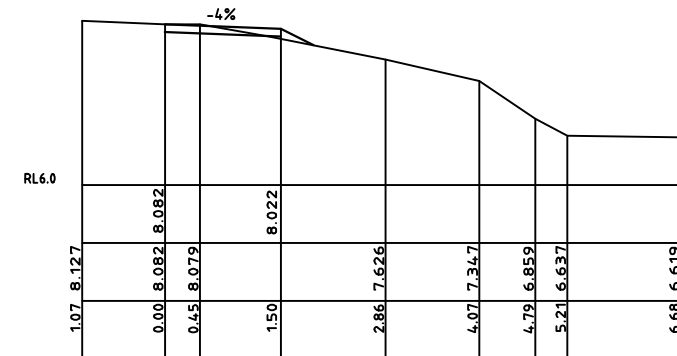

50.00

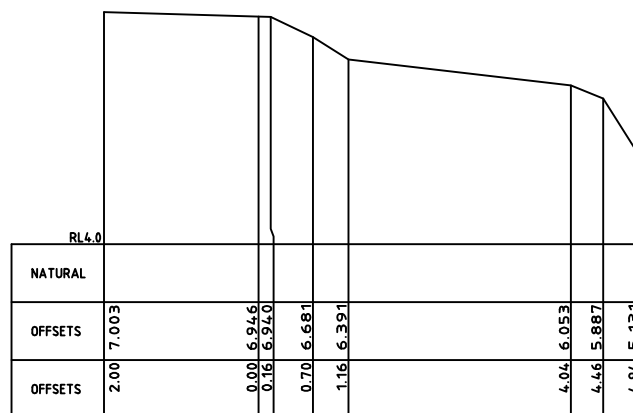

0.00

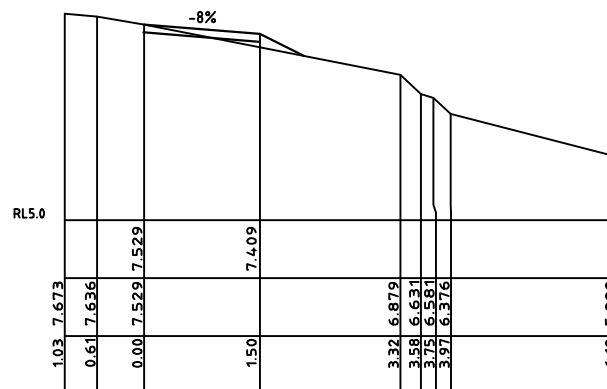

27.175

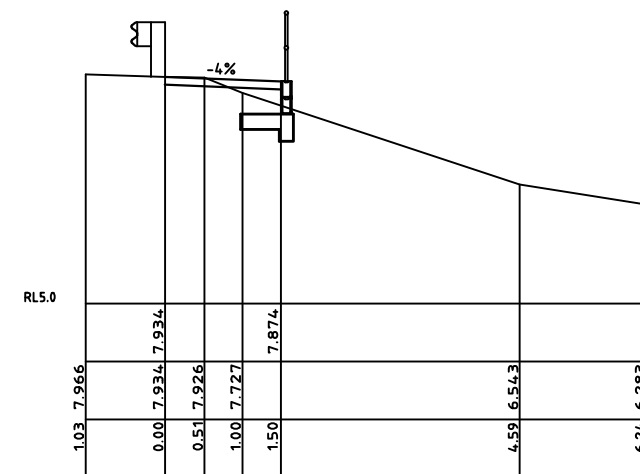

40.00

A	ORIGINAL ISSUE	R.C.	2.2002
ISSUE	AMENDMENT DETAILS	INITIALS	DATE

TWEED SHIRE COUNCIL
DESIGN UNIT

COUNCIL OFFICES
TUMBULGUM ROAD,
MURWILLUMBAH,
NEW SOUTH WALES, 2484

PHONE MURWILLUMBAH 02 66702400
FAX MURWILLUMBAH 02 66727513
WEBSITE www.tweed.nsw.gov.au

DESIGN ENGINEER	DATE	02/08
CHECKING ENGINEER	DATE	
DESIGNED GC	DESIGN NO.	DESIGNNO.
DRAWN GC	SURVEY NO.	SURVEYNO.
CHECKED WB		PROGRAMNO.
HORIZONTAL DATUM	MGA	REDUCTION RATIO
VERTICAL DATUM	AED	PM E N

PROJECT: CONCRETE FOOTPATH ADJACENT TO SOUTH
MURWILLUMBAH PRIMARY SCHOOL AT GREENHILLS.

PLAN TITLE: CROSS SECTIONS (SHEET 1.)

DRAWING NUMBER:	WK06021/03
SHEET 3 OF 4 SHEETS	
ISSUE A	

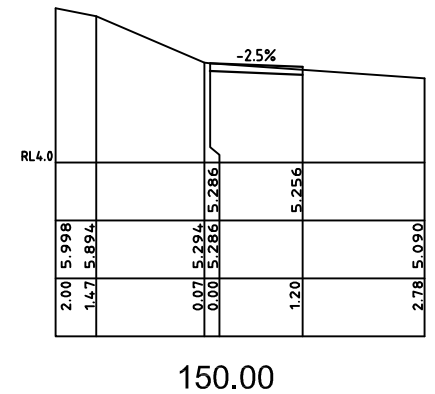
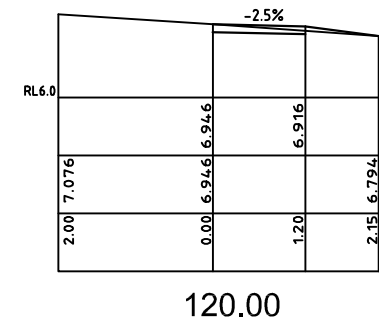
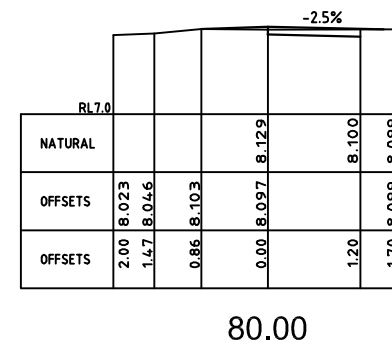
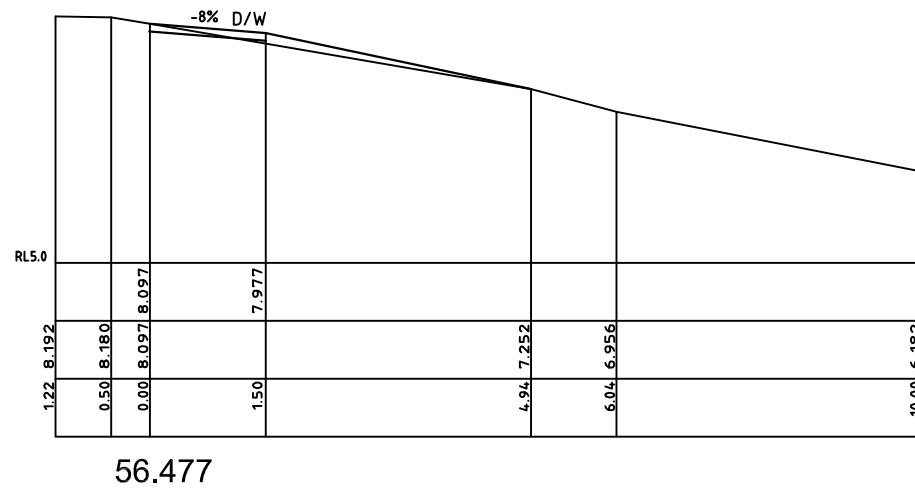
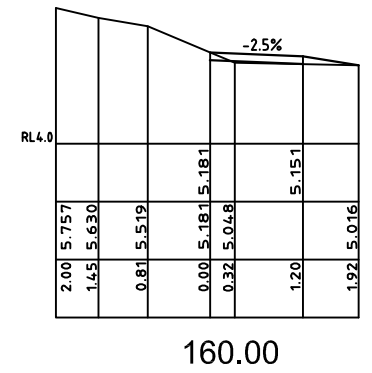
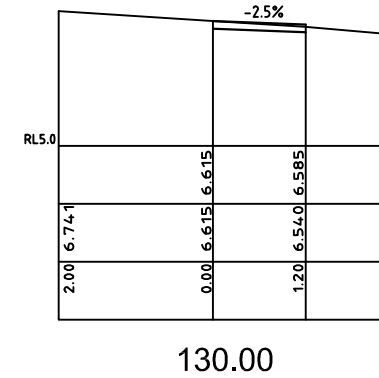
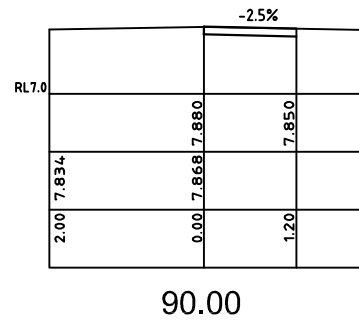
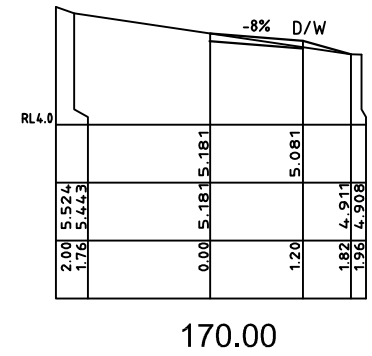
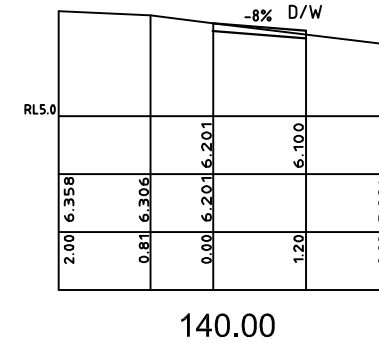
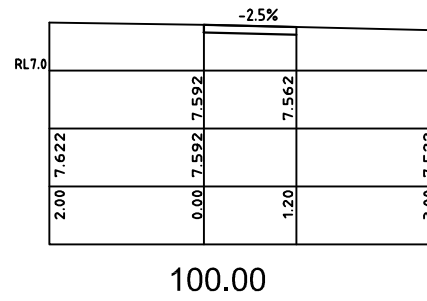
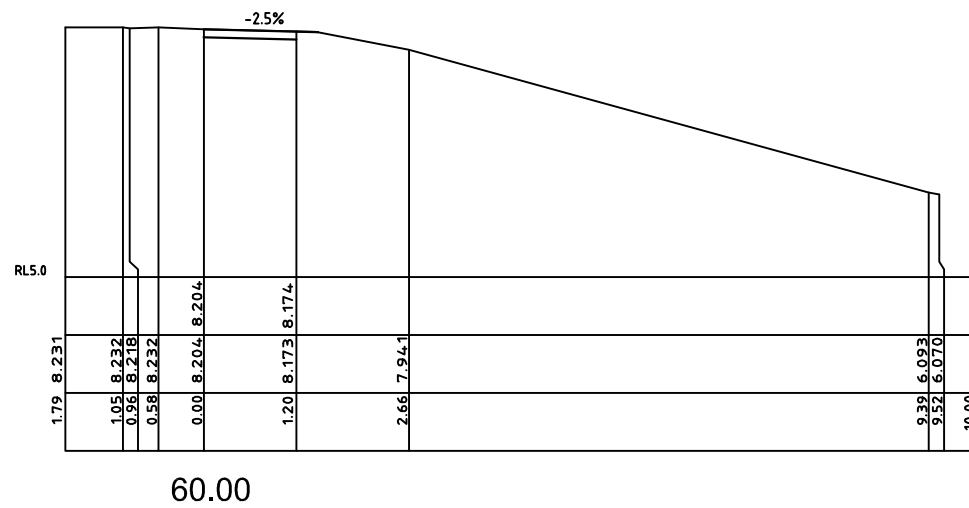
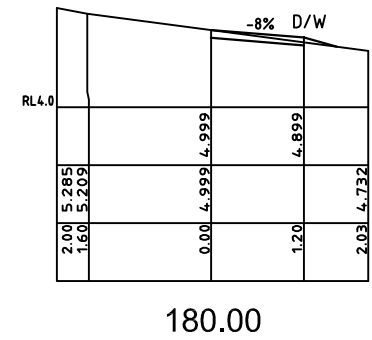
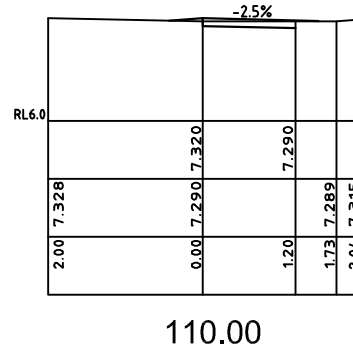
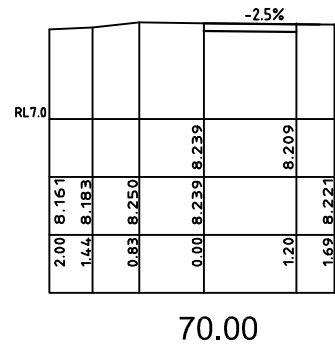

A	ORIGINAL ISSUE	R.C.	2.2002
ISSUE	AMENDMENT DETAILS	INITIALS	DATE



TWEED SHIRE COUNCIL
DESIGN UNIT
 COUNCIL OFFICES
 TUMBULGUM ROAD,
 MURWILLUMBAH,
 NEW SOUTH WALES, 2484
 PHONE MURWILLUMBAH 02 66702400
 FAX MURWILLUMBAH 02 66727513
 WEBSITE www.tweed.nsw.gov.au

DESIGN ENGINEER	DATE	02/08...
CHECKING ENGINEER	DATE	
DESIGNED	GC	DESIGN NO.
DRAWN	GC	SURVEY NO.
CHECKED	WB	SURVEYNO.
HORIZONTAL DATUM	MGA	PROGRAMNO.
VERTICAL DATUM	AED	REDUCTION RATIO
		PM
		E
		N

PROJECT: CONCRETE FOOTPATH ADJACENT TO SOUTH
 MURWILLUMBAH PRIMARY SCHOOL AT GREENHILLS.
 PLAN TITLE: CROSS SECTIONS (SHEET 2.)

DRAWING NUMBER:	WK06021/04
SHEET 4 OF 4 SHEETS	
ISSUE	A