







- LEGEND

- | | |
|--|--|
| 1. Existing carpark (33 spaces including 2 accessible) | 8. New seating with back and arm rests |
| 2. Existing toilet and pathways to remain | 9. Informative flood markers |
| 3. New flood resilient shelters, accessible barbecue and picnic settings | 10. Sandstone block retaining wall |
| 4. Feature palm tree planting | 11. Accessible drinking fountain |
| 5. New carpark allows for entering and exiting from Tweed Valley Way (19 spaces) | 12. Bike racks |
| 6. New park entry signage and feature red brick wall | 13. Rubbish bins |
| 7. Raised garden beds with corten steel edging | 14. Feature linear red brick walls |
| | 15. Circular insitu concrete seats for viewing |
| | 16. Riverview Hotel with private carpark on western side |

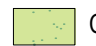
- | |
|--|
| 17. Pedestrian access to Riverview Hotel maintained |
| 18. Existing historic pole to remain with improvements |
| 19. Bollards |
| 20. Existing public bus stop |

-  Existing trees to remain
-  Existing concrete paths to remain
-  Creation of grassed parkland
-  New connecting pathways. Minimum 1.5m wide, to AS1428.1

- MAP

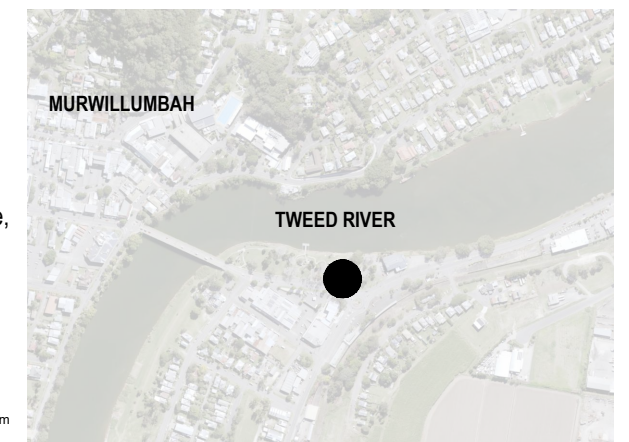

BUDD PARK UPGRADE, MURWILLUMBAH

DRAFT CONCEPT

- EXISTING IMAGES

SHEET 2 OF 3



Demolish existing Visitor Information Centre (World Rainforest Centre)

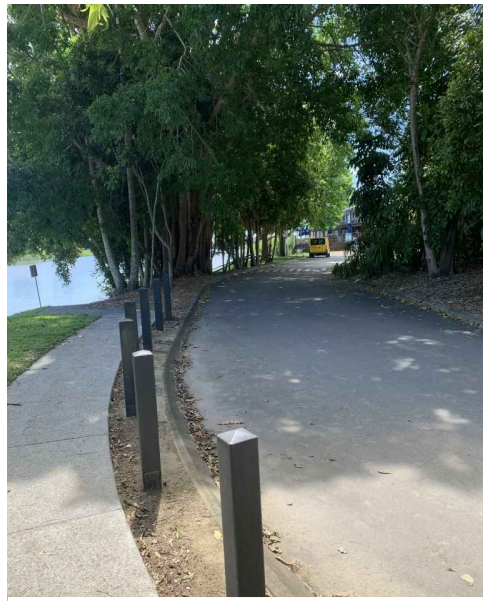

Existing internal connection road to be converted to parkland, with improved pedestrian access and viewing opportunities



Existing toilet, accessible ramp and pathways to remain



Existing carpark to be upgraded and formalised with access from Tweed Valley Way



Existing access points to Riverview Hotel to be maintained

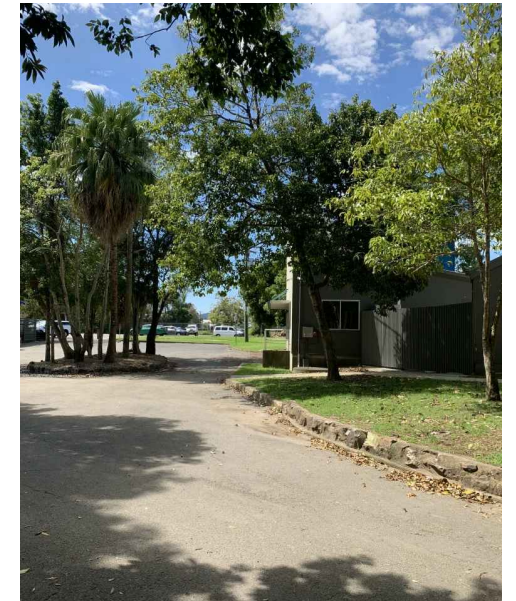

Existing established trees for natural shade to remain

- NEW IMAGES (INDICATIVE ONLY)

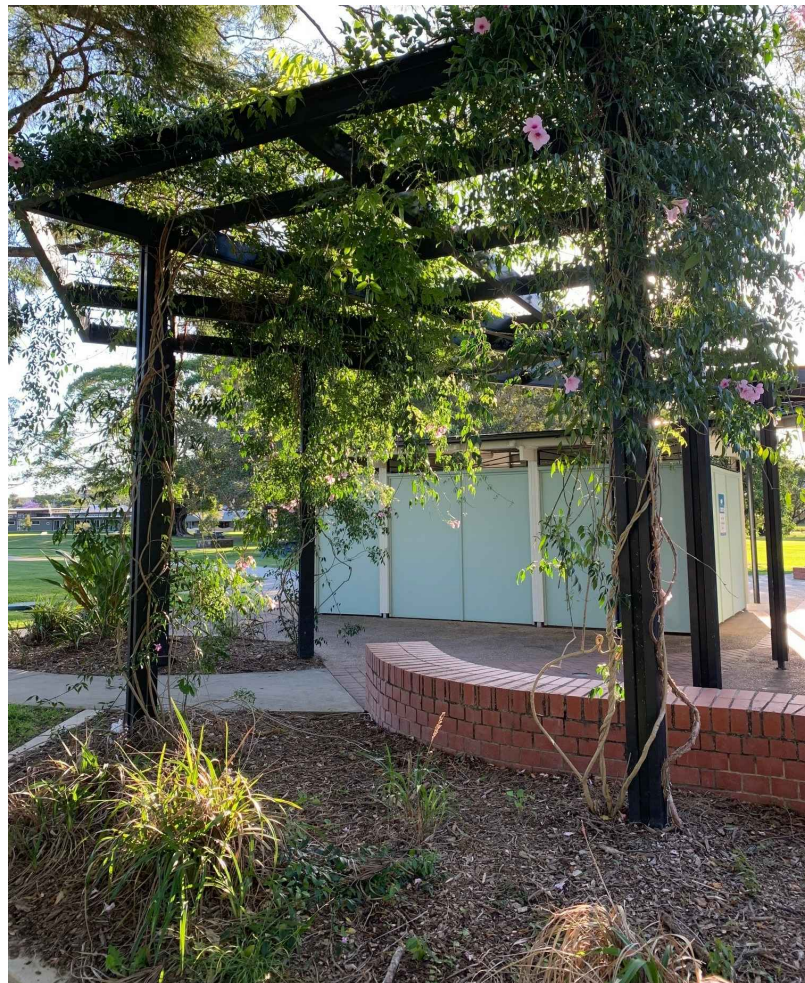

Pergola with climbing plants and red brick feature walls



Circular insitu concrete seats

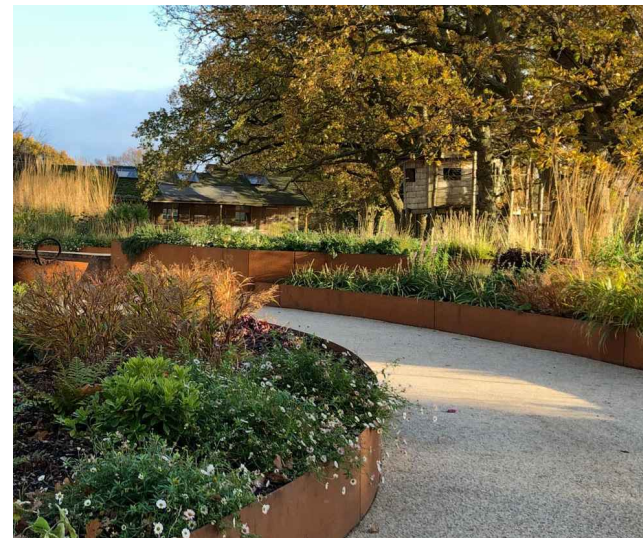

Raised garden beds with corten steel edging



New flood resilient design to include new shelters, accessible barbecue and picnic settings

- PERSPECTIVE VIEW - IMAGE INDICATIVE ONLY

SHEET 3 OF 3



View A